

FINAL

Contact: Mo Taggart  
703/684-7848  
Jo-Anne Coe  
703/845-1714

SENATOR DOLE SCHEDULE -- JULY 19, 1994 -- BOSTON

MONDAY, JULY 18, 1994

4:25 pm DEPART Capitol for National Airport  
Driver: Wilbert

4:45 pm ARRIVE National Airport and proceed to departing aircraft

5:00 pm DEPART Washington for Boston, MA  
Flight: US AIR Shuttle #2380  
Flight time: 1 hour 30 minutes

Manifest: Senator Dole  
Sheila Burke  
Clarkson Hine  
Nelson Rockefeller  
Vicki Hart  
Dennis Shea

6:30 pm ARRIVE Boston, MA/Logan International Airport  
Met by: Trish Burger, CA Advance  
508/650-9212 (h)  
617/763-8500

6:45 pm DEPART airport for Sheraton Hotel  
Drivers: Trish Burger &  
Boston Coach  
Drive time: 25 minutes  
Location: 39 Dalton Street

7:10 pm ARRIVE Sheraton Hotel for PRIVATE  
617/236-2000  
617/236-1702 fax

Met by: Jim Murphy  
Dan Burger, CA advance

NOTE: Lynn Drake will meet with the Senator at  
approximately 7:30. Dan Burger is arranging a  
room for the meeting.

RON----Boston

TUESDAY, JULY 19, 1994

PAGE TWO

8:10 am

STAFF SHOULD BRING LUGGAGE DOWN TO LOBBY

8:25 am DEPART hotel for John B. Hynes Veterans' Memorial Convention Center

Walk time: 5 minutes

Location: 900 Boylston Street

NOTE: The Sheraton Hotel and the Convention Center are connected by a walk way.

8:30 am ARRIVE John B. Hynes Veterans' Memorial Convention Center

617/954-2500 message center

8:30 am- MEET with Governors

9:00 am Location: Room 307 - 3rd Floor

9:15 am ATTEND/SPEAK National Governors Association Annual Meeting

Location: Ballroom B & C - 3rd Floor

Attendance: 400

Event runs: 9:15 - 9:45 am

Press: Open

Facility: Hollow square seating arrangement for Governors, podium, audience seated in theater style

Senator Dole will be seated next to Governor Campbell in hollow square

Format: 9:15 am Gov. Campbell introduces Senator Dole

9:18 am Senator gives remarks (20 minutes)

9:38 am Q & A

9:45 am Meeting concludes

Contact: Susan Ade  
202/624-5317  
617/954-2528  
617/954-2500

9:45 am DEPART Meeting for Logan International Airport

Drivers: Trish Burger, CA advance & Boston Coach

Drive time: 25 minutes

10:10 am ARRIVE Logan International Airport and proceed to departing aircraft

FBO: Signature Flight  
617/569-5260

TUESDAY, JULY 19, 1994

PAGE THREE

10:15 am      DEPART Boston for Washington/National  
FBO:              Signature  
Aircraft:        Falcon 50    (Zeneca)  
Tail number:    N300A  
Flight time:     1 hour 15 minutes  
  
Pilots:           George Adams, Jr.  
                  Bob Schippacase  
                  Rich Riblett  
  
Seats:            9  
Meal:             Snack  
Manifest:        Senator Dole  
                  Sheila Burke  
                  Clarkson Hine  
                  Nelson Rockefeller  
                  Vicki Hart  
                  Dennis Shea  
                  Ann Scully, Govt. Relations, Zeneca  
                  Alan Milbauer, Zeneca  
  
Contact:          Delores May  
                  302/328-1334  
  
11:30 am    ARRIVE Washington, DC  
FBO:              Signature Aviation  
                  703/419-8440  
  
11:35 am    DEPART airport for Capitol  
Driver:           Wilbert  
  
11:50 am    ARRIVE Capitol





## REPUBLICAN GOVERNORS ASSOCIATION

# 1994 Gubernatorial Campaign Overview

**Confidential**

Prepared  
by the  
Republican Governors Association  
July 1994

310 First Street, Southeast, Washington, D.C. 20003 • (202) 863-8587

Paid for by the Republican Governors Association

## MEMORANDUM

June 9, 1994

TO: Senator Dole  
FR: Bill Thorne, NRSC  
RE: Trip to Massachusetts

The following is background for your trip to Massachusetts:

| File Date | Convention | Primary Date | Coord. Limit |
|-----------|------------|--------------|--------------|
| June 7    | May 13-14  | Sept 20      | \$561,192    |

### **Announced**

**John Lakian**, businessman      **Mitt Romney**, businessman

### **REPUBLICAN RACE UPDATE:**

1. The Massachusetts Republican Party held its convention on May 13 and 14 in Springfield. As expected, businessman Mitt Romney won an overwhelming endorsement by carrying 68% of the 3,100 delegates. Businessman and 1982 GOP gubernatorial primary candidate John Lakian picked-up 16.3% of the delegate votes; a candidate needs a minimum of 15% to appear on the September 20 primary ballot. None of the other four announced candidates -- including former talk show host Janet Jephelian -- achieved over 10% of the vote.

2. With the party's endorsement and because of his fundraising potential, Romney has clearly taken the front-runner status, reporting \$329,920 in cash-on-hand from the \$458,916 he raised through the first quarter of the year. Lakian raised \$88,592, has loaned his campaign \$544,256, spent \$524,853 and reports \$21,153 on-hand.

3. Following the convention, Lakian was encouraged by Governor Weld to remain in the race, citing that a primary helped him to organize his successful 1990 gubernatorial campaign. Others, however, have not been as supportive of Lakian's bid and during the convention, State Treasurer and 1988 GOP Senate candidate Joe Malone publicly endorsed Romney.

4. Recent developments include:

- Democrats have raised questions about a Romney ad that featured police officers and a police cruiser from the City of Belmont. A complaint has been filed with the state ethics commission citing a rule that says "a public employee's use of his official position to promote political or campaign related matters is unwarranted where such political activity falls outside the scope of his official duties." However, the police officers were not on duty at the time that the commercial was filmed, and the police cruiser was not moved specifically for this purpose.



- Lakian recently had to pay a sizable cash settlement to avoid legal action by federal bank regulators over his role in the 1990 failure of a Boston bank. The liability settlement forestalls a threatened federal lawsuit against 13 ex-bank officials who were being investigated for making millions of dollars in improper loans during the late 1980s.

Further, another controversy erupted when it was reported that Lakian used a home in New York as his address when contributing to the campaign of Mayor Rudolph Giuliani, thereby qualifying his contribution for matching funds. He now says that a vacation home in Woods Hole, Mass. is his permanent address, and his family recently moved there full time.

- Romney has come under fire by Lakian for his Mormon church ties and contradictions between church teachings and some of Romney's political views, including his pro-choice position (the Mormon church is staunchly pro-life). Romney has not helped himself by appearing uninformed on certain issues, and Kennedy has already begun attacking Romney as a right-wing extremist.

- The *Boston Herald* reported an April 22 poll that showed Kennedy's favorable/unfavorable dropping to 38% / 36%, as compared to his 67% / 26% in a poll taken February 3. The poll also showed that the Republican candidates still have a very low name I.D. (PLEASE SEE THE RESULTS IN LATEST POLLING INFORMATION AT THE END OF THIS BRIEF)

#### **KENNEDY:**

Kennedy won the '88 election with 65% of the vote Joe Malone. Malone was greatly outspent by Kennedy (\$587,323 against Kennedy's \$2,702,865), but his '88 Senate race set the stage for his '90 victory in the Treasurer's race.

Kennedy accepted his party's endorsement at the Massachusetts Democratic State Convention on June 3 and 4. Tying himself very closely with Clinton, Kennedy touted himself as a "formidable champion of the state's interests in Washington," casting himself as the top target of the GOP far right, saying that "those who most fiercely oppose President Clinton have made me their number one target in 1994."

Ultimately, voters seem to have grown weary of Kennedy, with concerns over his personal life as well as his extended stay in the Senate. In the *Globe* poll, 31% of those polled said that they would be less likely to vote for Kennedy because of his past personal behavior; 42% who identified themselves as independents shared that view.

## **POLITICAL ENVIRONMENT:**

It would be simplistic, at best, to narrowly define the political environment in Massachusetts as unpredictable, but it would be a fair assessment. Politics in Massachusetts for years has been a kind of cultural war, between Yankee Republicans and Irish Democrats, an argument not over the distribution of income or the provision of services, as over whose vision of Massachusetts should be honored and whose mores regarded as the norm.

Over the years, the percentage of Irish and Catholics has risen. While many old line Massachusetts families have left the state or intermarried, the Irish mostly stayed put, raised large families, and slowly moved Massachusetts from being one of the most Republican states to one of the most Democratic. Historically, local Irish Democrats were conservative on cultural issues, hostile to liberal internationalism, and receptive to anti-communism. However, the expanding high-skill population, attracted initially by Massachusetts's many universities and colleges, was very liberal and combined their Democratic vote to ensure large majorities for candidates like the Kennedys, George McGovern, and Michael Dukakis.

1989 and 1990 marked the rapid decline in support for Massachusetts liberalism when Governor William Weld, a tax cutting, moderate Republican was elected along with State Treasurer Joe Malone, the first Republican wins for state office since 1970. Republicans won a majority of votes in contested races for the Governor's Council, and gained eight seats in the state Senate and eight in the House, even though many seats were left uncontested. Furthermore, Republicans picked up two congressional seats and seriously contested three others in 1992.

## **LATEST POLLING INFORMATION:**

### **Opinion Dynamics (May/1994)**

#### **BALLOT**

|         |     |
|---------|-----|
| Romney  | 33% |
| Kennedy | 50  |

#### **KENNEDY JOB**

|                |     |
|----------------|-----|
| Excellent/Good | 41% |
| Fair/Poor      | 54  |

### **KRC/Boston Globe (5/11-12/94)**

#### **BALLOTS**

|         |     |         |     |
|---------|-----|---------|-----|
| Romney  | 32% | Lakian  | 29% |
| Kennedy | 50  | Kennedy | 51% |

#### **KENNEDY REELECT**

|                            |     |
|----------------------------|-----|
| Deserves to be Reelected   | 38% |
| Give Someone Else a Chance | 52  |

#### **KENNEDY JOB**

|                |     |
|----------------|-----|
| Excellent/Good | 47% |
| Fair/Poor      | N/A |



| NAME I.D.   | Romney | Lakian | Kennedy |
|-------------|--------|--------|---------|
| Favorable   | 15%    | 8%     | 55%     |
| Unfavorable | 11     | 11     | 35      |

**Clark Unlversity/University of Massachusetts (April/94)**

**KENNEDY REELECT**

Deserves Reelection 34%

Time for Change 61

**ELECTION INFORMATION:**

| Candidate | Raised 3/94 | Spent 3/94 | COH 3/94    | Debt      |
|-----------|-------------|------------|-------------|-----------|
| Kennedy   | \$939,071   | \$686,990  | \$2,793,837 |           |
| Romney    | \$458,916   | \$376,208  | \$329,920   | \$14,956  |
| Lakian    | \$88,592    | \$564,853  | \$21,153    | \$544,256 |



## MITT ROMNEY

### A BIOGRAPHICAL SKETCH

Mitt Romney was born in Michigan in 1947. He is the son of George Romney, a three term Governor of Michigan. A candidate for the Republican nomination for President of the United States in 1968, George Romney was appointed and served as Secretary of Housing and Urban Development from 1969 to 1975. Mitt's mother, Lenore Romney, won the Republican nomination for the United States Senate in Michigan in 1970 but lost in the final to a longtime incumbent.

Mitt Romney married his high school sweetheart, Ann Davies in 1969 and graduated from Brigham Young University with the highest honors.

Mitt and Ann then came to Massachusetts where they have lived ever since. In 1975, Mitt received his Juris Doctorate from Harvard Law School and an MBA from Harvard Business School where he was a Baker Scholar. He has served as a Vice President, CEO and Chairman of Bain & Company, Inc., an international management consulting firm, and as a Founder and CEO of Bain Capital, Inc., a leading venture capital and private equity investment company. Mitt and Ann live in Belmont and have five sons.

## MITT ROMNEY

### A BIOGRAPHICAL SUMMARY

#### Professional

Chief Executive Officer, Managing Partner Bain Capital, Inc.  
1984-Present

Mitt Romney manages this leading venture capital and private equity investment company. With approximately \$500 million in equity capital, the firm has acquired, started, or invested in over 60 companies with combined revenues exceeding \$5 billion.

Chief Executive Officer, Chairman Bain & Company, Inc.  
1991-1993

Bain and Company is a prominent management consulting firm to major companies around the world. Headquartered in Massachusetts, its fifteen offices, including London, Paris, Tokyo, Hong Kong, Munich, and Moscow, employ over 1,000 people. As the firm's CEO, Mitt Romney turned around the company and successfully set a course of growth and profitability.

#### Corporate

Board of Directors: Marriott; Staples; Babbages; and Duane Reade, among others.

#### Civic

Current positions include:  
Governor's Commission on Growth and Technology;  
National Executive Board of the Boy Scouts of America;  
Visiting Committee of the Harvard Business School;  
National Advisory Council of the Brigham Young University Business School.

#### Education

Bachelor of Arts

Juris Doctorate

Master of Business Administration

Brigham Young University, Highest Honors

Harvard Law School, Cum Laude

Harvard Business School, Baker Scholar



**NGA ANNUAL MEETING BOSTON 1994**



## CONTENTS

|                                     |    |
|-------------------------------------|----|
| General Information                 | 1  |
| Agenda                              | 6  |
| Ancillary Meetings                  | 18 |
| National Governors' Association     | 19 |
| NGA Committees                      | 21 |
| Governors                           | 26 |
| Distinguished Service Award Winners | 30 |
| Corporate Fellows Program           | 32 |
| Meeting Area Floor Plans            | 34 |

**GENERAL INFORMATION**

The National Governors' Association welcomes you to its 86th Annual Meeting. Most official business sessions will be held in the John B. Hynes Convention Center. Additional business sessions will be held at the Sheraton Boston Hotel and Towers. Meeting registration, news media headquarters, the information/message center, and other meeting support operations are in the Convention Center.

General program information, including room assignments, social events, and transportation notes, is contained in this booklet. Also included is information on 1993-94 committee assignments, Governors' terms of office, distinguished service award winners, and NGA's Corporate Fellows Program. Program updates or room changes will be posted at the Meeting Registration Center located in the Convention Center.

**Meeting Support  
Operations**

The following support activities, located in the Convention Center, will be in operation throughout the meeting:

**Information/Message Center**  
Boylston Street Hall, Third Level  
(617) 954-2300

**Meeting Registration Center**  
Ballroom Hallway, Third Level  
(617) 954-2490

**News Media Headquarters**  
Room 302, Third Level  
(617) 954-2516

**Hospitality Center**  
Main Lobby, Plaza Level  
(617) 954-2542

**Office Services**  
Room 310, Third Level  
(617) 954-2513

**Security Command Post**  
Room 210, Second Level  
(617) 954-2550

**Transportation Command Post**  
Room 210, Second Level  
(617) 954-2537

6:53 No. 002 P. 05

JAN 03 '94

ID:508-678-1222

FALL RIVER

## Meeting and Housing Facilities

John B. Hynes Veterans' Memorial Convention Center  
900 Boylston Street  
Boston, Massachusetts 02115  
(617) 954-2000

Sherraton Boston Hotel and Towers  
39 Dalton Street  
Boston, Massachusetts 02199  
(617) 236-2000

The Colonnade Boston  
120 Huntington Avenue  
Boston, Massachusetts 02116  
(617) 424-7000

## Meeting Registration

Meeting attendees other than media representatives can obtain credentials and registration materials at the NGA Meeting Registration Center, located in the Ballroom Prefunction Area on the third level of the Convention Center.

## Registration Hours

|                   |                        |
|-------------------|------------------------|
| Saturday, July 16 | 9:00 a.m. — 5:00 p.m.  |
| Sunday, July 17   | 8:00 a.m. — 5:00 p.m.  |
| Monday, July 18   | 8:00 a.m. — 4:00 p.m.  |
| Tuesday, July 19  | 8:00 a.m. — 12:30 p.m. |

## News Media Registration

Media representatives can obtain credentials and registration materials at the NGA News Media Headquarters, located in Room 302 on the third level of the Convention Center. No registration fee is charged for media representatives. All media representatives must wear NGA credentials to be admitted to business sessions. A limited number of tickets to the Sunday and Monday night social events are available for purchase by registered media at the Hospitality Center, located in the Main Lobby on the plaza level of the Convention Center.

## News Media Headquarters Hours

|                   |                       |
|-------------------|-----------------------|
| Saturday, July 16 | 9:00 a.m. — 6:00 p.m. |
| Sunday, July 17   | 8:00 a.m. — 6:30 p.m. |
| Monday, July 18   | 7:30 a.m. — 7:00 p.m. |
| Tuesday, July 19  | 7:00 a.m. — 1:30 p.m. |

## News Conferences

The News Conference Theater is located in Room 306 on the third level of the Convention Center. This room is available for Governors to hold news conferences, and its use is coordinated through the News Media Headquarters staff in Room 302.

## Identification and Credentials

Each meeting attendee must show identification to obtain registration materials and credentials. *NGA meeting credentials are required for admittance to all NGA meetings and social events.* Credentials will be carefully checked and are not transferable. Please be certain to wear your badge in clear view at all times. Please report lost credentials to the Meeting Registration Center or News Media Headquarters immediately.

For security reasons, each attendee must sign for his or her own credentials. The *only* exception to this policy permits authorized security to sign for the credentials for Governors and Governors' spouses and children.

All NGA credentials have color coded ribbons as indicated below to identify an individual's affiliation.

Governor—White  
Governor's Family—White  
Governor's Official Party—Purple  
Guest—Pink  
Media—Maroon  
Full Corporate Fellow/Associate Corporate Fellow—Green  
Host—Blue  
NGA Staff—Black  
Host Staff—Orange  
Technician—Yellow  
Credential Checker—Red  
NGA Award Winner—Teal  
Guest Accompanying NGA Award Winner—Teal  
Volunteer—Peach  
Exhibitor—Brown

## Seating

In some sessions, special reserved seating will be designated. Your cooperation is appreciated.

## Office Services

Meeting attendees may obtain faxing, word processing, and copying services through Office Services, located in Room 310 on the third level of the Convention Center. Work requests should be scheduled through the office manager. A work area for Governors' staff also will be located in Room 310.

## Office Services Hours

|                   |                       |
|-------------------|-----------------------|
| Saturday, July 16 | 9:00 a.m. — 5:00 p.m. |
| Sunday, July 17   | 8:00 a.m. — 5:00 p.m. |
| Monday, July 18   | 7:00 a.m. — 5:00 p.m. |
| Tuesday, July 19  | 7:30 a.m. — 1:30 p.m. |

## State Technology Exhibits

Exhibits are on display in Exhibit Hall A on the plaza level of the Convention Center featuring applications of technology used in states. Exhibits are open to all attendees.

|                   |                        |
|-------------------|------------------------|
| Saturday, July 16 | 10:30 a.m. — 5:00 p.m. |
| Sunday, July 17   | 9:00 a.m. — 5:30 p.m.  |
| Monday, July 18   | 8:30 a.m. — 1:30 p.m.  |



FALL RIVER

ID:508-678-1222

JAN 03'94

7:04 No.002 P.21

34

### Hynes Convention Center Plaza Level

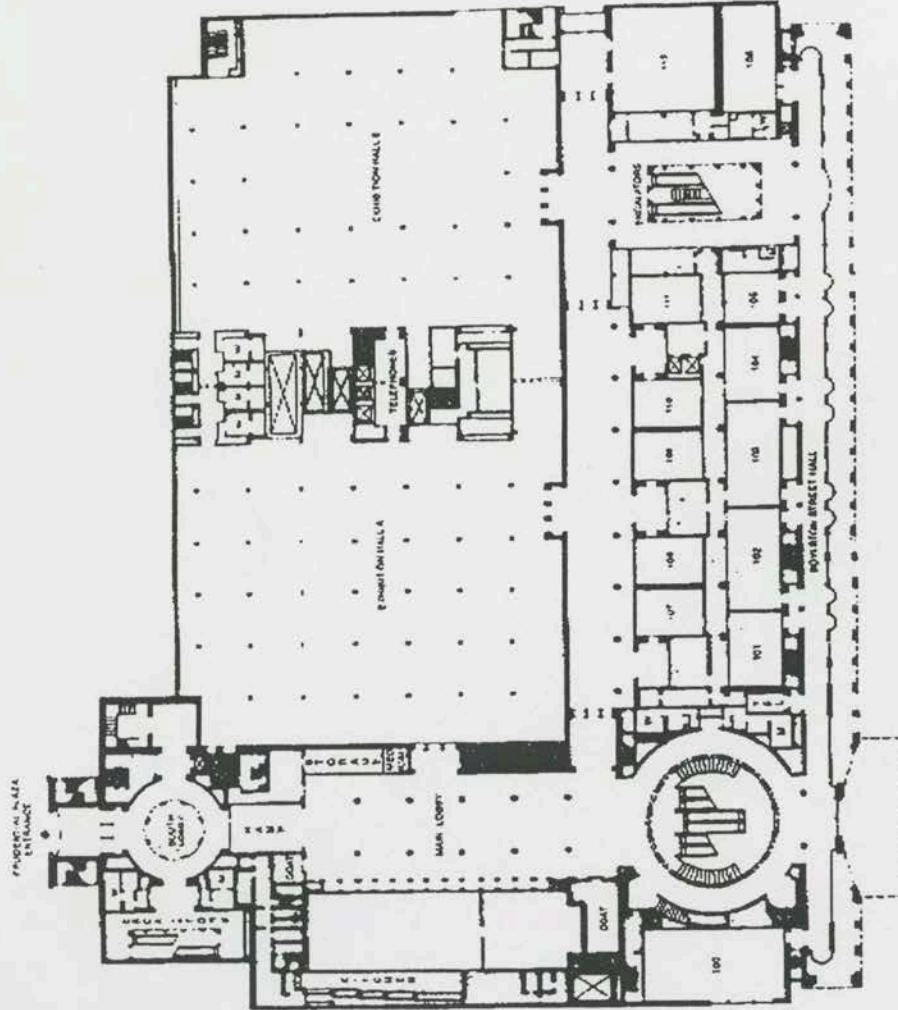

### Hynes Convention Center Second Level

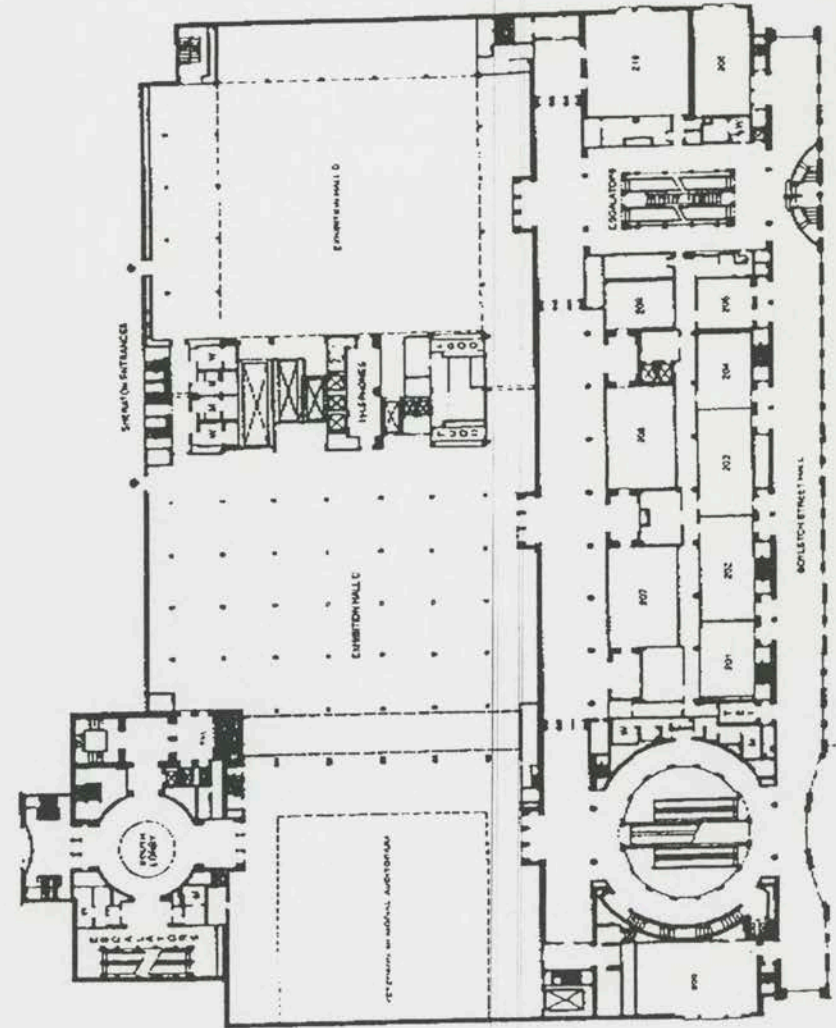

FALL RIVER

ID:508-678-1222

JAN 03 '94

7:04 No.002 P.22

### Hynes Convention Center Third Level

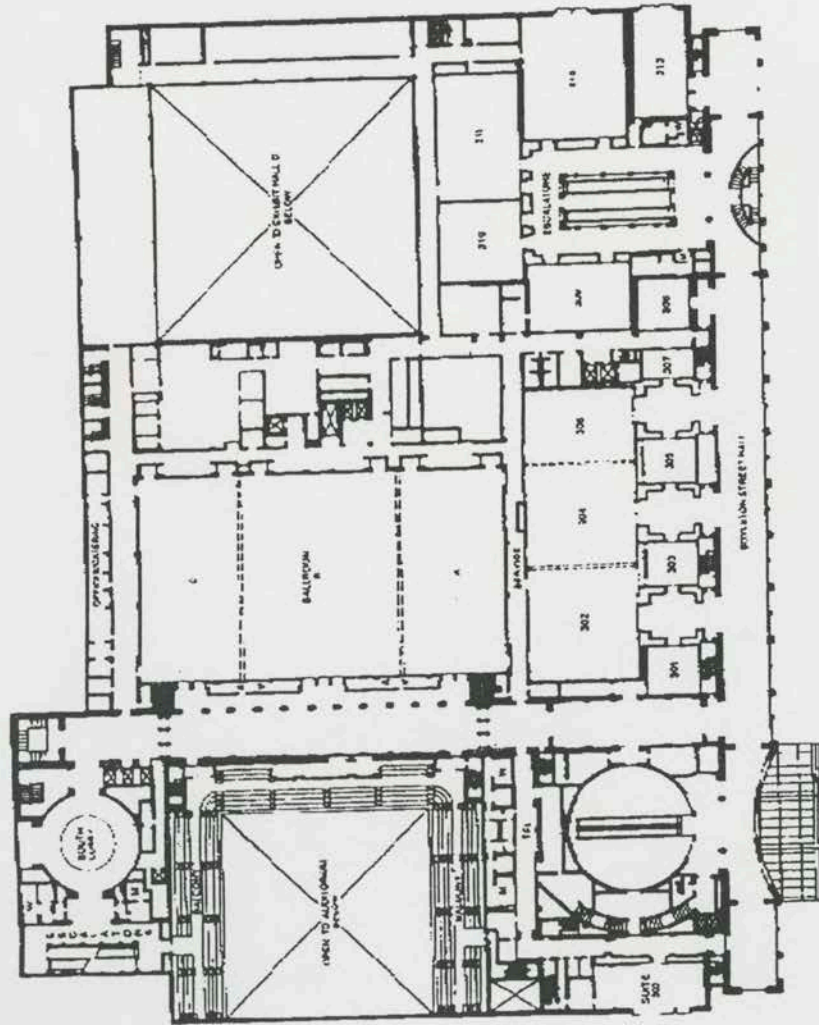

36

### Sheraton Boston Hotel and Towers

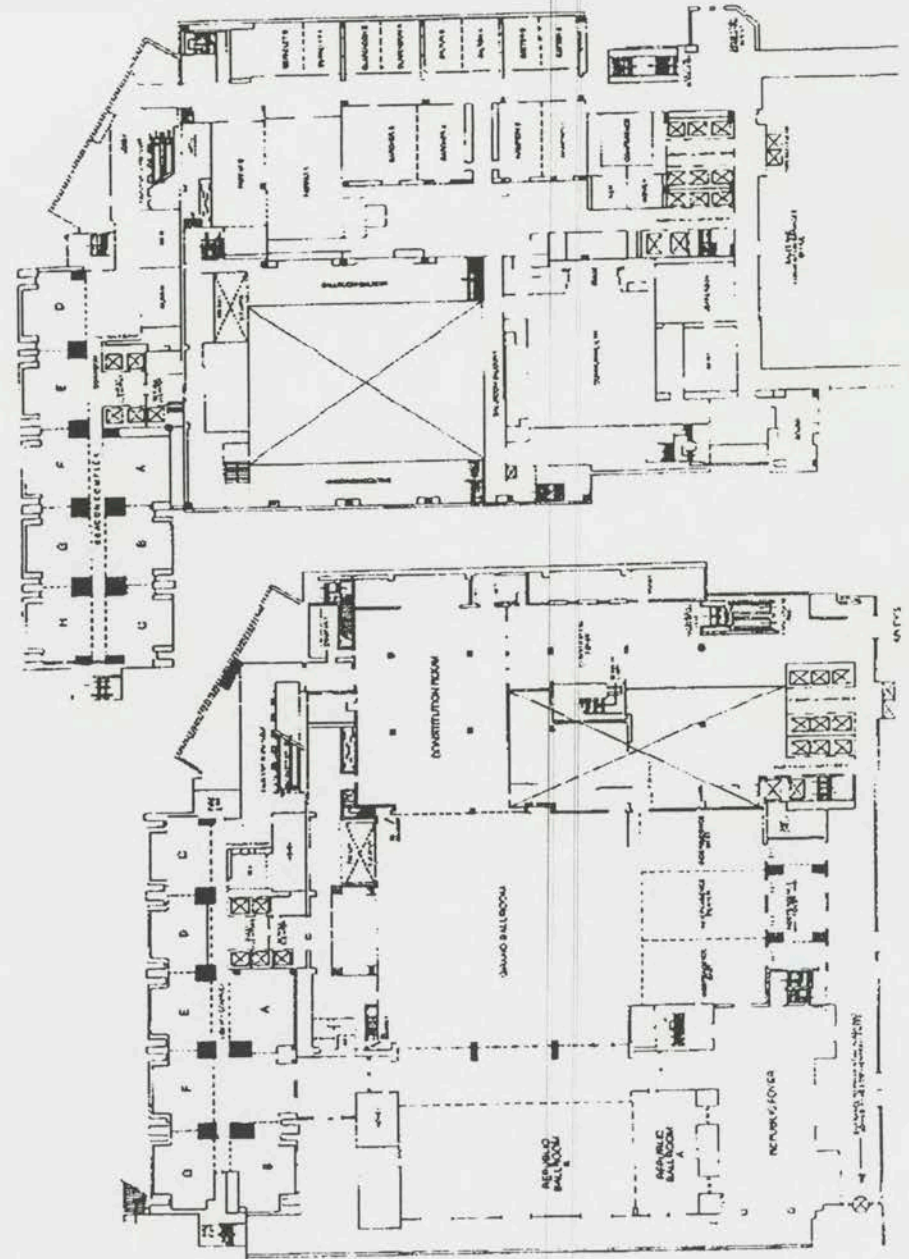

37



## AGENDA

Please note: All events will be held at the John B. Hynes Veterans' Memorial Convention Center unless otherwise indicated.

### SATURDAY, JULY 16

|  |  |
|--|--|
| 6:00 a.m.<br>Main Entrance<br>Sheraton Boston Hotel    | Optional Run/Walk Along the Charles River, Led By<br>Boston-Area Celebrities<br>Open to all attendees  |
| 9:00 a.m.-5:00 p.m.<br>Ballroom Hallway<br>Third Level | General Registration   |
| 9:00 a.m.-6:00 p.m.<br>Room 302<br>Third Level         | News Media Registration  |
| 10:30 a.m.-5:00 p.m.<br>Exhibit Hall A<br>Plaza Level  | State Technology Exhibits<br>Open to all attendees   |
| 10:30 a.m.-11:00 a.m.<br>Room 306<br>Third Level       | Opening News Conference  |
| 11:00 a.m.-1:00 p.m.<br>Room 304<br>Third Level        | School-to-Work Roundtable<br>Governor Jim Edgar, Illinois, Co-Chair<br>Governor James B. Hunt Jr., North Carolina, Co-Chair<br>A light lunch will be provided for Governors and program participants.<br><ul style="list-style-type: none"> <li>Welcome and Introductions</li> <li>Promoting Private Sector Involvement in the Development and Implementation of School-to-Work Transition Systems: State and Local Strategies</li> </ul> <p>Guests:</p> <p>Robert Schwartz, Program Director for Education, The Pew Charitable Trusts</p> <p>Governor William F. Weld, Commonwealth of Massachusetts</p> <p>Emmanuel Berger, Director of Human Resources, New England Medical Center, and Executive Committee Member, ProTech</p> |

### SATURDAY, JULY 16 (continued)

- Lessons from School-to-Work Systems in Europe  

Guest:

Anne Heald, Executive Director, Center for Learning and Competitiveness, The University of Maryland
- Discussion of Trip to Europe for Roundtable Members
- Closing Remarks

|   |  |
|---|--|
| 6:30 p.m.-9:30 p.m.<br>Massachusetts State House<br>Beacon Street   | Reception and Dinner for Governors, Their Spouses, and Invited Guests<br><p>By Invitation</p> <p>Recommended dress is conservative cocktail attire. Governors and their spouses may use the transportation provided by the host state. Invited guests may drive to the event or use special minibuses transportation from the hotels departing from the front of the Sheraton at 6:10 p.m. and 6:25 p.m., and from the Colonnade at 6:15 p.m. and 6:30 p.m. Valet parking will be provided for those who drive. The entrance to this event will be on the Beacon Street side of the State House. NGA credentials must be worn to board the bus, for admittance, and throughout the event.</p>                                |
| 6:30 p.m.-8:30 p.m.<br>Boston Billiard Club<br>126 Brookline Avenue | Reception for Media Attendees<br><p>By Invitation</p> <p>Recommended dress is casual. Bus transportation will be provided from the main entrance of each hotel beginning at 6:15 p.m. and will operate throughout the event. At 8:30 p.m., one bus will offer additional drop-off points at Harvard Square and Faneuil Hall, where attendees may enjoy Boston nightlife; however, return transportation to the hotels will not be provided from these locations. NGA credentials must be worn to board the bus and throughout the event.</p> <p>The Boston Billiard Club will open to the public at 8:30 p.m. After this time, food, beverages, and activities will no longer be complimentary.</p>                          |
| 6:30 p.m.-8:30 p.m.<br>Jillians Billiard Club<br>145 Ipswich Street | Reception for Governors' Senior Staff and Invited Guests<br><p>By Invitation</p> <p>Recommended dress is casual. Bus transportation will be provided from the main entrance of each hotel beginning at 6:15 p.m. and will operate throughout the event. At 8:30 p.m., one bus will offer additional drop-off points at Harvard Square and Faneuil Hall, where attendees may enjoy Boston nightlife; however, return transportation to the hotels will not be provided from these locations. NGA credentials must be worn to board the bus and throughout the event.</p> <p>Jillians Billiard Club will open to the public at 8:30 p.m. After this time, food, beverages, and activities will no longer be complimentary.</p> |



6:55 No.002 P.07

JAN 03 '94

ID:508-678-1222

FALL RIVER

## Social Event Ticket Sales

A regular NGA credential for paying registrants provides admittance to the Sunday and Monday night social events. A limited number of tickets to these social events are available for purchase by registered attendees for their guests and by media attendees and exhibitors. Tickets will be sold on a first-come, first-served basis, are limited to one per attendee, and are not transferable. Only cash, personal checks, or traveler's checks will be accepted for payment. Tickets may be purchased at the Hospitality Center, located in the Main Lobby on the plaza level of the Convention Center, during the following hours:

|                   |                       |
|-------------------|-----------------------|
| Saturday, July 16 | 8:00 a.m. — 7:00 p.m. |
| Sunday, July 17   | 8:00 a.m. — 7:00 p.m. |
| Monday, July 18   | 8:00 a.m. — 7:00 p.m. |

## Information/ Messages

The NGA Information/Message Center, located in the Boylston Street Hall on the third level of the Convention Center, will be open during registration hours to receive messages for meeting attendees and answer general questions. The telephone number for the Message Center is (617) 954-2500. Messages will be retained at the Message Center, and the names of individuals having messages will be displayed on monitors at several locations in the Convention Center. Nonpriority messages for meeting attendees should be communicated through hotel operators.

## Transportation

### To Social Events

The host state will provide bus transportation between the Colonnade and Sheraton Boston hotels and to the Saturday, Sunday, and Monday night social events. NGA credentials must be worn to board the shuttle buses and throughout the events. Because the Monday night social event will be held at Symphony Hall, which is in close proximity to the hotels, meeting attendees are encouraged to walk to the event. See individual program notes for information on appropriate dress and transportation schedules for each event.

### Between Hotels

Due to the close proximity of the hotels and the Convention Center, there is no regular shuttle transportation between these sites. However, transportation may be requested by calling the Transportation Command Post at (617) 954-2537.

### Special Transportation Needs

Attendees with disabilities who need special transportation should inquire at the Hospitality Center, on the plaza level of the Convention Center, or, if urgent, contact the Transportation Command Post at (617) 954-2537.

## Policy Positions

Copies of proposed policies will be available for meeting attendees at the Information/Message Center on the day of the committee session at which the policy will be considered. Amended policy positions, which will be considered at the final plenary session, will be available on Tuesday morning, July 19.

## Office Automation

Wang Laboratories provides a computer system composed of more than twenty-five workstations and printers to support the administrative and data processing needs of NGA's Winter and Annual Meetings. This system supports the administrative offices, as well as the news media headquarters, registration, and information/message center operations of the meeting.

Xerox Corporation supports the administrative operations of NGA's Winter and Annual Meetings by providing copying and facsimile equipment.

## Security/Medical Care

The main Massachusetts Security Command Post is located in Room 210 on the second level of the Convention Center. Security-related questions should be referred to this room, which will operate twenty-four hours a day throughout the meeting. The telephone number is (617) 954-2550. There will be a Medical Care room located in the Main Lobby on the plaza level in the Convention Center to handle medical needs. Please consult the Security Command Post during hours when the Medical Care room is closed.

## Smoking

Room 203, on the second level of the Convention Center, has been designated as the smoking area. Your cooperation is appreciated in refraining from smoking elsewhere in the Convention Center or in the meeting sessions.

## Hospitality Center

As host of the 1994 annual meeting, the commonwealth of Massachusetts has made arrangements to help ensure that meeting attendees enjoy their visit to Boston by providing a Hospitality Center, on the plaza level of the Convention Center. In addition to the events included as part of the meeting program, information has been developed on available recreational and cultural activities, Saturday and Sunday worship services, shopping, sightseeing, and restaurants that attendees may wish to enjoy during their free time. Specific information is available at the Hospitality Center at the Convention Center.

Tote bags for all fully registered attendees will be distributed at the Hospitality Center; to receive a tote bag, attendees must present the claim card received at registration.

## Hospitality Center Hours

|                   |                       |
|-------------------|-----------------------|
| Saturday, July 16 | 8:00 a.m. — 7:00 p.m. |
| Sunday, July 17   | 8:00 a.m. — 7:00 p.m. |
| Monday, July 18   | 8:00 a.m. — 7:00 p.m. |
| Tuesday, July 19  | 8:00 a.m. — 2:00 p.m. |

## Future Meeting Dates and Locations

|   |  |
|---|--|
| 1995 Winter Meeting<br>January 28-31, 1995<br>JW Marriott Hotel<br>Washington, D.C. | 1995 Annual Meeting<br>July 29-August 1, 1995<br>Burlington, Vermont |
|---|--|



# SUNDAY, JULY 17

|   |   |
|---|---|
| 6:00 a.m.<br>Main Entrance<br>Sheraton Boston Hotel                                   | Optional Run/Walk Along the Charles River, Led By<br>Boston-Area Celebrities<br>Open to all attendees   |
| 8:00 a.m.-5:00 p.m.<br>Ballroom Hallway<br>Third Level                                | General Registration  |
| 8:00 a.m.-6:30 p.m.<br>Room 302<br>Third Level  | News Media Registration   |
| 9:00 a.m.-5:30 p.m.<br>Exhibit Hall A<br>Plaza Level                                  | State Technology Exhibits<br>Open to all attendees  |
| 8:45 a.m.-10:30 a.m.<br>USS CONSTITUTION<br>Charlestown Navy Yard                     | Brunch for Governors and Their Families<br>Governors, Spouses, Family Members, and Invited Guests<br>Recommended dress is casual. Flat, rubber-soled shoes are suggested.<br>Governors and their families should use the transportation provided by<br>the host state. Prior to the brunch, each Governor is invited to sign a<br>copper sheath, which will be used in the restoration of the ship. |
| 9:00 a.m.-10:00 a.m.<br>Commonwealth Room<br>Third Floor<br>Sheraton Boston Hotel     | Breakfast Meeting of the Governors' Washington, D.C.,<br>Office Directors and NGA State Contacts<br>By Invitation   |
| 9:30 a.m.-11:00 a.m.<br>Republic Ballroom A<br>Second Floor<br>Sheraton Boston Hotel  | Press Aides Brunch and Work Session<br>By Invitation  |
| 10:00 a.m.-11:00 a.m.<br>Independence Center<br>Second Floor<br>Sheraton Boston Hotel | Staff Advisory Council to the Committee on Human<br>Resources   |
| 10:00 a.m.-11:00 a.m.<br>Independence East<br>Second Floor<br>Sheraton Boston Hotel   | Staff Advisory Council to the Committee on Natural<br>Resources   |
| 10:00 a.m.-11:00 a.m.<br>Independence West<br>Second Floor<br>Sheraton Boston Hotel   | Staff Advisory Council to the Committee on Economic<br>Development and Commerce   |

# SUNDAY, JULY 17 (continued)

11:30 a.m.-1:00 p.m.  
Room 311  
Third Level

- Education Leadership Team**  
Governor Jim Edgar, Illinois, Co-Chair  
Governor James B. Hunt Jr., North Carolina, Co-Chair  
*A box lunch will be provided for Governors and program participants. In addition, a limited number of box lunches will be available for Governors' staff.*
- Welcome and Introductions
  - National Board for Professional Teaching Standards:  
New Perspectives on Professional Development  
Governor James B. Hunt Jr., North Carolina  
*Guests:*  
Megan Carrier Lawson, Teacher, Blowing Rock School,  
Blowing Rock, North Carolina  
Sharon M. Draper, English Department Head, Walnut  
Hills High School, Cincinnati, Ohio
  - Efforts to Redesign and Improve Schools: The  
Annenberg Challenge and the New American Schools  
Development Corporation  
Governor Jim Edgar, Illinois  
*Guests:*  
Vartan Gregorian, President, Brown University  
David T. Keams, Chairman and CEO, New American  
Schools Development Corporation
  - Discussion of Proposed Policy  
Governor James B. Hunt Jr., North Carolina
  - The Role of Technology in Achieving the National  
Education Goals  
Governor Jim Edgar, Illinois

11:30 a.m.-1:00 p.m.  
Room 304  
Third Level

- Health Care Leadership Team**  
Governor Roy Romer, Colorado, Co-Chair  
Tommy G. Thompson, Wisconsin, Co-Chair  
*A box lunch will be provided for Governors and program participants. In addition, a limited number of box lunches will be available for Governors' staff.*
- Health Care Waivers for States  
*Guest:*  
Bruce Vladeck, Administrator, Health Care Financing  
Administration
  - Discussion of Federal Health Reform Legislation
  - Discussion of Proposed Policy

## SUNDAY, JULY 17 (continued)

11:30 a.m.-1:00 p.m.  
Ballroom A  
Third Level

**Welfare Reform Leadership Team**  
Governor Tom Carper, Delaware, Co-Chair  
Governor John Engler, Michigan, Co-Chair

*A box lunch will be provided for Governors and program participants. In addition, a limited number of box lunches will be available for Governors' staff.*

- Brief Update on Federal Welfare Reform Initiatives  
Governor Tom Carper, Delaware  
Governor John Engler, Michigan

- Preventing Teen Pregnancy: Lessons Learned from Model Initiatives

*Moderator:*

Governor Tom Carper, Delaware

*Guests:*

Ann Mulligan, Executive Director, Governor's Council, Maryland, *Governor's Council on Adolescent Pregnancy*

James E. Kirk, Deputy State Director, Department of Social Services, South Carolina, *Teen Companion Program*

Michael A. Carrera, Director, National Adolescent Sexuality Training Center, Children's Aid Society, New York City, New York, *Family Life and Sex Education Program*

- Creating Jobs and Rewarding Work for Families on Welfare: New Approaches

*Moderator:*

Governor John Engler, Michigan

*Guests:*

Gerald H. Miller, Director, Department of Social Services, Michigan, *To Strengthen Michigan Families*  
Maryann Stevens, RISE Program Specialist, Western Region, State of Utah, *Single Parent Employment Demonstration*

Wayne Rowley, President, Industrial Exchange (IndEx) Corporation, Tulsa, Oklahoma, *Creating Jobs for AFDC Families*

## SUNDAY, JULY 17 (continued)

1:15 p.m.-3:30 p.m.  
Ballrooms B and C  
Third Level

### OPENING PLENARY SESSION

Governor Carroll A. Campbell Jr., South Carolina, Chairman

- Welcome to Massachusetts and Boston  
Governor William F. Weld, Massachusetts  
Thomas M. Menino, Mayor of Boston
- Introduction of Technology Exhibits  
Governor Mel Carnahan, Missouri
- CITY YEAR: "Putting Idealism to Work" Through National Youth Service  
*Guests:*  
CITY YEAR Corps Members and Staff
- NGA Distinguished Service Awards
- Federalism and Unfunded Mandates  
Governor George V. Voinovich, Ohio  
Governor Bruce Sundlun, Rhode Island
- The Congressional Health Care Debate: A Republican Perspective  
*Guest:*  
Senator Don Nickles, Oklahoma
- The Congressional Health Care Debate: A Democratic Perspective  
*Guest:*  
Senator George Mitchell, Maine, Majority Leader, United States Senate

3:45 p.m.-5:00 p.m.  
Room 207  
Second Level

### Governors-Only Session

3:45 p.m.-5:00 p.m.  
Republic Ballroom A  
Second Floor  
Sheraton Boston Hotel

Education Update  
*Governors' Staff, Corporate Fellows, and Invited Guests*

3:45 p.m.-5:45 p.m.  
Commonwealth Room  
Third Floor  
Sheraton Boston Hotel

Chiefs of Staff Work Session and Reception  
*By Invitation*



## SUNDAY, JULY 17 (continued)

6:30 p.m.-9:30 p.m.  
John F. Kennedy Library  
and Museum and Grounds  
Columbia Point

**Lobster and Clam Bake**  
*Welcome Reception and Dinner for All Meeting Attendees*

*Recommended dress is "roll-up-your-sleeves-to-eat-lobster" casual. A light sweater or jacket and flat shoes are also suggested. Governors and their families may use the transportation provided by the host state. All other attendees should use the bus transportation, which will depart from the hotels every fifteen minutes beginning at 6:15 p.m. Return transportation will be provided approximately every fifteen minutes. NGA credentials must be worn to board the bus, for admittance, and throughout the event.*

*A limited number of tickets to this event are available for purchase by exhibitors, media attendees, and registered attendees for their guests at the Hospitality Center in the Main Lobby of the Plaza Level in the John B. Hynes Veterans' Memorial Convention Center.*

## MONDAY, JULY 18

6:00 a.m.  
Main Entrance  
Sheraton Boston Hotel

**Optional Run/Walk Along the Charles River, Led By Boston Area Celebrities**  
*Open to all attendees*

7:30 a.m.-9:00 a.m.

**Breakfast Meeting of the Democratic Governors' Association**  
*(See page 17 for details)*

7:30 a.m.-9:00 a.m.

**Breakfast Meeting of the Republican Governors Association**  
*(See page 17 for details)*

7:30 a.m.-7:00 p.m.  
Room 302  
Third Level

**News Media Registration**

8:00 a.m.-4:00 p.m.  
Ballroom Hallway  
Third Level

**General Registration**

8:30 a.m.-1:30 p.m.  
Exhibit Hall A  
Plaza Level

**State Technology Exhibits**  
*Open to all attendees*

## MONDAY, JULY 18 (continued)

9:15 a.m.-11:30 a.m.  
Ballroom A  
Third Level

**Committee on Economic Development and Commerce**  
Governor Terry E. Branstad, Iowa, Chair

- Telecommunications
- Transportation: State-Federal Issues  
*Guest:*  
Secretary Federico Peña, U.S. Department of Transportation
- GATT—Adoption and Implementation  
*Guest:*  
Ambassador Mickey Kantor, United States Trade Representative
- Consideration of Proposed Policy
- Enhancing the State Role in Science and Technology Policy for Economic Growth  
*Guests:*  
Former Governor Richard Thornburgh, Co-Chairman, State-Federal Technology Partnership  
Jack Gibbons, Assistant to the President for Science and Technology

9:15 a.m.-11:30 a.m.  
Room 304  
Third Level

**Committee on Human Resources**  
Governor Pete Wilson, California, Chair

- Streamlining Federal and State Workforce Development Systems  
*Guest:*  
Clarence Crawford, Associate Director, Education and Employment Issues, Health, Education, and Human Services Division, General Accounting Office
- Federal and State Programmatic Barriers to Service Integration: Lessons Learned  
*Guests:*  
Jane Henderson, Assistant Superintendent, Interagency Child and Youth Service Division, California Department of Education  
Cornelius Hogan, Secretary, Vermont Agency for Human Services
- Consideration of Proposed Policy

MONDAY, JULY 18 (continued)

9:15 a.m.-11:30 a.m.  
Room 311  
Third Level

Committee on Natural Resources  
Governor Bob Miller, Nevada, Chair

■ Managing Risk: Making the Right Choices

Guest:

John Graham, Director, Center for Risk Analysis,  
Harvard School of Public Health

■ Consideration of Proposed Policy

■ The State Role in Developing Green Technologies

Guest:

Jack Gibbons, Assistant to the President for Science and  
Technology

■ Preparation for the 1995 Farm Bill

■ The Administration's Environmental Priorities and  
Pending Legislation

Guest:

Administrator Carol M. Browner, U.S. Environmental  
Protection Agency

11:45 a.m.-1:45 p.m.  
Rooms 207  
Second Level

Governors-Only Lunch and Business Session (NGA  
Priority-Setting)

*A staff member from each state is invited to join the meeting at  
1:00 p.m. for the discussion on priority-setting.*

11:45 a.m.-1:45 p.m.  
Room 204  
Second Level

Chiefs of Staff Luncheon

*By Invitation*

MONDAY, JULY 18 (continued)

2:00 p.m.-4:30 p.m.  
Ballrooms B and C  
Third Level

PLENARY SESSION/ EXECUTIVE  
COMMITTEE MEETING

Governor Carroll A. Campbell Jr., South Carolina, Chairman

■ Telecommunications: The Next American Revolution

■ Governors' Discussion of Telecommunications

Governor Terry E. Branstad, Iowa

■ U.S. FIRST: Promoting Interest in Math and Science

Guest:

Dean Kamen, Founder of U.S. FIRST

■ Discussion of Education Issues

Report of the Goals Panel Chair

Governor John R. McKernan Jr., Maine

Report on National Board for Professional Teaching  
Standards

Governor James B. Hunt Jr., North Carolina

■ Fostering Tolerance and Understanding

Guest:

Steven Spielberg, Director, "Schindler's List"

■ Invitation to the Special Olympics

Governor Lowell P. Weicker Jr., Connecticut

■ Executive Committee Business

Consideration of Proposed Policy

Administrative Issues

6:30 p.m.-9:30 p.m.  
Symphony Hall  
Massachusetts Avenue

Multicultural Festival and Boston Pops Esplanade  
Orchestra Concert

*Reception and Dinner Buffet for All Meeting Attendees  
Recommended dress is business casual (jacket, but no tie, for men,  
comparable attire for women). Symphony Hall is located  
approximately two blocks from the hotels. Weather permitting,  
attendees are encouraged to walk to this event along the scenic  
route of the Christian Science Center reflecting pool. Bus  
transportation will be available from the hotels for those who prefer  
not to walk, or in the event of inclement weather. Buses will depart  
from the hotels every fifteen minutes beginning at 6:15 p.m. NGA  
credentials must be worn to board the bus, for admittance, and  
throughout the event.*

*A limited number of tickets to this event are available for purchase  
by exhibitors, media attendees, and registered attendees for their  
guests at the Hospitality Center in the Main Lobby of the Plaza Level  
in the John B. Hynes Veterans' Memorial Convention Center.*

ID: 508-678-1222

JAN 03 '94

FALL RIVER

6:57 No.002 P.11



## TUESDAY, JULY 19

|  |   |
|--|---|
| 6:00 a.m.<br><i>Main Entrance<br/>Sheraton Boston Hotel</i>      | Optional Run/Walk Along the Charles River, Led By<br>Boston-Area Celebrities<br><i>Open to all attendees</i>  |
| 7:00 a.m.-1:30 p.m.<br><i>Room 302<br/>Third Level</i>           | News Media Registration   |
| 8:00 a.m.-12:30 p.m.<br><i>Ballroom Hallway<br/>Third Level</i>  | General Registration  |
| 7:30 a.m.-9:00 a.m.  | Regional Governors' Association Meetings<br>(See page 18 for details.)  |
| 9:15 a.m.-12:00 noon<br><i>Ballrooms B and C<br/>Third Level</i> | <b>CLOSING PLENARY SESSION</b><br>Governor Carroll A. Campbell Jr., South Carolina, Chairman <ul style="list-style-type: none"> <li>■ Remarks<br/>Senator Bob Dole, Kansas, Republican Leader, United States Senate</li> <li>■ Chairman's Remarks</li> <li>■ Recognition of Departing Governors</li> <li>■ Consideration of Proposed Policy</li> <li>■ Remarks from the President</li> </ul> <p><i>Guest:</i><br/>Bill Clinton, President of the United States</p> <ul style="list-style-type: none"> <li>■ Report of the Nominating Committee/Election of Officers</li> <li>■ Recognition of Departing Chairman</li> <li>■ Remarks of the 1994-95 Chair</li> </ul> |
| 12:15 p.m.-12:45 p.m.<br><i>Room 306<br/>Third Level</i>         | Closing News Conference   |
| 12:45 p.m.-1:30 p.m.<br><i>Room 304<br/>Third Level</i>          | 1994-95 Executive Committee and Standing Committee Chairs   |

## ANCILLARY MEETINGS

### SATURDAY, JULY 16

|   |  |
|---|--|
| 8:30 a.m.-11:00 a.m.<br><i>Republic Ballroom B<br/>Second Floor<br/>Sheraton Boston Hotel</i> | National Education Goals Panel General Session |
|---|--|

### SUNDAY, JULY 17

|   |   |
|---|---|
| 8:30 a.m.-10:00 a.m.<br><i>Beacon D<br/>Third Floor<br/>Sheraton Boston Hotel</i> | Council of Governors' Policy Advisors Executive Board Meeting |
| 1:30 p.m.-2:30 p.m.<br><i>Room 205<br/>Second Level</i>                           | National Governor's Security Association                      |

### MONDAY, JULY 18

|  |   |
|--|---|
| 7:30 a.m.-9:00 a.m.<br><i>Independence Room<br/>Second Floor<br/>Sheraton Boston Hotel</i> | Democratic Governors' Association Breakfast Meeting |
| 7:30 a.m.-9:00 a.m.<br><i>Constitution Room<br/>Second Floor<br/>Sheraton Boston Hotel</i> | Republican Governors Association Breakfast Meeting  |
| 2:30 p.m.-3:30 p.m.<br><i>Room 205<br/>Second Level</i>                                    | National Governor's Security Association            |

## TUESDAY, JULY 19

7:30 a.m.-9:00 a.m.  
Republic Ballroom B  
Second Floor  
Sheraton Boston Hotel

Appalachian Regional Commission

7:30 a.m.-8:00 a.m.  
Constitution Room  
Second Floor  
Sheraton Boston Hotel

Joint Breakfast of the Coalition of Northeastern  
Governors and the New England Governors' Conference

8:00 a.m.-8:45 a.m.  
Constitution Room  
Second Floor  
Sheraton Boston Hotel

Coalition of Northeastern Governors

8:45 a.m.-9:00 a.m.  
Constitution Room  
Second Floor  
Sheraton Boston Hotel

New England Governors' Conference

7:30 a.m.-9:00 a.m.  
Republic Ballroom A  
Second Floor  
Sheraton Boston Hotel

Council of Great Lakes Governors

## NATIONAL GOVERNORS' ASSOCIATION

The National Governors' Association, founded in 1908, represents the Governors of the fifty states, the commonwealths of the Northern Mariana Islands and Puerto Rico, and the territories of American Samoa, Guam, and the Virgin Islands. Its missions are to influence the shaping and implementation of national policy and to apply creative leadership to the solution of state problems. The association's operations are supported by member jurisdictions, and its policies and programs are formulated by the Governors.

### Organization

The association meets twice a year, during the winter and in the summer, to develop policy positions and discuss common problems. The policy positions are the policy base for the association's legislative and information efforts.

The NGA chair, vice chair, and other members of the nine-member Executive Committee are elected annually. The Executive Committee supervises the association's operations, on behalf of the entire membership, between its meetings. Bipartisanship is ensured by the Articles of Organization, which require that the chairmanship alternate annually between the two major parties and that a majority of the members of the Executive Committee be of a party other than the chair's.

### Structure

The NGA membership is organized into three standing committees: Economic Development and Commerce, Human Resources, and Natural Resources.

Through NGA's committees, the Governors examine and develop policy and address key state and national issues. Special task forces often are created to focus gubernatorial attention on federal legislation or on state-level issues.

The association works closely with the administration and Congress on state-federal policy issues through its offices in the Hall of the States in Washington, D.C. The association serves as a vehicle for sharing knowledge of innovative programs among the states and provides technical assistance and consultant services to Governors on a wide range of management and policy issues.

The staff is organized around five office areas and three standing committees.

The Office of State-Federal Relations maintains regular contact with congressional leaders and key administration officials to ensure that state concerns are heard in the shaping of national policy.



The Office of State Services provides individualized technical and informational assistance to Governors and their staffs on important governance issues such as management improvement, policy management, and the organization and management of the Governor's office. The office coordinates transition assistance for newly elected Governors and sponsors the New Governors' Seminar.

The Office of Public Affairs coordinates the association's media and public information activities and publications, which convey timely, in-depth analysis and background information on NGA positions and issues of interest to the states.

The Office of Administration and Finance supervises the financial management and administrative functions for the association.

The Center for Policy Research manages the association's overall research and development program, which is guided by the association's priorities established by the Governors. The center supports the committees through the development of background material, issue analysis, and technical assistance. Demonstrations are sponsored within the states to promote innovation in government.

NGA committee staff work with the standing committees' staff advisory councils, composed of state government staff appointed by Governors to represent them in their work with the association, and on policy analysis, development, and implementation.

#### Affiliated Organizations

The Council of Governors' Policy Advisors is a membership organization composed of the policy and planning staff of the nation's Governors. As an affiliated organization, CGPA provides technical expertise, analysis, and information to further the objectives and effectiveness of NGA in representing the interests of state government.

The National Association of State Budget Officers performs research and educational activities in state budgeting. NASBO helps further the objectives of NGA by providing assistance on matters such as analysis of the federal budget and fiscal management issues of both intra- and interstate concern.

#### NGA COMMITTEES 1993-94

##### NGA Executive Committee/Center Board of Advisors

Governor Carroll A. Campbell Jr., South Carolina, Chairman\*  
Governor Howard Dean, M.D., Vermont, Vice Chairman\*  
Governor Roy Romer, Colorado  
Governor Zell Miller, Georgia  
Governor John Engler, Michigan  
Governor George V. Voinovich, Ohio  
Governor Ann W. Richards, Texas  
Governor Gaston Caperton, West Virginia  
Governor Tommy G. Thompson, Wisconsin

##### Finance Committee

Governor Howard Dean, M.D., Vermont, Chair  
Governor Roy Romer, Colorado  
Governor Carroll A. Campbell Jr., South Carolina  
Governor Tommy G. Thompson, Wisconsin

##### Legal Affairs Committee

Governor William F. Weld, Massachusetts, Chair  
Governor John Engler, Michigan  
Governor Mel Carnahan, Missouri

##### Lead Governors on Emergency Response and Mitigation

Governor Lawton Chiles, Florida  
Governor Arne H. Carlson, Minnesota

##### Lead Governors on Federalism

Governor George V. Voinovich, Ohio  
Governor Bruce Sundlun, Rhode Island

##### Lead Governors on Infrastructure

Governor Marc Racicot, Montana  
Governor Bob Miller, Nevada

##### Lead Governors on Controlling Crime and Violence

Governor Pete Wilson, California  
Governor Marc Racicot, Montana  
Governor Bob Miller, Nevada  
Governor Stephen Merrill, New Hampshire  
Governor James B. Hunt Jr., North Carolina  
Governor David Walters, Oklahoma

##### National Education Goals Panel

Governor John R. McKernan Jr., Maine, Chair

\* The chair and vice chair serve as *ex officio* members of all standing committees, task forces, and leadership teams.



JAN 03 '94 7:00 No.002 P.15

JAN 03 '94

ID:508-678-1222

FALL RIVER

|                                       |  |
|---------------------------------------|--|
| <b>Task Force on State Management</b> | Governor Kirk Fordice, Mississippi, Co-Chair<br>Governor Mel Carnahan, Missouri, Co-Chair<br>Governor Fife Symington, Arizona<br>Governor William F. Weld, Massachusetts<br>Governor John Engler, Michigan<br>Governor E. Benjamin Nelson, Nebraska<br>Governor Stephen Merrill, New Hampshire<br>Governor Bruce King, New Mexico<br>Governor James B. Hunt Jr., North Carolina<br>Governor Edward T. Schafer, North Dakota<br>Governor David Walters, Oklahoma<br>Governor Pedro Rosselló, Puerto Rico<br>Governor Bruce Sundlun, Rhode Island<br>Governor Walter D. Miller, South Dakota<br>Governor Mike Lowry, Washington<br>Governor Tommy G. Thompson, Wisconsin |
| <b>Education Leadership Team</b>      | Governor Jim Edgar, Illinois, Co-Chair<br>Governor James B. Hunt Jr., North Carolina, Co-Chair<br>Governor John R. McKernan Jr., Maine<br>Governor Mel Carnahan, Missouri<br>Governor E. Benjamin Nelson, Nebraska<br>Governor Stephen Merrill, New Hampshire<br>Governor Christine T. Whitman, New Jersey<br>Governor Mike Sullivan, Wyoming  |
| <b>Health Care Leadership Team</b>    | Governor Roy Romer, Colorado, Co-Chair<br>Governor Tommy G. Thompson, Wisconsin, Co-Chair<br>Governor Lawton Chiles, Florida<br>Governor Brereton C. Jones, Kentucky<br>Governor Arne H. Carlson, Minnesota<br>Governor Mike Leavitt, Utah   |
| <b>Lead Governors on Medicaid</b>     | Governor John Waihee, Hawaii<br>Governor Walter D. Miller, South Dakota  |
| <b>Welfare Reform Leadership Team</b> | Governor John Engler, Michigan, Co-Chair<br>Governor Tom Carper, Delaware, Co-Chair<br>Governor Pete Wilson, California (ex officio member)<br>Governor Zell Miller, Georgia<br>Governor Evan Bayh, Indiana<br>Governor William F. Weld, Massachusetts<br>Governor Mario M. Cuomo, New York<br>Governor Edward T. Schafer, North Dakota<br>Governor David Walters, Oklahoma (ex officio member)<br>Governor George Allen, Virginia   |

|   |  |
|---|--|
| <b>Committee on Economic Development and Commerce</b> | Governor Terry E. Branstad, Iowa, Chair<br>Governor Mike Sullivan, Wyoming, Vice Chair<br>Governor Jim Guy Tucker, Arkansas<br>Governor Joseph Ada, Guam<br>Governor Evan Bayh, Indiana<br>Governor Joan Finney, Kansas<br>Governor John R. McKernan Jr., Maine<br>Governor William Donald Schaefer, Maryland<br>Governor Kirk Fordice, Mississippi<br>Governor Stephen Merrill, New Hampshire<br>Governor Mario M. Cuomo, New York<br>Governor Edward T. Schafer, North Dakota<br>Governor Froilan C. Tenorio, Northern Mariana Islands<br>Governor Bruce Sundlun, Rhode Island<br>Governor Ned Ray McWhorter, Tennessee<br>Governor Ann W. Richards, Texas<br>Governor George Allen, Virginia<br>Governor Gaston Caperton, West Virginia<br>Governor Tommy G. Thompson, Wisconsin                  |
| <b>Lead Governors on Defense Conversion</b>           | Governor Mario M. Cuomo, New York<br>Governor Carroll A. Campbell Jr., South Carolina  |
| <b>Lead Governors on International Trade</b>          | Governor Ann W. Richards, Texas<br>Governor Tommy G. Thompson, Wisconsin   |
| <b>Committee on Human Resources</b>                   | Governor Pete Wilson, California, Chair<br>Governor David Walters, Oklahoma, Vice Chair<br>Governor Jim Folsom, Alabama<br>Governor Roy Romer, Colorado<br>Governor Lowell P. Weicker Jr., Connecticut<br>Governor Tom Carper, Delaware<br>Governor Lawton Chiles, Florida<br>Governor Zell Miller, Georgia<br>Governor John Waihee, Hawaii<br>Governor Jim Edgar, Illinois<br>Governor Brereton C. Jones, Kentucky<br>Governor John Engler, Michigan<br>Governor Arne H. Carlson, Minnesota<br>Governor Mel Carnahan, Missouri<br>Governor Christine T. Whitman, New Jersey<br>Governor James B. Hunt Jr., North Carolina<br>Governor George V. Voinovich, Ohio<br>Governor Robert P. Casey, Pennsylvania<br>Governor Pedro Rosselló, Puerto Rico<br>Governor Alexander A. Farrelly, Virgin Islands |



JAN 03 '94 7:01 No.002 P.16

JAN 03 '94

ID:508-678-1222

FALL RIVER

**Committee on  
Natural Resources**

Governor Bob Miller, Nevada, Chair  
 Governor Fife Symington, Arizona, Vice Chair  
 Governor Walter J. Hickel, Alaska  
 Governor A.P. Lutali, American Samoa  
 Governor Cecil D. Andrus, Idaho  
 Governor Edwin W. Edwards, Louisiana  
 Governor William F. Weld, Massachusetts  
 Governor Marc Racicot, Montana  
 Governor E. Benjamin Nelson, Nebraska  
 Governor Bruce King, New Mexico  
 Governor Barbara Roberts, Oregon  
 Governor Walter D. Miller, South Dakota  
 Governor Mike Leavitt, Utah  
 Governor Mike Lowry, Washington

**Lead Governors on  
Agriculture**

Governor E. Benjamin Nelson, Nebraska  
 Governor Walter D. Miller, South Dakota

**Lead Governor on  
Federal Facilities**

Governor Cecil D. Andrus, Idaho

**NGA Senior  
Management Staff**

Raymond C. Scheppach, Executive Director  
 Barry L. Van Lare, Deputy Executive Director  
 Charles M. Cochran, Director, Office of Administration  
 and Finance  
 Rae Young Bond, Director, Office of Public Affairs  
 James L. Martin, Director, Office of State-Federal Relations  
 Douglas P. Champion, Director, Office of State Services  
 Timothy J. Masanz, Director, Economic Development  
 and Commerce Group  
 Joseph A. Kayne, Director, Economic Development and  
 Commerce Policy Studies Division  
 Vacant, Director, Human Resources Group  
 Susan Traiman, Director, Education Policy Studies Division  
 Evelyn Ganzglass, Director, Employment and Social  
 Services Policy Studies Division  
 Randolph A. Desonia, Director, Health Policy Studies Division  
 Thomas W. Curtis, Director, Natural Resources Group  
 John Thomasian, Director, Natural Resources Policy Studies  
 Division

# The Governors, Political Affiliations, and Terms of Office, 1994

| State or jurisdiction | Governor                    | Regular term, in years |
|-----------------------|-----------------------------|------------------------|
| Alabama               | Jim Folsom (D)              | 4                      |
| Alaska                | Walter J. Hickel (R) (b)    | 4                      |
| American Samoa        | A.P. Lutali (D)             | 4                      |
| Arizona               | Fife Symington (R)          | 4                      |
| Arkansas              | Jim Guy Tucker (D)          | 4                      |
| California            | Pete Wilson (R)             | 4                      |
| Colorado              | Roy Romer (D)               | 4                      |
| Connecticut           | Lowell P. Weicker Jr. (CP)  | 4                      |
| Delaware              | Tom Carper (D)              | 4                      |
| Florida               | Lawton Chiles (D)           | 4                      |
| Georgia               | Zell Miller (D)             | 4                      |
| Guam                  | Joseph Ada (R)              | 4                      |
| Hawaii                | John Waihee (D)             | 4                      |
| Idaho                 | Cecil D. Andrus (D)         | 4                      |
| Illinois              | Jim Edgar (R)               | 4                      |
| Indiana               | Evan Bayh (D)               | 4                      |
| Iowa                  | Terry E. Branstad (R)       | 4                      |
| Kansas                | Joan Finney (D)             | 4                      |
| Kentucky              | Brereton C. Jones (D)       | 4                      |
| Louisiana             | Edwin W. Edwards (D)        | 4                      |
| Maine                 | John R. McKernan Jr. (R)    | 4                      |
| Maryland              | William Donald Schaefer (D) | 4                      |
| Massachusetts         | William F. Weld (R)         | 4                      |
| Michigan              | John Engler (R)             | 4                      |
| Minnesota             | Arne H. Carlson (R)         | 4                      |
| Mississippi           | Kirk Fordice (R)            | 4                      |
| Missouri              | Mel Carnahan (D)            | 4                      |

| Present term began | Number of previous terms |
|--------------------|--------------------------|
| 4-93(a)            | —                        |
| 12-90              | 1(c)                     |
| 1-93               | 1(d)                     |
| 3-91(e)            | —                        |
| 12-92(f)           | —                        |
| 1-91               | —                        |
| 1-91               | 1                        |
| 1-91               | —                        |
| 1-93               | —                        |
| 1-91               | —                        |
| 1-91               | —                        |
| 1-91               | 1                        |
| 12-90              | 1                        |
| 1-91               | 3(g)                     |
| 1-91               | —                        |
| 1-93               | 1                        |
| 1-91               | 2                        |
| 1-91               | —                        |
| 12-91              | —                        |
| 1-92               | 3(h)                     |
| 1-91               | 1                        |
| 1-91               | 1                        |
| 1-91               | —                        |
| 1-91               | —                        |
| 1-92               | —                        |
| 1-93               | —                        |

NOTES: Political affiliations: Democrat (D), Republican (R), Independent (I), Connecticut Party (CP), New Progressive Party (NPP).

- (a) Governor Folsom, as lieutenant governor, became Governor in April 1993 after Guy Hunt left office. He will serve the remainder of Governor Hunt's term, which expires in January 1995.
- (b) Governor Hickel's party affiliation was Independent until April 1994, when he changed his affiliation to Republican.
- (c) Governor Hickel served a previous term from December 1966 to 1969, when he resigned to become secretary of the U.S. Department of the Interior.
- (d) Governor Lutali served a previous term from 1985 to 1989.
- (e) Governor Symington was elected in a February 26, 1991, runoff election. No candidate in the November 1990 general election had received a majority of votes, as required by Arizona law.
- (f) Governor Tucker, as lieutenant governor, became Governor after Bill Clinton was elected President and resigned as Governor in December 1992. Governor Tucker is eligible to run for a four-year term in 1994.
- (g) Governor Andrus served previous terms from 1971 to 1975 and from 1975 to 1977. In 1977 he resigned to become secretary of the U.S. Department of the Interior. He also served from 1987 to 1991.
- (h) Governor Edwards served previous terms from 1972 to 1976, 1976 to 1980, and 1984 to 1988.



JAN 03 '94 7:02 No.002 P.18

JAN 03 '94

ID:508-678-1222

FALL RIVER

|                      |                             |      |
|----------------------|-----------------------------|------|
| Montana              | Marc Racicot (R)            | 4    |
| Nebraska             | E. Benjamin Nelson (D)      | 4    |
| Nevada               | Bob Miller (D)              | 4    |
| New Hampshire        | Stephen Merrill (R)         | 2    |
| New Jersey           | Christine T. Whitman (R)    | 4    |
| New Mexico           | Bruce King (D)              | 4    |
| New York             | Mario M. Cuomo (D)          | 4    |
| North Carolina       | James B. Hunt Jr. (D)       | 4    |
| North Dakota         | Edward T. Schafer (R)       | 4    |
| Northern Mariana Is. | Froilan C. Tenorio (D)      | 4    |
| Ohio                 | George V. Voinovich (R)     | 4    |
| Oklahoma             | David Walters (D)           | 4    |
| Oregon               | Barbara Roberts (D)         | 4    |
| Pennsylvania         | Robert P. Casey (D)         | 4    |
| Puerto Rico          | Pedro Rosselló (NPP)        | 4    |
| Rhode Island         | Bruce Sundlun (D)           | 2(i) |
| South Carolina       | Carroll A. Campbell Jr. (R) | 4    |
| South Dakota         | Walter D. Miller (R)        | 4    |
| Tennessee            | Ned Ray McWhorter (D)       | 4    |
| Texas                | Ann W. Richards (D)         | 4    |
| Utah                 | Mike Leavitt (R)            | 4    |
| Vermont              | Howard Dean, M.D. (D)       | 2    |
| Virginia             | George Allen (R)            | 4    |
| Virgin Islands       | Alexander A. Farrelly (D)   | 4    |
| Washington           | Mike Lowry (D)              | 4    |
| West Virginia        | Gaston Caperton (D)         | 4    |
| Wisconsin            | Tommy G. Thompson (R)       | 4    |
| Wyoming              | Michael Sullivan (D)        | 4    |

|         |      |
|---------|------|
| 1-93    | —    |
| 1-91    | —    |
| 1-91    | 1(i) |
| 1-93    | —    |
| 1-94    | —    |
| 1-91    | 2(j) |
| 1-91    | 2    |
| 1-93    | 2(k) |
| 12-92   | —    |
| 1-94    | —    |
| 1-91    | —    |
| 1-91    | —    |
| 1-91    | —    |
| 1-91    | 1    |
| 1-93    | —    |
| 1-93    | 1    |
| 1-91    | 1    |
| 4-93(m) | —    |
| 1-91    | 1    |
| 1-91    | —    |
| 1-93    | —    |
| 1-93    | 1(n) |
| 1-94    | —    |
| 1-91    | 1    |
| 1-93    | —    |
| 1-93    | 1    |
| 1-91    | 1    |
| 1-91    | 1    |

- (i) Governor Miller, as lieutenant governor, became Governor after Richard H. Bryan was elected to the U.S. Senate in 1988. Governor Miller was elected to a four-year term in November 1990.
- (j) Governor King served previous terms from 1971 to 1975 and from 1979 to 1983.
- (k) Governor Hunt served previous terms from 1977 to 1981 and from 1981 to 1985.
- (l) An amendment passed in 1992 extended the Governor's term of office from two years to four years beginning with the Governor elected in 1994.
- (m) Governor Miller, as lieutenant governor, became Governor in April 1993 after the death of George S. Mickelson. He will serve the remainder of Governor Mickelson's term, which expires in January 1995.
- (n) Governor Dean, as lieutenant governor, became Governor in August 1991 after the death of Rickard Snelling. He was elected to a full two-year term in November 1992.

## DISTINGUISHED SERVICE AWARD WINNERS

The NGA Distinguished Service to State Government Awards program was established in 1976 to recognize the contributions of state officials and private citizens to state government. A category recognizing outstanding service in the arts was created in 1980. Nominations for the awards are submitted by Governors. Individuals are then selected who best exemplify the vitality and creativity state employees and residents bring to state government. This year, awards are given to three state officials and three private citizens, as well as to two individuals in the arts categories. The award winners will be recognized during the plenary session on Sunday, July 17.

### State Official Winners

**Howard A. Peters III, Illinois**  
*As director of the Illinois Department of Corrections, Peters has succeeded in managing one of the fastest-growing inmate populations in the country through extraordinary leadership, hard work, and innovation.*

**C. James Conrad, Ohio**  
*Conrad, director of the Ohio Department of Administrative Services, founded the Office of Customer Service and has been a strong leader and able administrator by transforming troubled agencies into efficient ones.*

**Manny Martins, Tennessee**  
*The assistant commissioner of the Tennessee Department of Health Bureau of Medicaid Administration, Martins led Tennessee's efforts to abolish a \$3 billion Medicaid program and replace it with TennCare, a new health care program.*

### Private Citizen Winners

**Sandy Snider, Indiana**  
*The mother of ten-year-old Zachary, who was abducted and murdered by a convicted child molester, Snider pushed state legislators to pass a law to create a statewide registry of convicted child molesters and require all state employees who work with children to be screened for prior criminal convictions.*

**Father William T. Cunningham, Michigan**  
*Founder of Focus: HOPE, Detroit's civil and human rights organization, Father Cunningham and his organization have provided food, job training, and employment for more than 100,000 inner-city inhabitants.*

**Annette Wright, Vermont**  
*Wright, foster parent of 100 children, biological parent of 9, and adoptive parent of 1, has given her time, energy and love to all these children, and this is the reason they have grown to be caring, competent adults.*

### Artistic Production

**Bruce Marks, Massachusetts**  
*As artistic director of the Boston Ballet, Marks has transformed the company by attracting the world's finest dancers, expanding the company's repertoire and founding CITYDANCE, a tuition-free ballet training program for inner-city youth.*

### Arts Support

**Terry Haller, Wisconsin**  
*Haller, a volunteer leader and arts benefactor, has donated money and time to help community arts organizations. He pushed for the opening of the American Player's Theatre and developed a partnership between the Dane County Cultural Resources Commission and the Madison Community Foundation.*



## CORPORATE FELLOWS PROGRAM

Recognizing the need for and value of increased cooperation between business and government, the National Governors' Association Center for Policy Research established the Corporate Fellows Program. The program brings together public and private policymakers to exchange knowledge and experience and to stimulate discussion on critical issues, new trends, and factors that affect business, government, and citizens.

In addition to sharing valuable resources and experience, corporations also provide financial support for the work of NGA's Center for Policy Research. We would like to thank the following corporations for their generous support.

### Full Corporate Fellows

Aetna  
American Electric Power  
ARCO  
AT&T  
Bank of America  
Blue Cross of California  
BP America Inc.  
Ciba  
CIGNA Corporation  
The Coca-Cola Company  
Dow Chemical U.S.A.  
Du Pont  
Eastman Kodak Company  
Genentech, Inc.  
General Motors Corporation  
Glaxo Inc.  
Golden Rule Insurance Company  
Johnson & Johnson  
Kraft General Foods, Inc.  
Mass Mutual Life Insurance  
MCI Communications Corporation  
Mercer Management Consulting  
Merck & Company Inc.  
National Center for Manufacturing Sciences  
Northern Telecom  
NYNEX Corporation  
Pfizer Pharmaceuticals  
PFL Life Insurance Company  
Philip Morris U.S.A.  
Phillips Petroleum Company  
The Procter & Gamble Company  
The Prudential Insurance Company of America  
Prudential Securities  
Schering-Plough Corporation  
Scholastic Inc.  
Texaco Inc.  
The Travelers  
TRW, Inc.  
Unilever United States, Inc.  
USWEST Communications  
WANG  
WVX Technologies, Inc.

### Associate Corporate Fellows

ALCOA  
American Express Company  
Amoco Corporation  
Arthur Andersen & Company/Andersen Consulting  
Battelle  
Bechtel Group, Inc.  
Bell Atlantic  
BellSouth  
The BFGoodrich Company  
Blue Cross Blue Shield  
The Boeing Company  
Bristol-Myers Squibb Company  
Browning-Ferris Industries  
Burroughs Wellcome Co.  
Chase Manhattan Corporation  
Chevron U.S.A. Inc.  
Coopers & Lybrand  
CSX Corp.  
Dun & Bradstreet  
Eastman Chemical Company  
EDS  
Exxon  
FMC  
Ford Motor Company  
General Electric Company  
Georgia Pacific Corporation  
Goldman, Sachs & Co.  
GTE Service Corporation  
HealthTrust Inc.  
Hewlett-Packard Company  
Houston Industries Incorporated  
IBM  
J.A. Jones, Inc.  
Johnson Controls, Inc.  
Laidlaw Inc.  
Lederle Labs  
MAPCO Inc.  
Marion Merrell Dow Inc.  
McDonald's Corporation  
Mead Data Central, Inc.  
Meridian Oil  
Mobil  
Monsanto Company  
National Computer Systems  
Nissan North America, Inc.  
Occidental Chemical Corporation  
OXY USA Inc.  
PepsiCo Inc.  
R.J. Reynolds Tobacco Company  
Safety-Kleen  
Stateside Associates  
Sun Company Inc.  
Syntex Laboratories, Inc.  
Toyota Motor Sales, U.S.A., Inc.  
Union Pacific  
Unisys  
United HealthCare Corporation  
United Parcel Service

## GOVERNORS LETTER

### 1. Low Income Subsidy

- They want all low income combined including medicaid eligibles.  
  
(We allow -- don't require -- put limit on how quickly they can buy into private insurance.) Open to compromise.
- Suggest capped entitlement for supplementary benefits not included in basic package.
- Do not want DSH terminated.
  - We agree -- reduce only 25 percent.
  - Administration and Moynihan zero out DSH.
- Undocumented workers
  - They want Federal responsibility.
  - Every plan limits subsidy to legals.

### 2. Medicaid Cap

- They oppose, we include -- open to compromise.
- They want more freedom to reduce costs; i.e., remove mandates -- o.k. to us.
- Administration and Moynihan do not have cap -- they only require states to pay maintenance of effort.

### 3. ERISA

- They want pre-emption so they can do all payer programs.
- We maintain as is.
- Moynihan pre-empts most of ERISA.



4. State Experimentation

- Linked to ERISA -- they want to be able to test out new systems -- including single payer.
- We are silent on state experimentation.

5. Purchasing Co-Ops

- They want full flexibility to design and run these programs.
- We agree -- we leave it entirely up to the states.
- Administration very ~~perspective~~ *proscriptive* -- regulatory health alliances.

6. Health Board

- They oppose strong regulatory role for Federal Board -- they want to retain role for states.
- We have no Health Board, and generally provide "guidelines" to the states leaving decisions up to them.
- Administration places strong control in National Health Board.

7. Health Plans

- Again they seek strong state role.
- We generally agree, giving states guidelines to follow.

8. Insurance Reforms and Community Rating

- They generally support Federal reforms with some flexibility for states to exceed Federal standards. They specifically want to leave it to the states to designate the geographic areas -- we agree.

9. Home and Community Based Care

- They support the Clinton efforts to expand home and community based care.

- We support expanded home -- and community -- based care under Medicaid.
- We do not support a new unfunded entitlement.



DRAFT

## DOLE

## FINANCE

## LABOR

### Mandated Coverage

*No mandates* on employers or individuals.

*No mandates* to buy coverage.

*Mandates* on employers and on individuals.

*Employers* are required, beginning January 1, 1996, to "make available" at least three certified standard health plans, including a fee-for-service and a point-of-service option.

*Employers* are required, beginning January 1, 1998, to pay 80% of the average cost of standard coverage. Firms with between 76 and 999 workers that are "community rated" can instead pay an amount equal to 12% of an employees wage. This percentage is reduced for firms with fewer than 75 workers and average annual salaries of less than \$24,000.

*Individuals* are required to pay the lesser of 20% of the average cost of standard coverage or 3.9% of their wages. Subsidies are available for people with incomes of up to 150% of poverty.

Individuals can obtain coverage through the Federal Employees Health Benefit Plan (FEHBP), through state purchasing "cooperatives," or outside the "cooperatives."

### Benefits

*No standard benefit package*, except for subsidized coverage. Health plans that participate in the small group market (insuring firms with between 2 and 50

All health plans *must provide two standard packages* of benefits: a "comprehensive" plan and a plan that would cover major illness or injuries but

All health plans must provide *standard benefit package*.

|                      | Dole<br>Alternative  | Finance<br>Committee  | Labor<br>Committee  |
|----------------------|--|---|---|
|                      | workers) must offer the "FedMed" package in three forms: fee-for-service, HMO and preferred provider organizations.  | require higher cost-sharing on the part of consumers.   |   |
|                      | <i>Categories of covered services</i> under "FedMed" are defined in the statute. These categories are the same as specified by law for the FEHBP. The Secretary of HHS is directed to spell out the details of coverage in regulation. The actuarial value of the package cannot exceed the actuarial value of the Blue Cross Standard Option policy in the FEHBP. | <i>Categories of covered services</i> for the two plans are defined in the statute. National Health Care Commission defines package in more detail.   | <i>Coverage defined in statute.</i> National Health Board is authorized to recommend benefit changes if the benefit package would require subsidies that would increase the deficit. Congress must consider proposed changes under "fast track" procedures. |
|                      |  | <i>National Health Care Commission</i> determines which services are "medically necessary and appropriate."   | <i>National Health Board</i> determines which services are "medically necessary and appropriate."   |
| Insurance<br>Reforms | <i>Health plans</i> (including self-insured plans) must guarantee issue and renewability of insurance.<br><br>For people who are continuously insured, <i>pre-existing conditions</i> must be covered. People who are not continuously insured can face pre-existing condition exclusions of up to   | <i>Health plans</i> (including self-insured plans) must guarantee issue and renewability of insurance.<br><br>No <i>pre-existing condition</i> exclusion permitted for an initial open season. After that, insurers must cover the pre-existing conditions of people who are continuously insured. Insurers may | <i>Health plans</i> (including self-insured plans) must guarantee issue and renewability of insurance.<br><br>No <i>pre-existing condition</i> exclusions permitted.  |



**Dole  
Alternative**

**Finance  
Committee**

**Labor  
Committee**

six months (in the small group market) or one year (in the individual market).

exclude coverage of the pre-existing conditions of people who are not continuously insured for up to six months (in 1996) and for up to three months thereafter.

*Premiums* vary only by age, geography and family size. Limits variation in premiums based on age.

*Premiums* vary only by age, geography and family size. Limits variation in premiums based on age.

*Premiums* vary only by geography and family type.

**Taxes**

*No new taxes or tax increases.*

Contains 12 *new taxes or tax increases*, including:

Contains 17 *new taxes or tax increases*, including:

- An increase in the tobacco tax of \$1 per pack.
- A 25% tax on "high cost" health plans.
- An increase in the Part B premium for Medicare beneficiaries with high incomes.
- A Medicare payroll tax on all state and local government workers.
- A repeal of the exclusion for employer-provided health benefits

- An increase in the tobacco tax of \$1.50 per pack.
- A payroll tax on workers and firms with 500 or fewer employees.
- "Sense of the Committee" language that a tax equal to 1% of payroll should be assessed against all self-insured plans.
- A tax of 1% on all health insurance premiums, including self-insured plans.

**Dole  
Alternative**

**Finance  
Committee**

**Labor  
Committee**

**Other  
Financing**

*Medicare and Medicaid savings*  
(include amounts?).

*Medicare and Medicaid savings*  
(include amounts?).

- A 2.5 percent administrative expense "allowance" on premiums.
- A 2 percent premium "assessment" on each health plan carrier within a state, so long as necessary to generate sufficient revenue to cover any outstanding claims against a failed carrier.

Sense of the Committee that *Medicare and Medicaid savings* should equal those proposed in the Administration's Health Security Act (include amounts?).

**New  
Spending**

Provides *premium subsidies* to people with incomes below 150% of poverty for the purchase of the "FedMed" plan. Subsidies phased in subject to the availability of funds.

Provides *premium subsidies* to people with incomes of up to 200% of poverty (250% for children and expectant mothers) for the purchase of the standard benefit package. Subsidies phased in subject to the availability of funds.

*Caps premiums* for all individuals at 3.9% of income. Provides cost-sharing assistance for people with incomes of up to 200% of poverty.

*Caps small business premiums* for firms with fewer than 75 workers and average annual wages below \$24,000.

Establishes *new long-term care entitlement* for people with disabilities.



|                      | Dole<br>Alternative   | Finance<br>Committee   | Labor<br>Committee  |
|----------------------|---|--|---|
| Spending<br>Controls | <p><i>No government controls</i> on health care prices or insurance premiums.</p> <p><i>"Failsafe" budget mechanism</i> to ensure that low-income subsidies and tax deductibility of insurance premiums for people without employer-sponsored coverage do not result in a deficit increase.</p> | <p><i>No government controls</i> on health care prices or insurance premiums.</p> <p><i>"Failsafe" budget mechanism</i> to ensure that low-income subsidies and tax deductibility of insurance premiums for people without employer-sponsored coverage do not result in a deficit increase.</p>      | <p>Establishes <i>global budget and national premium limits</i> on all health plans. Premiums limited to growth in CPI by 1999.</p> <p><i>National Health Board</i> is authorized to recommend benefit changes if the benefit package would require subsidies that would increase the deficit. Congress must consider proposed changes under "fast track" procedures.</p> |
| New<br>Bureaucracy   | None.   | Creates <i>several new bureaucracies</i> , including a National Health Commission, a National Health Benefits Board, a Health Information Advisory Committee, and an independent advisory commission on which will make recommendations on how money in three new federal trust funds will be spent. | Creates <i>20 new bureaucratic entities</i> , including a National Health Board, a National Center for Consumer Advocacy, a National Council on Graduate Medical Education, and a Healthy Students/Healthy Schools Task Force.  |

**Dole  
Alternative**

**Finance  
Committee**

**Labor  
Committee**

**Federal  
Regulation of  
Health Plans**

*State laws* in the following areas are *preempted*: anti-managed care laws, laws mandating benefits, cost-sharing mandates, "quill pen" laws, and laws restricting utilization review.

*Secretary of HHS* to develop minimum guidelines pertaining to quality assurance, consumer protections, access, and financial standards. Directs HHS Secretary and Attorney General to jointly establish and coordinate all-payer fraud and abuse rules. States enforce these standards.

*State anti-managed care laws* are preempted.

All health plans (including self-insured plans) subject to *federal requirements* with respect to: quality, utilization management, credentialing, recordkeeping, grievances, physician participation, alternative dispute resolution, Health Information Network, balance billing, and capital and solvency.

*Federal standards* are enforced by the state against health plans (including self-insured plans) that operate only in one state. Department of Labor enforces standards against multi-state plans.

*State anti-managed care laws* are preempted.

All health plans (including self-insured plans) subject to *federal requirements* with respect to: solvency, reserve, and guarantee fund; premium standards; grievances; delivery; benefits; data collection; access; enrollment; quality; and other requirements.

*Standards for self-insured plans* developed and enforced by Secretary of Labor.

**Purchasing  
Cooperatives**

*Neither requires nor prohibits* development of purchasing cooperatives. Allows small employers (2-50 workers) to purchase health benefit plans through FEHBP.

*Requires states to establish* Health Care Coverage Areas. Requires that FEHBP plans be available in each of these areas. States may, in addition, establish "purchasing cooperatives" in these areas.

*Requires states to establish* community-rating areas and voluntary consumer purchasing cooperatives if none are otherwise established by January 1, 1996. Cooperatives must be operated



|             | Dole<br>Alternative   | Finance<br>Committee  | Labor<br>Committee  |
|-------------|---|---|---|
| Malpractice | <p>Caps <i>non-economic damages</i> at \$250,000.</p> <p><i>Several liability</i> for non-economic and punitive damages.</p> <p>Sliding scale limits on <i>attorney fees</i>.</p> <p><i>Periodic payments</i> for damages of over \$100,000.</p> <p><i>Collateral sources</i> should be deducted from award to plaintiff.</p> <p><i>Statute of limitations</i> on malpractice claims.</p> | <p>Firms with fewer than 500 employees must obtain coverage either through the FEHBP or the cooperative. Firms with between 500 and 999 may, at their option, obtain coverage through the FEHBP or the cooperative.</p> <p>Caps <i>non-economic damages</i> at \$250,000.</p> <p><i>Several liability</i> for non-economic and punitive damages.</p> <p>Sliding scale limits on <i>attorney fees</i>.</p> <p>Mandatory use of <i>alternative dispute resolution</i>.</p> <p>75 percent of <i>punitive damages go to state</i> to fund improved health care quality and safety programs.</p> <p><i>Limited federal preemption</i> of state malpractice laws, allowing more</p> | <p>by non-profit organizations or by a unit of a state or local government.</p> <p>Individuals could purchase coverage either through the FEHBP, through the cooperative, or outside the cooperative.</p> <p><i>Requires states to adopt an ADR</i> mechanism developed by the National Health Board.</p> <p>Sliding scale limits on <i>attorney fees</i>.</p> <p>Allows defendant in a medical malpractice case to petition court for <i>periodic payment</i> of award.</p> <p><i>Collateral sources</i> should be deducted from award to plaintiff.</p> |

|                | Dole<br>Alternative  | Finance<br>Committee  | Labor<br>Committee   |
|----------------|--|---|--|
|                | <p><i>"Clear and convincing" standard</i> for "first-seen" obstetric cases.</p> <p><i>No punitive damages against manufacturer of drugs or devices</i> if FDA approval was obtained without fraud.</p> | <p>stringent state laws to stand.</p> <p>Federal malpractice provisions do not establish basis for bringing actions in federal courts.</p> <p>Secretary of HHS may approve and support state demonstration projects on <i>no-fault medical liability</i>.</p> |  |
| Anti-Trust     | No provision.  | <i>Repeals McCarran-Ferguson</i> with respect to business of health insurance.  | <i>Repeals McCarran-Ferguson</i> with respect to business of health insurance.   |
| Early Retirees | No provision.  | Establishes a <i>10-year minimum funding period</i> for post-retirement medical and life insurance coverage.  | New <i>federal entitlement for retirees</i> aged 55-64. Government pays 80% of coverage costs; employers with current retiree health obligations pay the rest. |
| Single Payer   | No provision.  | States may seek approval from HHS to operate <i>single payer systems</i> , but union-run plans and multi-state employers with at least 5,000 employees would be exempt from participation.  | States may establish <i>single-payer systems</i> and require self-insured employer participation.  |



|                   | Dole<br>Alternative   | Finance<br>Committee   | Labor<br>Committee  |
|-------------------|---|--|---|
| Long Term<br>Care | <p>Treats long-term care services as <i>medical expenses under tax law</i>.</p> <p>Permits <i>long-term care riders</i> to life insurance policies.</p> <p>Excludes certain <i>accelerated death benefits</i> from taxable income.</p> <p>Requires long-term care policies to meet certain <i>consumer standards</i>, as a condition for tax deductibility.</p> <p>Modifies <i>Medicaid long-term care</i>.</p> <p>Creates <i>tax credits for the cost of personal assistance</i> services for people with disabilities who work.</p> | <p>Creates a <i>new capped entitlement program</i> providing home- and community-based services to people with disabilities, regardless of age or income. The program is phased in over seven years, beginning in 1998.</p> <p>Increases the <i>federal Medicaid match rate for long-term care</i> services by 10 percentage points.</p> <p>Permits <i>long-term care riders</i> to life insurance policies.</p> <p>Establishes <i>federal standards for long-term care insurance policies</i>. States are required to certify policies and develop a long-term care insurance standard regulatory and enforcement program, or lose federal Medicaid funds for long-term care.</p> <p>Makes <i>employer contributions to long-term care insurance</i> deductible.</p> <p>Excludes from income <i>amounts received under a long-term care contract</i>.</p> | <p>Creates a <i>new capped entitlement program</i> providing home- and community-based services to people with disabilities, regardless of age or income.</p> <p>Establishes <i>federal standards for long-term care insurance policies</i>.</p> <p>Creates a <i>federally sponsored program</i> called "Life Care" which would offer long-term care policies covering \$30,000, \$60,000 or \$90,000 of asset protection. Individuals ages 35 and older can buy these policies, with open seasons a 10-year intervals. Prior to implementing "Life Care" the Secretary of HHS must study the cost of premiums, projected enrollment and projected utilization of this program,</p> |

**Dole  
Alternative**

**Finance  
Committee**

**Labor  
Committee**

**Underserved  
Areas**

Establishes safeguards to *enhance access to local health services* and practitioners for vulnerable populations.

Funding to assist providers and health plans to *establish networks in underserved areas*.

Funding to *increase primary care capacity* in medically underserved areas.

More *flexible rules for Medicare providers* in underserved areas.

Creates an *infrastructure account* within the Health Security Trust Fund to support underserved areas, including:

- *The development of community health networks* and certified health plans;
- *Operating assistance for community health networks* and certified health plans to improve access to care;
- *Capital assistance* for the acquisition, modernization, conversion, and expansion of facilities and equipment purchases; and
- *Telemedicine* demonstration projects.

and report to Congress.

*Creates xx new public health programs*, including: Core Functions of Public Health Programs, National Initiatives Regarding Health Promotion and Disease Prevention, Development of Telemedicine in Rural Underserved Areas, and Enabling and Supplemental Services.



**Dole  
Alternative**

**Finance  
Committee**

**Labor  
Committee**

Authorizes a *new program of federal formula payments to teaching hospitals* and academic health centers that operate teaching hospitals to assist with specialized costs they incur that are not routinely incurred by other health care providers.

|                         | Dole<br>Alternative   | Finance<br>Committee  | Labor<br>Committee  |
|-------------------------|---|---|---|
| Health<br>Professionals | Establishes independent <i>Advisory Commission on Workforce</i> to issue reports on specific questions of workforce policy and payment. The Commission also will explore ways to establish a broader base (complementing Medicare dollars) to fund graduate medical education, research and teaching hospitals. | Imposes a <i>new tax of 1.75 percent on all health insurance premiums</i> . Self-insured employers are taxed at 1.75 percent on all their health care costs and administrative expenses. The revenue raised by this tax is placed in trust funds to finance academic health centers, medical education and health research. | <p>Creates a <i>National Council on Graduate Medical Education</i> to designate for each academic year the number of individuals who are authorized to be enrolled in graduate medical education programs. This new Council will assure that at least 55 percent of individuals completing eligible programs nationwide be in primary care, beginning in academic year 2000-01. The Council also will designate the number of positions in each medical specialty, beginning in academic year 2000-01.</p> <p>Establishes <i>federal formula payments for the operation of approved physician training programs</i>, approved podiatric residency programs, and approved dental residency programs.</p> <p>Creates a <i>Medical School Fund Account</i> from which payments will be made to assist with the direct costs of academic programs, including the education of medical students, graduate students in biomedical sciences and unfunded faculty research.</p> |