

Congressman Pat Roberts

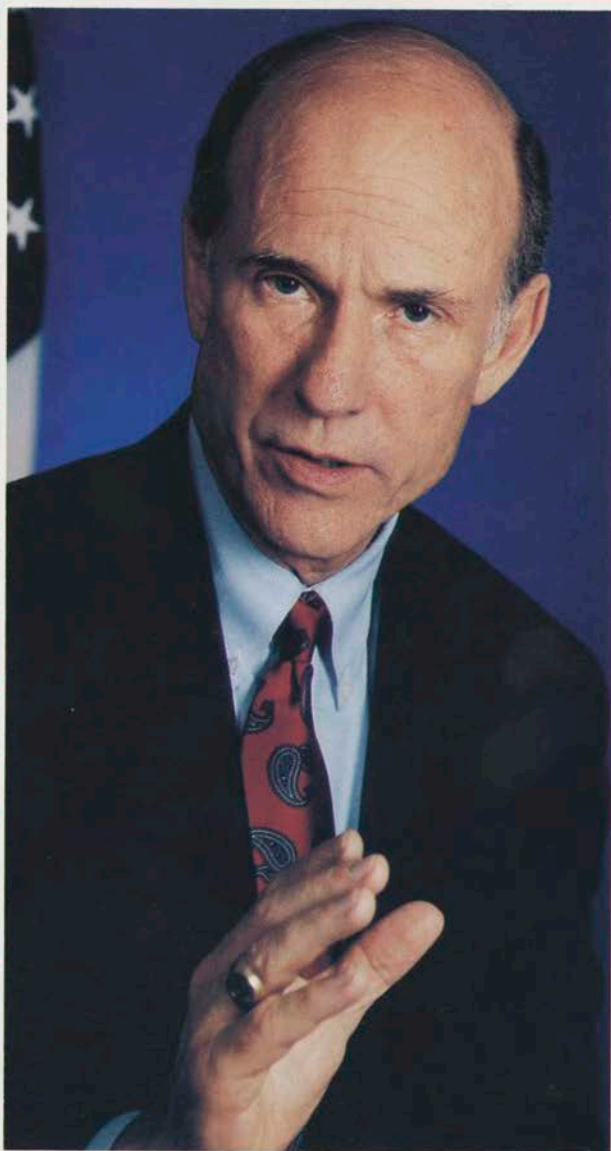

Making a difference for Kansas

Congressman Pat Roberts

Congressman Pat Roberts of Dodge City has an outstanding record. No individual problem is too small, no job is too big, to get his personal attention. He stays in touch. He protects our interests. He's fighting for change.

WINNING the fight to clean up Congress. Pat's reform efforts curbed bounced checks at the House bank, unpaid restaurant bills, patronage in the post office, perks and free mail.

EARNING two dozen awards from prestigious watchdog groups with his votes against deficit spending and more taxes.

WRITING key provisions of three farm bills to assist our farmers and ranchers, preserve our land and protect our communities.

WORKING for health care reform. As a co-chairman of the House Rural Health Care Coalition, he's getting doctors, nurses and other professionals in rural areas and making sure our rural hospitals and elderly get a fair shake.

"I ask for your vote and for the privilege of representing the First District. Working together, we are making a difference."

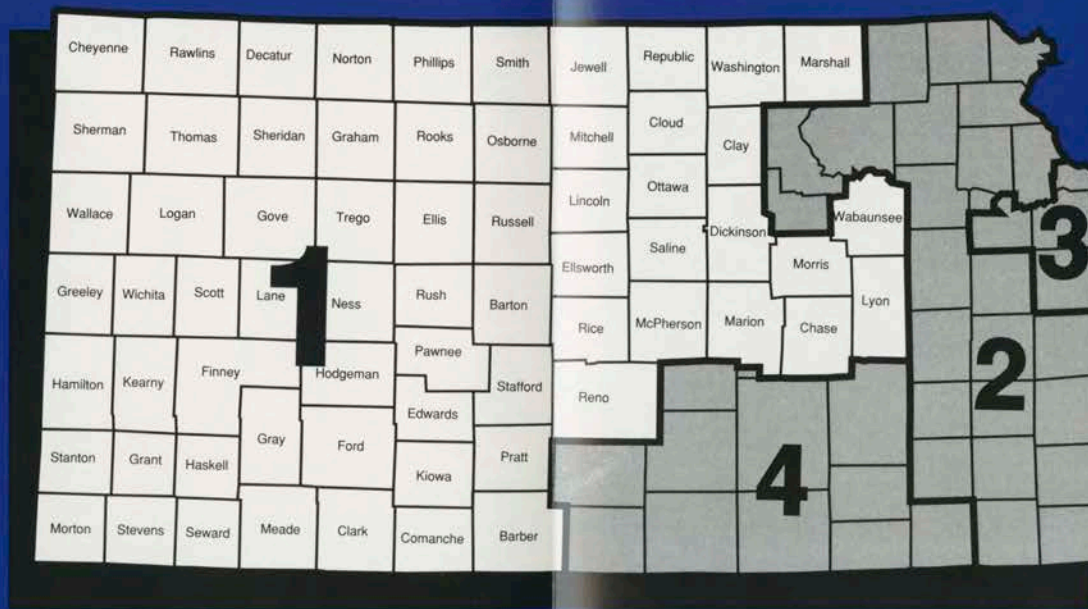

Pat Roberts ♦ ♦ ♦

For Congress in the First District

Congressman
Pat Roberts
PO Box 15, Dodge City, KS 67801-0015

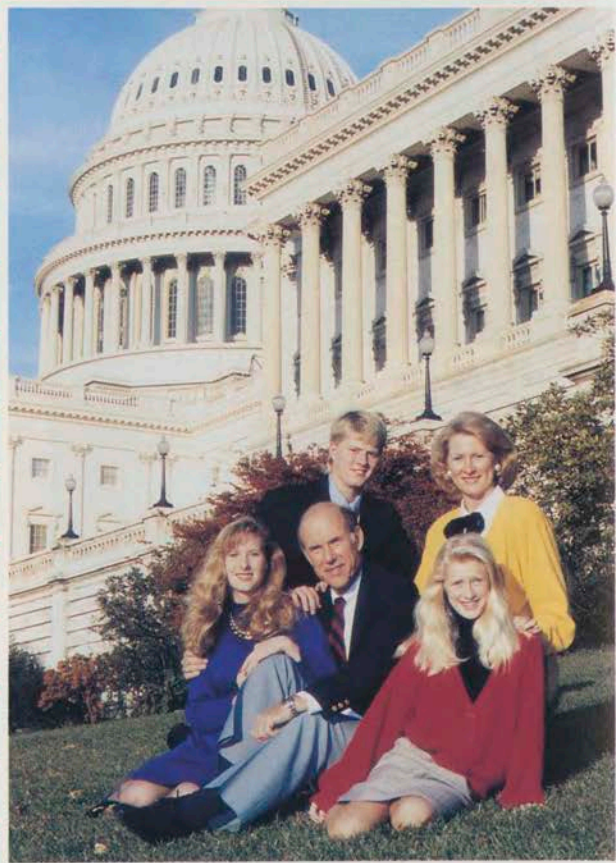

- Pat, Franki, Anne-Wesley, David, Ashleigh
- Fourth Generation Kansan
- Graduate, Kansas State University
- Marine Corps Veteran
- House Agriculture Committee
- Co-Chair, House Rural Health Care Coalition

Pat Roberts . . . For Congress in the First District

Flowers for Senate

Committed
Responsible
Responsive
Effective

Paul Flowers
Republican Candidate
Kansas Senate — 33rd District

A Fresh Viewpoint

As a candidate for the Kansas Senate 33rd District seat, Paul Flowers carries with him certain ideas and values which he hopes to implement as a state senator.

These ideas and values have to do with the way the government fits into, and deals with many aspects of your life.

*Role of Government

An ideal government furnishes only the services absolutely necessary to provide for the common good of the people. However, it now appears that state and federal government are representing the tax-*users* more than the tax-*payers*. Working together, we can return representation to those who pay for and want good government.

*Role of Agriculture

Agriculture is the backbone of our region. We must protect the resources of grain storage as well as the highways and railroads so necessary in reaching markets.

*Role of Business

A healthy business climate will supply more jobs, stimulate housing growth, and further contribute to the overall well-being of a community. Lower taxes, lower interest rates, and less government regulation will promote business activity.

*Role of the Family

I believe that strong family values are some of the most important fundamentals in our society. Honesty, caring, trust, responsibility, and learning are all essential to good citizenship. Public education should further encourage these qualities.

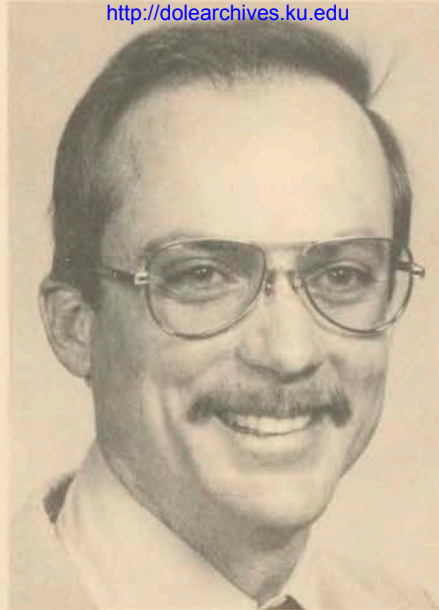

Paul Flowers

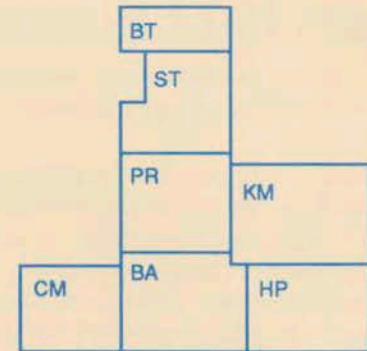

33rd District Kansas Senate

Issues and Positions

I support good highways in Kansas. The fuel tax and registration fee increase which fund the comprehensive highway program are fair methods of building for our future. However, I believe that the 20-year highway bonds are inappropriate burdens on tomorrow's taxpayer.

Kansas is creating a welfare state. In the last legislative session, the state budget for SRS was raised to more than \$1 billion. This agency will also receive 417 new employees. I believe we should cut \$100 million from the SRS budget and concentrate on returning welfare recipients to the work force.

The new 32 mill school finance bill will have far-reaching effects. While the concept of equal education statewide has merit, greater state control may eventually result in school consolidations which are unwanted locally. It would stand to reason that Topeka may also begin to dictate curriculums and textbooks more readily. In addition, the uniform mill levy is already prompting suggestions that the state may completely take over property re-appraisal from the counties. I believe that further state control over re-appraisal will result in even more turmoil that we have already experienced.

Property taxes need to be reduced. I favor having the state return 14% of the severance tax to local government, instead of the current 7%. This would produce an extra \$6 million for local government statewide, which would begin to offset local property taxes.

Finally, I wish to address the problems that local government experiences as a result of unfunded mandates from the state and federal levels. The state forces counties to pay for the costs of district courts, court trustee programs, juvenile detention, emergency preparedness, and property re-appraisal. However, the counties are given very little actual control over these programs. Similarly, the federal government is forcing us to spend money to comply with new regulations for landfills and criminal rights. While many of these programs may be worthwhile, it is foolish to assume that local government can afford to pay the cost just because someone in Topeka or Washington, D.C. thinks it is a good idea.

I appreciate your help in addressing these issues, and your vote for the 33rd District Seat in the Kansas Senate.

Who is Paul Flowers?

Paul Flowers, 40, of Coldwater, is currently serving as the county commission chairman from Comanche County.

In that role, Flowers has consistently supported rural hospitals, economic development, and improvement of roads and bridges; he also maintains regular contact with state legislators in Topeka. As a county commissioner, he writes a monthly column which is printed in the local paper, inviting constituent feedback.

Paul also does consulting work in the trucking industry, and is sensitive to the needs of business in Kansas.

Paul was raised and educated in Kansas, graduating with honors from Southwestern College in Winfield, with a bachelor's degree in biology. He then did his graduate work in biology at Arizona State University in Tempe.

Having spent eight years working for local, state, and federal agencies, Paul understands the relationship between the various levels of government.

Paul is currently president of the KWORCC Board of Directors. KWORCC is a state-wide workers' compensation insurance pool for Kansas counties. He is also a member of the KCAMP Board of Directors. KCAMP is a multi-line insurance pool for member counties. Both organizations were started by the Kansas Association of Counties, and are based in Topeka.

Flowers also serves on the board of Great Plains Development, Inc., of Dodge City, and is first vice-president of Sunflower Resource Conservation and Development, Inc., in Harper. In addition, he just completed a two-year appointment on the Local Elected Officials Board in Hays for the state Job Training Partnership Act, Service Delivery Area 1.

The newly re-aligned 33rd Senatorial District includes Barber, Comanche, Harper, Kingman, Pratt, and Stafford Counties, as well as the southern portion of Barton County.

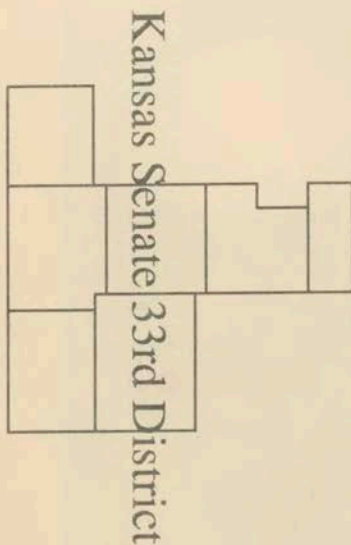

Flowers for Senate

P.O. Box 414

Coldwater, KS 67029-0414

(316) 582-2787

AUGUST 3, 1992

To Dan
FROM Joyce
I have 3
letters. Will
send over in run

TO: JOYCE
FROM: DAVE
SUBJECT: JULY 31 - AUGUST 1, 1992 TRIP

GREAT BEND

BILL ROBBENS - FARMERS BANK (316-792-2411) RE: BANKING BILL
- \$100 MILLION AGGREGATE VERSUS PER LOCATION.

GARY BAINBRIDGE WITH THE NATIONAL GUARD - PROVIDE UPDATE ON
NEW NATIONAL GUARD ARMORY. (316-793-9366).

GILBERT SELTMANN - QUESTION ON SOCIAL SECURITY BENEFITS.
CURRENTLY GETTING APPROX. \$300 MONTH AND WANTS IT TO BE
INCREASED. (316-372-4235).

MISC. -

MARCIE TO DO LETTER ON JOE HUNTER'S SON. LETTER IN
BRIEFING BAG.

SOMEONE NEEDS TO CHECK OUT WHEN ROB SOUTHERN WORKED FOR
DOLE. HIS FATHER BOB COMMENTED ON HIS GOOD EXPERIENCE.
SENATOR WANTS TO KNOW WHEN AND WHERE.

P-BURG

AIRPORT - LETTER IN BRIEFING BAG. GREG TO FOLLOW UP.

WICHITA OFFICE WILL COORDINATE GOLD SEAL THANK YOUS.

FINAL

CONTACTS:

Judy Brown
913/295-2745 (o)
913/836-2319 (h)
Jo-Anne Coe
202/408-5086 (o)
703/845-1714
Gale Grosch
913/371-6108 (o)
816/373-8468 (h)
Yingling Aircraft
316/943-3246

Oy

WEATHER:

FRIDAY - Partly cloudy skies, highs in the low 80's, low around 60 degrees. 30% chance of thunderstorms in the Russell area.

SATURDAY - Partly cloudy skies, high near 90 degrees. Light winds from the south. No precipitation expected.

KANSAS SCHEDULE FOR FRIDAY, JULY 21, SAT., AUGUST 1

FRIDAY, JULY 31

4:20 p.m. Lv. Washington for Kansas City
U.S. Air Flight #211

5:54 p.m. Ar. Kansas City
MET BY: GALE/DAVE

6:15 p.m. Lv. KCI Executive Beech for Topeka
KCI Executive Beech - 816/243-6440

AIRCRAFT: Cessna 414 Chancellor
TAIL NO.: 12436
SEATS: 5
PILOT: Mithcell Mosiman
CO-PILOT: Dennis Richmeier
FLIGHT TIME: 24 mins.

MANIFEST: Senator Dole
Dave Spears

6:40 p.m. Ar. Philip Billard
T.J. Terminal - 913/234-2602

MET BY: Judy

DRIVE TIME: 8-10 mins.

6:50 p.m. Ar. Ramada Inn Downtown - Shrine Bowl Banquet

7:00 p.m. TOPEKA - KANSAS SHRINE BOWL HONORS
to BANQUET - Ramada Inn Downtown - players,
7:30 p.m. parents, Shriners & friends. SPEAK

CONTACT: Dr. David Sager, 913/537-9414

ATTENDANCE: 1000

Banquet Theme - "Picnic in the Park in
an election year"

7:30 p.m. Lv. Ramada Inn for Philip Billard

DRIVER: Judy

DRIVE TIME: 8-10 mins.

7:45 p.m. Wheels up for Russell

AIRCRAFT: Cessna 414 Chancellor

TAIL NO.: 12436

SEATS: 5

PILOT: Mitchell Mosiman

CO-PILOT: Dennis Richmeier

FLIGHT TIME: 57 mins.

MANIFEST: Senator Dole
Dave Spears

8:45 p.m. Ar. Russell - Super Aviation
913/483-6173

*City van will be at the airport.

eye doctor apptm.

RON - Russell

Dave Spears - Winchester Inn - 913/483-6660

SATURDAY, AUGUST 1

8:15 a.m. Lv. Russell Airport for Great Bend

AIRCRAFT: Cessna 414 Chancellor
TAIL NO.: 12436
SEATS: 5
PILOT: Mitchell Mosiman
CO-PILOT: Dennis Richmeier
FLIGHT TIME: 15 mins.

MANIFEST: Senator Dole
Dave Spears

8:35 a.m. Ar. Great Bend Airport
Midwest Piper Sales - 316/793-7471

MET BY: Charlie Steincamp
316/793-8502

Bob Parrish plans to meet you at the fair -- Polly may have to be in Lawrence to help her kids move.

8:45 a.m. GREAT BEND - WELCOME-RIBBON CUTTING FOR
to BARTON COUNTY FAIR.
10:00 a.m.

CONTACT: Ron Koelsch
316/797-0051

CHUCK WAGON BREAKFAST - 7:30-9:00 a.m.

**Congressman Pat Roberts will speak at the ribbon cutting which should conclude at about ten till nine. If you arrive in time, they would like you to say a few words also.

10:15 a.m. Lv. Great Bend for Phillipsburg

AIRCRAFT: Cessna 414 Chancellor
TAIL NO.: 12436
SEATS: 5
PILOT: Mitchell Mosiman
CO-PILOT:
FLIGHT TIME: 36 mins.

MANIFEST: Senator Dole
Dave Spears

10:50 a.m. Ar. Phillipsburg Airport
Hill Aviation - 913/543-2421

MET BY: Janene Schneider
913/689-7571

11:00 a.m. LUNCH - Gene Davidson, Kansas Senate
to candidate, special guest
Noon Colonial Lounge - 913/543-2863

CONTACT: Janene Schneider
913/689-7571

NOON Lv. Colonial Inn for Airport

DRIVER: Janene Schneider

12:10 p.m. Lv. Phillipsburg for Hill City

AIRCRAFT: Cessna 414 Chancellor
TAIL NO.: 12436
SEATS: 5
PILOT: Mitchell Mosiman
CO-PILOT: Dennis Richmeier
FLIGHT TIME: 20 mins.

MANIFEST: Senator Dole
Dave Spears

12:30 p.m. Ar. Hill City Municipal Airport
Airport Manager - 913/674-2611 or 2703

MET BY: Jordan White

Drive time to Nicodemus - 15-20 mins.

12:45 p.m. Ar. Nicodemus

MET BY: Angela Bates
Nicodemus Historical Society

1:00 p.m.
to
2:00 p.m.

NICODEMUS - Emancipation Celebration ceremony

PROGRAM AS FOLLOWS:

**They will adjust the program in any way
necessary to accommodate Senator Dole's
schedule.

SPEAKERS:

Bob DeForrest, President, Afro-American
Institute for Historic Preservation and
Community Development.

John Townsend, Aid to Mayor of Lexington,
Kentucky.

Herb Cables, Deputy Director, National Park
Service.

Sandra Washington, Dept. of Interior, Omaha,
Nebraska - Project Director - Nicodemus Site
Feasibility Study.

Senator Bob Dole

Following the speeches, William McIntyre,
Kentucky photographer and historian, will
do a slide presentation and history, "From
Whence We Came".

ATTENDANCE: 800-1000

CONTACT: Angela Bates - 913/674-3311

2:10 p.m.

Lv. Nicodemus for Hill City

DRIVER: Jordan White

DRIVE TIME: 15-20 Mins.

2:30 p.m. Lv. Hill City for Winfield
AIRCRAFT: Cessna 414 Chancellor
TAIL NO.: 12436
SEATS: 5
PILOT: Mitchell Mosiman
CO-PILOT: Dennis Richmeier
FLIGHT TIME: 1 hr. 8 mins.
MANIFEST: Senator Dole
Dave Spears

3:40 p.m. Ar. Strother Field
Current Aircraft - 316/221-4107
MET BY: Norm Payne
316/221-3524
DRIVE TIME: 10-15 mins.

3:55 p.m. WINFIELD - COWLEY COUNTY FAIR
to
4:45 p.m. CONTACT: Cowley County Extension Office
316/221-4066, Ext. 316

4:45 p.m. Lv. Fairgrounds for Strother Field
DRIVER: Norm Payne
316/221-3524
DRIVE TIME: 10-15 mins.

5:00 p.m. Lv. Strother Field for Newton
AIRCRAFT: Cessna 414 Chancellor
TAIL NO.: 12436
SEATS: 5
PILOT: Mitchell Mosiman
CO-PILOT: Dennis Richmeier
FLIGHT TIME: 27 Mins.
MANIFEST: Senator Dole
Dave Spears

5:30 p.m. Arrive Newton Airport
MET BY: Jim Gillmore, GOP Chr.
316/283-1550 or 1553 (o)
316/799-2829 (h)

**Both the Dole Co-Chairs, Joe Robb and
Rosalind Scudder, will be out of town
this weekend, as will Mike and Judy
Sizemore.

DRIVE TIME: 10 mins.

5:40 p.m. Arrive Parade Area

6:00 p.m. HARVEY COUNTY FAIR PARADE
to
6:30 p.m.

6:30 p.m. Lv. Parade Route for Airport
DRIVER: Jim Gillmore, GOP Chr.
DRIVE TIME: 10 mins.

6:40 p.m. Lv. Newton for Wichita
AIRCRAFT: Cessna 414 Chancellor
TAIL NO.: 12436
SEATS: 5
PILOT: Mitchell Mosiman
CO-PILOT: Dennis Richmeier
FLIGHT TIME: 18 mins.

MANIFEST: Senator Dole
Dave Spears

7:00 p.m. Ar. Wichita - Jabara Airport
Midwest Corporate Aviation - 316/636-9700

7:05 p.m.

Lv. Wichita for Washington

AIRCRAFT: ConAgra Learjet
TAIL NO.: N 825 CA
PILOT:
CO-PILOT:
FLIGHT TIME: 2 hrs. 30 mins.

CONTACT: Paul Karody
202/223-5115

MANIFEST: Senator Dole

10:35 p.m.

Ar. Washington National
MET BY: WILBERT

ADM

ADM SUBSIDIARY LOCATION IN KANSAS

COLLINGWOOD LOCATIONS

1. Big Bow
2. Collins
3. Conway
4. Copeland
5. Country Station
6. Dodge City
7. Greensburg
8. Jetmore
9. Nowington
10. Hugoton
11. Hutchinson
12. Johnson
13. Kingman
14. Lakin
15. Leoti
16. Little River
17. Lyons
18. Manter
19. Marquette
20. Mitchell
21. Montezuma
22. Moscow
23. Plains
24. Pretty Prairie
25. Ryan
26. Selkirk
27. Shallow Water
28. Sublette
29. Vagner
30. Kinsley

SMOOT LOCATIONS

1. Asherville
2. Simpson
3. Brewster
4. Brownell
5. Canton
6. Roxbury
7. Grainfield
8. Goodland
9. K.C./Wolcott
10. Kanorado
11. Longford
12. McCracken
13. Minneapolis
14. Oakley
15. Falco
16. Park
17. Salina
18. Topeka
19. Monument

40 - Country elevators in Kansas

- 1 - Soya Bean Plant - Fredonia, Kansas
- 1 - Dog Food Plant - Bern, Kansas
- 5 - Flour Mills -
 - Arkansas City, Kansas (2)
 - Buhler, Kansas
 - Inman, Kansas
 - Salina, Kansas
- 1 - Milo Mill - Dodge City, Kansas
- 1 - Bulger Mill - Abilene, Kansas

TOTAL P.02

Conagra

≠ 3,000 employees

CONAGRA OPERATIONS LOCATED WITHIN THE STATE OF KANSAS

CITY	STATE FUNCTION	BUSINESS
ATCHISON	KS CORN MILLING/GRAIN MERCH	GRAIN PROCESSING
BELLEVILLE	KS WHEELERS STORES	RETAIL COS (CG/NWF)
CONCORDIA	KS SALES/WHSE	UNITED AGRI PRODUCTS
GARDEN CITY	KS BEEF PLANT	MONFORT/BEEF/PRK/LAM
GARDEN CITY	KS ADMIN CENTER	UNITED AGRI PRODUCTS
GARDEN CITY	KS SALES/WHSE	UNITED AGRI PRODUCTS
GODDARD	KS SALES/WHSE	UNITED AGRI PRODUCTS
GOODLAND	KS SALES/WHSE	UNITED AGRI PRODUCTS
HARPER	KS LAMB PLANT	MONFORT/BEEF/PRK/LAM
HOLTON	KS SOW SLAUGHTER PLANT	ARMOUR/SWIFT-ECKRICH
KANSAS CITY	KS PLANT	ARMOUR/SWIFT-ECKRICH
LAWRENCE	KS N.W. FABRICS & CRAFTS	RETAIL COS (CG/NWF)
LENEXA	KS ASE SALES OFFICE	ARMOUR/SWIFT-ECKRICH
MARYSVILLE	KS WHEELERS STORES	RETAIL COS (CG/NWF)
MERRIAM	KS N.W. FABRICS & CRAFTS	RETAIL COS (CG/NWF)
NICKERSON	KS FERTILIZER TERMINAL	CONAGRA FERTILIZER
NORTON	KS WHEELERS STORES	RETAIL COS (CG/NWF)
OLATHE	KS N.W. FABRICS & CRAFTS	RETAIL COS (CG/NWF)
OVERLAND PARK	KS KANSAS CTY DIST FDSVC SLS	HUNT-WESSON

CONAGRA OPERATIONS LOCATED WITHIN THE STATE OF KANSAS

CITY	STATE FUNCTION	BUSINESS
OVERLAND PARK	KS MIDWEST DIV FDSVC SALES	HUNT-WESSON
SMITH CENTER	KS WHEELERS STORES	RETAIL COS (CG/NWF)

Bob Dole



NEWS

U. S. SENATOR FOR KANSAS

FROM:

SENATE REPUBLICAN LEADER

FOR IMMEDIATE RELEASE
July 31, 1992

CONTACT: WALT RIKER
(202) 224-5358

**DOLE ANNOUNCES COMMITTEE APPROVAL TO FUND
KANSAS PROJECTS LOCATED IN LEAVENWORTH,
HUTCHINSON, WICHITA, TOPEKA, OLATHE,
UNIVERSITY OF KANSAS, LAWRENCE**

WASHINGTON - Kansas Senator Bob Dole announced today that a Senate committee has approved funding for several key Kansas projects, including construction of the Leavenworth VA domiciliary, science enrichment at the Hutchinson Cosmosphere, infrastructure improvements for Planeview in Wichita, a new law enforcement facility in Topeka, a drug treatment center in Olathe and a pollution research project at the University of Kansas.

"I'm pleased that the committee has agreed with me to support these important Kansas initiatives," said Dole.

The Senate Appropriations Committee today included the Dole-backed Kansas projects during approval of the FY1993 Veterans Administration, Housing and Urban Development, and Independent Agencies Appropriations bill. The measure now goes to the full Senate.

LEAVENWORTH VA DOMICILIARY - \$28.725 MILLION

The committee approved President Bush's request of \$28.725 million for construction of a new domiciliary at the Veteran's Administration facility. The project would consolidate Veterans Administration services, improve access to services, and increase long-term nursing care facilities for more than 119,000 in-patients and out-patients. The design phase is close to completion.

"This is a significant step towards making these much needed improvements a reality," said Dole. "Expanding the quality medical services our veterans have earned is a priority, and upon completion, this new facility will serve thousands who have served America," said Dole.

PLANEVIEW IMPROVEMENT PROJECT, WICHITA - \$1.2 MILLION

\$1.2 million was approved by the committee for major infrastructure improvements in Planeview, a low income area in Wichita. The project includes replacing water mains and service lines, replacing sidewalks, streets and curbs and routine maintenance of the area. - more -

- 2 -

"I'm pleased that the committee has agreed to include this vital funding to significantly upgrade the infrastructure in the Planeview area," said Dole.

HUTCHINSON COSMOSPHERE, HUTCHINSON - \$2 MILLION

The committee approved \$2 million to expand the capacity for science enrichment workshops, teacher in-service training, seminars, and lectures at the Cosmosphere.

"Hutchinson's Cosmosphere is one of the Heartland's great learning centers. Each year, the Cosmosphere holds informative seminars and training workshops for more than 50,000 students and teachers. Upon final approval, this funding will enhance this outstanding educational resource," said Dole.

NEW LAW ENFORCEMENT FACILITY, TOPEKA - \$1 MILLION

The committee approved \$1 million to assist with purchasing an abandoned Montgomery Ward department store and renovating it into a law enforcement facility. Total estimated cost of the project is \$6 million - \$2.3 million to purchase the property and \$3.7 for renovation.

"By renovating an already existing building, this project will serve as an efficient way to upgrade Topeka's law enforcement facilities," said Dole.

CYPRESS DRUG AND ALCOHOL RECOVERY PROGRAM, OLATHE - \$250,000

The committee approved \$250,000 for the Olathe Cypress Drug and Alcohol Recovery Program to continue counseling services.

"I'm pleased the committee has approved funding to help this vital counseling facility continue its important services," said Dole.

UNIVERSITY OF KANSAS ENVIRONMENT NONPOINT SOURCE POLLUTION PROJECT, LAWRENCE - \$1.45 MILLION

The committee approved \$1.45 million for third-year funding of the nonpoint source pollution project located at KU and jointly researched with Iowa State University and the University of Nebraska at Lincoln.

"This project is helping us determine ways of limiting water pollution by monitoring streams and other water resources. The results of this study will be an integral part of a large scale EPA study of nonpoint source pollution in the Midwest," said Dole.

###

Bob Dole

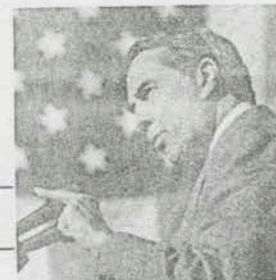

NEWS

U. S. SENATOR FOR KANSAS

FROM:

SENATE REPUBLICAN LEADER

FOR IMMEDIATE RELEASE
July 31, 1992

CONTACT: WALT RIKER
(202) 224-5358

SENATE APPROVES DOLE INITIATIVE TO FUND PLANS FOR NEW
ENERGY RESEARCH CENTER AT THE UNIVERSITY OF KANSAS

WASHINGTON - Kansas Senator Bob Dole announced today the U.S. Senate has agreed to include a Dole amendment to provide \$50,000 for planning and design of a new University of Kansas Energy Research and Technology Transfer Center. The center would serve as a site for geological and engineering research, developing technology to recover the remaining oil, gas and coal bed methane in Kansas fields.

Dole's amendment was included during Senate consideration of the FY1993 Energy and Water Appropriations bill. The measure is expected to pass the Senate next week and will then go to a joint House/Senate conference committee before final passage by both houses.

"The remaining oil, gas and coal bed methane in Kansas fields and throughout the midcontinent region can be an important source of domestic energy production. But we need to establish a cost-efficient technology for successful recovery," said Dole. "That's why this research center, centrally located at KU, could become an important resource to promote energy self-sufficiency," said Dole.

The University of Kansas estimates \$7 million for the cost of a research center.

###

WICHITA BUS

Bob Dole



NEWS

U. S. SENATOR FOR KANSAS

FROM:

SENATE REPUBLICAN LEADER

FOR IMMEDIATE RELEASE
July 30, 1992

CONTACT: WALT RIKER
(202) 224-5358

SENATE COMMITTEE APPROVES FUNDING FOR NEW BUS GARAGE IN WICHITA

WASHINGTON - Kansas Senator Bob Dole announced today that a Senate committee has approved funding for the construction of a bus garage/maintenance facility for the city of Wichita. The project, requested by Senator Dole and the City of Wichita, would provide \$4 million to construct a new garage and maintenance facility near the new Transit Center in downtown Wichita.

The funding is included in the 1993 Transportation Appropriations bill approved today by the Senate Appropriations Committee. The measure now goes to the full Senate.

The new facility would replace the current uncovered bus storage lot, which is a considerable distance from the new Transit Center.

"I'm pleased this project has received committee approval. In less than a year, the Wichita Metropolitan Transit Authority will be operating its bus system from a new downtown Transit Center, and this new storage and maintenance facility will help make the MTA and its new transit center more efficient for the people of Wichita," said Dole.

###

INTERIOR

Bob Dole



NEWS

U. S. SENATOR FOR KANSAS

FROM:

SENATE REPUBLICAN LEADER

FOR IMMEDIATE RELEASE
July 29, 1992

CONTACT: WALT RIKER
(202) 224-5358

DOLE ANNOUNCES SENATE COMMITTEE APPROVAL FOR KANSAS PROJECTS;
WICHITA ENVIRONMENTAL CENTER, HASKELL INDIAN JUNIOR COLLEGE,
SANTA FE TRAIL, NATIONAL WATERFOWL MANAGEMENT PLAN, ABANDONED
MINE PROGRAM, AND TOPEKA'S MONROE SCHOOL HISTORIC SITE INITIATIVE

WASHINGTON - Kansas Senator Bob Dole announced today Senate Committee approval to fund several Kansas projects including Haskell Indian Junior College in Lawrence, the Environmental Education Center in Wichita and the Santa Fe Trail. The committee also approved funding for the North American Waterfowl Management Plan, which includes several Kansas projects, and the Rural Abandoned Mine Program, a program which was recently initiated in Kansas.

"I'm pleased the committee has agreed to fund these priority initiatives," Dole said. "Upon final approval, these funds will contribute to the preservation of our state's tremendous wildlife, wetland and historic resources, and boost our homestate education. I'm also pleased that the committee approved much needed funding to reclaim abandoned mines and promote safety."

The funding is included in the 1993 Interior Appropriations bill which was approved today by the Senate Appropriations Committee. The measure now goes to the full Senate.

Dole-backed projects in the funding measure include:

HASKELL INDIAN JUNIOR COLLEGE, LAWRENCE - \$4.746 MILLION

The committee approved \$3 million for phase two of a dormitory expansion project. \$1.746 million was also included for the college's operating budget.

ENVIRONMENTAL EDUCATION CENTER, WICHITA - \$4 MILLION

The committee approved \$4 million for construction of the center. The land has already been purchased. Funding for planning and design of the center was included by Senator Dole in last year's bill.

- MORE -

- 2 -

SANTA FE TRAIL -- \$150,000

The committee included \$150,000 to develop the Santa Fe Trail in Kansas. The funding would be used to hire additional personnel, to certify sites as well as to build displays and parking at historic sites along the trail.

NORTH AMERICAN WATERFOWL MANAGEMENT PLAN

The committee approved \$11 million for President Bush's management plan for this nationwide conservation program which includes wetlands restoration projects throughout the country. Kansas has applied for \$1.18 million to fund conservation programs for several sites including McPherson wetlands, the playa lakes, and Cheyenne Bottoms.

RURAL ABANDONED MINE PROGRAM (RAMP)

The committee included \$15 million for the national Rural Abandoned Mine Program, run by the Soil Conservation Service. Earlier this year, the Soil Conservation Service committed funding to establish a Kansas program.

BROWN V. BROWN BOARD OF EDUCATION, TOPEKA

At Senators Dole's request, language was included to instruct the National Park Service to fund a general management plan for establishing the Monroe School as a National Historic site. The study will begin as soon as a bill establishing the Monroe school as a National Historic Site is signed into law.

###

KANAPOLIS

Bob Dole



NEWS

U. S. SENATOR FOR KANSAS

FROM:

SENATE REPUBLICAN LEADER

FOR IMMEDIATE RELEASE
July 23, 1992

CONTACT: WALT RIKER
(202) 224-5358

DOLE ANNOUNCES COMMITTEE APPROVAL OF FUNDING FOR KANOPOLIS
LAKE STUDY; TO SEEK WAYS TO MEET SALINA'S WATER DEMANDS

WASHINGTON - Kansas Senator Bob Dole announced today that a Senate committee has approved \$250,000 he requested to fund a study of raising the pool at Kanopolis Lake to develop additional water supply storage for the city of Salina. The study would be undertaken by the U.S. Army Corps of Engineers.

"The search for safe and reliable sources of water has become a never-ending struggle for many Kansas communities. The city of Salina is seeking ways to increase its water supply and is considering Kanopolis Lake as a potential site for development to meet the city's increasing demands. So I join with the city of Salina in supporting this study, which will examine the environmental and technical feasibility of this important initiative," said Dole.

Some issues the study would research include the capability of the dam to support additional water, the problem of sedimentation, the quality of water in the lake and the question of whether there are adequate inflows to support a higher pool level.

The Senate Appropriations Committee today approved the funding which is part of the FY1993 Energy and Water Appropriations bill. The measure now goes to the full Senate.

###

COURTLAND CANAL

Bob Dole



NEWS

U. S. SENATOR FOR KANSAS

FROM:

SENATE REPUBLICAN LEADER

FOR IMMEDIATE RELEASE
JULY 23, 1992

CONTACT: WALT RIKER
(202) 224-5358

DOLE ANNOUNCES COMMITTEE APPROVAL OF \$1.1 MILLION
FOR COURTLAND CANAL PROJECT; NEXT STEP FULL SENATE APPROVAL

WASHINGTON - Kansas Senator Bob Dole today announced Senate committee approval of \$1.1 million for the Bureau of Reclamation's Courtland Canal lining project. The funding was approved today by the Senate Appropriations Committee during consideration of the FY1993 Energy and Water Appropriations bill. The measure now goes to the full Senate.

"Senator Kassebaum and I feel that this project is a vital source of water for the farmers in the area. Although this canal is located in Nebraska, over half of the water is used by Kansas irrigators. Farmers in both states are strong supporters of the project - Kansas farmers because more water would be available for irrigation and Nebraska farmers because it would eliminate seepage into their fields," Dole said.

The funding would be used to complete the specifications and to award Phase 2 of the Courtland Canal membrane lining construct.

###

FMHA LOANS

Bob Dole



NEWS

U.S. SENATOR FOR KANSAS

FROM:

SENATE REPUBLICAN LEADER

FOR IMMEDIATE RELEASE
July 29, 1992

CONTACT: WALT RIKER
(202) 224-5358

DOLE ANNOUNCES USDA EMERGENCY LOANS FOR 27 KANSAS COUNTIES;
LOW-INTEREST LOANS FOR ELIGIBLE FARMERS HIT BY SEVERE WEATHER

WASHINGTON - Kansas Senator Bob Dole announced today that farmers in 27 Kansas counties who sustained losses resulting from severe spring and summer storms may be eligible for low-interest disaster emergency loans from the Farmers Home Administration.

"Many farmers in these counties may need assistance due to the recent severe weather, so I'm pleased that Farmers Home has expanded its commitment to lend a helping hand," Dole said.

Today's announcement brings to 27 the total number of counties in which farmers may be eligible for disaster emergency loans, and includes several counties named yesterday as eligible for FmHA assistance as a result recent severe weather.

The 27 counties designated are: Barton, Butler, Chautauqua, Clay, Cloud, Cowley, Dickinson, Elk, Ellsworth, Harper, Harvey, Jewell, Kingman, Lincoln, Marion, McPherson, Mitchell, Osborne, Ottawa, Reno, Republic, Rice, Russell, Sedgwick, Sumner, Saline and Washington.

Farmers in all 27 counties have eight months to apply for the loans from the U.S. Department of Agriculture.

###

AG - KSU

Bob Dole



NEWS

U.S. SENATOR FOR KANSAS

FROM:

SENATE REPUBLICAN LEADER

FOR IMMEDIATE RELEASE
July 29, 1992

CONTACT: WALT RIKER
(202) 224-5358

**DOLE ANNOUNCES U.S. SENATE APPROVAL OF AGRICULTURE
FUNDING MEASURE:
FUNDING FOR KSU'S THROCKMORTON AND AGRICULTURE RESEARCH PROJECTS;
INCLUDES EXPANSION OF VIDEO HEALTH CARE LINKUP BETWEEN KU MED
CENTERS AND HAYS HEALTH CENTER**

WASHINGTON - Kansas Senator Bob Dole announced today that the U.S. Senate late Tuesday night approved legislation to fund several major Kansas projects, including Throckmorton Plant Science Research Center and several research projects at Kansas State University. At the request of Senator Dole, the bill also includes language for a rural development grant to expand a video linkup system between KU Med Centers and the Area Health Education Center in Hays.

The Kansas projects are included in the 1993 Agriculture Appropriations bill, which now goes to a joint House/Senate conference committee before final approval by both houses.

"I'm pleased the full Senate has agreed to support these priority agriculture research projects. Kansas State University continues to excel with its outstanding research facilities, and its commitment to lead American agricultural research into the 21st century," said Dole.

"Throckmorton is a state-of-the-art agriculture research center that is becoming an excellent national resource," added Dole.

UNIVERSITY OF KANSAS RURAL DEVELOPMENT HEALTH CARE INITIATIVE

The Agriculture funding bill includes Senator Dole's language to expand a pilot project by the University of Kansas that uses two-way interactive video to link University of Kansas Medical Centers in Kansas City and Wichita with the Area Health Education Center in Hays. The system is designed to enable specialists from the med centers to see patients in western Kansas simultaneously. Dole's language would expand the system by adding three to five small communities in western Kansas.

"One of the biggest problems facing rural communities is a shortage of health care professionals. This program can be an innovative way to help bring necessary care and attention to those living in Western Kansas," said Dole.

(more)

THROCKMORTON PLANT SCIENCE RESEARCH CENTER, K-STATE - \$1.57 MILLION

\$1,570,000 for the federal government's share in construction of office and laboratory facilities. KSU needs \$1 million to complete funding for the building.

Kansas State University research projects approved by the Senate include:

FOOD SAFETY PROGRAM - \$1.942 MILLION

\$1.942 million for a project that researches food safety, particularly developing techniques to assist the meat industry in assuring a safe meat supply. Kansas State University joins the University of Arkansas and Iowa State University in this project.

WHEAT GENETICS RESOURCE CENTER - \$159,000

\$159,000 for Kansas State University-based Wheat Genetics Resource Center. The center focuses on national and international wheat improvement programs.

ALFALFA - \$125,000

\$125,000 for an alfalfa research program at KSU. The program is developing new alfalfa varieties and improving the disease and insect resistance of existing varieties. It also services as a technical source of information for alfalfa producers.

GREAT PLAINS AGRICULTURE POLICY RESEARCH CENTER - \$100,000

\$100,000 to Kansas State University and Oklahoma State University to develop agriculture information programs for statewide use. The program will analyze and project the impact of alternative agriculture plans and policies for the Great Plains region.

CANOLA - \$100,000

\$100,000 for Kansas State University to develop new varieties of canola suitable for growing in Kansas. The first series of planting will occur this fall.

WATER CONSERVATION RESEARCH - \$94,000

\$94,000 for first-year funding to research water conservation techniques at Kansas State University. The program will examine efficiency in water usage and management. KSU will also research crop management.

###

Bob Dole



NEWS

U.S. SENATOR FOR KANSAS

FROM:

SENATE REPUBLICAN LEADER

FOR IMMEDIATE RELEASE
JULY 23, 1992

CONTACT: WALT RIKER
(202) 224-5358

NEXRAD TORNADO RADAR

NEXRAD RADAR FUNDING GAINS SENATE COMMITTEE APPROVAL; SEVERE WEATHER DETECTING SYSTEM SLATED FOR DODGE CITY - WICHITA - GOODLAND - TOPEKA

WASHINGTON - Kansas Senator Bob Dole announced today that funding to complete Kansas installation of the NEXRAD Doppler radar, the high-tech severe weather detection radar, has cleared a major hurdle in the Senate. The Senate Appropriations Committee today, at the request of Senator Dole, approved funding as part of the National Weather Service's modernization program. Four Kansas cities - Dodge City, Wichita, Goodland and Topeka - are slated to receive the radar.

"When it comes to early and accurate warning of fierce weather, be it tornados, hailstorms, blizzards, droughts or floods, every second counts. That's what makes this next generation of high-tech warning equipment so vital to Kansas," said Dole. "1991 was a record year for tornadoes in Kansas with 116 reported last year, so I'm pleased that once this critical program is completed, Kansas will be the first state in the nation with complete Doppler coverage," said Dole.

Last year, Senator Dole secured initial funding to begin the process of installing 4 NEXRAD radars in Kansas.

The National Weather Service has slated 4 Kansas sites to receive the advanced NEXRAD system. Dodge City had the system installed in December, 1991, where it is currently being tested. It will be permanently operationally in February, 1993.

The National Weather Service approximates the target dates for the systems for Wichita, Goodland, and Topeka as follows:

Wichita - delivery date - August, 1992
in use by October, 1992
permanently installed May, 1993

Goodland - delivery date - September, 1992
in use by November, 1992
permanently installed June, 1993

Topeka - delivery date - April, 1993
in use by June, 1993
permanently installed January, 1994

The committee, at the request of Senator Dole, approved the funding as part of the FY1993 Commerce, State and Justice Appropriations bill. The measure now goes to the full Senate for approval.

###

Bob Dole



NEWS

U. S. SENATOR FOR KANSAS

FROM:

SENATE REPUBLICAN LEADER

FOR IMMEDIATE RELEASE
JULY 28, 1992

CONTACT: WALT RIKER
(202) 224-5358

DOLE SECURES SENATE APPROVAL OF \$400,000 AID
FOR STORM-DAMAGED NCK ELECTRIC COOPERATIVE:
FmHA MAKES DISASTER DECLARATION FOR CLOUD, MITCHELL &
7 CONTIGUOUS COUNTIES -- LOW INTEREST LOANS FOR ELIGIBLE FARMERS

WASHINGTON -- Responding to the destruction caused by hurricane-force winds and heavy rains that hit north central Kansas on July 8, Kansas Senator Bob Dole today secured Senate approval of a special \$400,000 grant earmarked for the NCK Electric Cooperative, which services users throughout north central Kansas. The cooperative experienced significant losses when the storms, classified as an "inland hurricane," knocked out power lines and destroyed approximately 500 electric poles.

The southern one-third of the electric system was destroyed in the storm. Because insurance is unavailable for the type of equipment that was destroyed, ratepayers would be exposed to heavy additional increases in order to pay for the storm damage.

"The people of north central Kansas and the NCK Electric Cooperative need some relief in order to tackle the enormous recovery they have before them," Dole said. "This assistance, if also approved by the House, will provide assistance to the cooperative and allow many victims of the storm to move on to other projects."

The grant was included as part of the 1993 Agriculture Appropriations bill, and must be approved by a House/Senate conference committee in coming weeks.

Disaster Declaration: FmHA meeting at Cloud County Courthouse

Additionally, Dole's office announced that the Farmers Home Administration has declared the following counties as disaster counties for physical loss designation: Cloud, Mitchell and the contiguous counties of Washington, Clay, Ottawa, Lincoln, Osborne, Jewell and Republic. Under such a designation, eligible farmers will have access to low-interest loans to pay for losses and repair damages sustained by the storms. A meeting will be held on Wednesday, July 29, at 1:30 P.M. in the Cloud County Courthouse, where state FmHA officials will be available to explain programs available under the disaster designation and to answer any questions that attendees may have.

###

5

12:45 p.m.

Ar. Nicodemus

MET BY: Angela Bates
Nicodemus Historical Society

1:00 p.m.

to

2:00 p.m.

NICODEMUS - Emancipation Celebration ceremony

PROGRAM AS FOLLOWS:

**They will adjust the program in any way
necessary to accommodate Senator Dole's
schedule.

SPEAKERS:

Bob DeForrest, President, Afro-American
Institute for Historic Preservation and
Community Development.

John Townsend, Aid to Mayor of Lexington,
Kentucky.

Herb Cables, Deputy Director, National Park
Service.

Sandra Washington, Dept. of Interior, Omaha,
Nebraska - Project Director - Nicodemus Site
Feasibility Study.

Senator Bob Dole

Following the speeches, William McIntyre,
Kentucky photographer and historian, will
do a slide presentation and history, "From
Whence We Came".

ATTENDANCE: 800-1000

CONTACT: Angela Bates - 913/674-3311

2:10 p.m.

Lv. Nicodemus for Hill City

DRIVER: Jordan White

**SENATOR BOB DOLE
NICODEMUS CELEBRATION
JULY 1, 1992**

**THANK YOU. IT'S A REAL
PRIVILEGE TO JOIN IN THIS
HOMECOMING CELEBRATION.**

**I'M NOT GOING TO TAKE
MUCH OF YOUR TIME, BECAUSE
TODAY IS NOT A DAY FOR
SPEECHES. IT'S A DAY FOR**

**FAMILY...A DAY FOR FRIENDS...A
DAY FOR PICNICS...A DAY FOR
REMEMBERING THE COURAGE
AND HARD WORK OF THOSE
WHO CAME BEFORE US.**

**I DO WANT TO OFFER A
SPECIAL SALUTE TODAY TO
ANGELA BATES. IT IS ONLY
THROUGH ANGELA'S HARD
WORK AND PERSISTENCE THAT**

**WE HAVE COME THIS FAR TO
GAIN THE PROPER
RECOGNITION FOR THIS
HISTORIC TOWN.**

**NO DOUBT ABOUT IT--IF WE
HAD A FEW MORE SENATOR'S
WITH ANGELA'S COMMITMENT
TO GET THE JOB DONE, WE
MIGHT EVEN BE ABLE TO
BALANCE THE BUDGET.**

**PLEASE JOIN ME IN GIVING
HER A WELL-DESERVED ROUND
OF APPLAUSE.**

**AS YOU KNOW, THE STUDY
FOR WHICH ANGELA FOUGHT SO
HARD IS EXPECTED TO BE
COMPLETED THIS FALL, AND I
LOOK FORWARD TO WORKING
WITH ANGELA AND ALL OF YOU
TO DO WHAT IS RIGHT.**

**AND IN MY BOOK, WHAT'S
RIGHT IS ENSURING THAT
KANSAS PRESERVES HER
PAST...AND THAT FUTURE
GENERATIONS WILL HAVE AN
ACCURATE HISTORICAL
ACCOUNT OF THE BRAVE
AMERICANS WHO ONCE CALLED
NICODEMUS "HOME."**

**WELCOME HOME AND GOOD
LUCK.**

19th ANNUAL SHRINE BOWL BANQUET

Ramada Inn Convention Center, Topeka
July 31, 1992 6:00 P.M.

Special Opening Performance of the Kansas Masonic All-State Band
Directed by Kurt Saville, Band Director, Washburn University

Master of Ceremonies Mitch Holthaus

Invocation Chris Diller

Dinner

Sunflower Salad

Mom's Best Meatloaf

Aunt Kimberly's Healthy Vegies

Gramma's Mashed Potatoes

*Aunt Janette's Corn Muffins
and Corn Bread*

Dave's Deluxe All-American Apple Pie

A Player's Perspective Jason Brown

A Band Member's Perspective

Introductions

'92 Head Coaches Rick Clark (east), Dave Meadows (west)

Special Address and Introduction Bill Graves, Secretary of State

Featured Keynote Speaker Bob Dole, U.S. Senator

Remarks by Imperial Potentate Everett M. Evans
Sharon Temple, Tyler, Texas

Shriners Help Kids

P. 2

SHRINE BOWL OF KANSAS

OFFICERS & DIRECTORS

LeWayne Premier, P.P., President.....	Isis
Frank Coffman, P.P., 1st Vice President.....	Arab
Bill Hinebaugh, 2nd Vice President.....	Midian
Jim Bowen, Treasurer.....	Mirza
Glenn Hamilton, P.P., Secretary.....	Abdallah
Thaine Francis.....	Isis
Dr. David Sager.....	Isis
Bill Duckworth, P.P.....	Arab
Frank Seufert.....	Arab
Glenn "Rusty" Jones.....	Midian
Billy Moore.....	Midian
Don Badders, P.P.....	Mirza
Earl Dosstier.....	Mirza
Bill Hammer.....	Abdallah
Jack Potter.....	Abdallah

Executive Director - Dave Mize

PAST PRESIDENTS

1974—Charlie Clampett, P.P.....	Midian
1975—Ralph Taylor, P.P.....	Mirza
1976—Charles F. Berg.....	Abdallah
1977—Lad Fiser.....	Isis
1978—N. Martin Foltz, P.P.....	Arab
1979—Jim McNerney, P.P.....	Midian
1980—Glen Hastings.....	Mirza
1981—Jack Denton, P.P.....	Abdallah
1982—Charles McCrann.....	Isis
1983—Bob Briggs.....	Arab
1984—Herb Cohlma.....	Midian
1985—William Shote, P.P.....	Mirza
1986—William Bockner, P.P.....	Abdallah
1987—Sam Mays, P.P.....	Isis
1988—Bill Duckworth, P.P.....	Arab
1989—Bill Elliott.....	Midian
1990—Dr. Earle Binford.....	Mirza
1991—Jim Bratton.....	Abdallah

TOP SALESMEN

<u>Abdallah</u>	<u>Arab</u>	<u>Isis</u>	<u>Midian</u>	<u>Mirza</u>
Leaford Savage	Ralph Newman	Larry Jantz	Merwin Frye	George Lawson
Emory Scott	Lester Paul	Leonard Zeibow	Gene Mudd	Jim Bowen
Frank Rice	Larry Leathers	Leonard Parks	Dune Gates	Perry Egan

15:13 RAMADA INN TOPEKA/KSH

EAST SQUAD
1992 SHRINE BOWL GAME

WEST SQUAD
1992 SHRINE BOWL GAME

Audy Babcock.....	Cherokee	John Babb.....	Goddard
Alumn Bailey.....	Harmon	Byron Bachman.....	Derby
Brendan Benzke.....	Warrego	Kris Barber.....	Garden City
Jason Brown.....	Blue Valley, Silivell	Justin Brant.....	North
Justin Bechtley.....	Cherokee	Chris Brown.....	Liberal
Rean Caryl.....	Topoka	Chad Davis.....	Ellsworth
Michael Casey.....	Lawrence	Richard DeLaRosa.....	Garden City
Mike Drklein.....	Olathe South	Chris Diller.....	Andover
Just Ferype.....	Lawrence, Lawrence	Keith Eck.....	Andale
Fred Gee.....	Atwell	Chad Fuller.....	Wellington
Robert Gooden.....	Topoka West	Jeff Greene.....	Manhattan
Bob Goltra.....	Fort Scott	Chad Hayes.....	Atwood
Adnan Green.....	Lawrence	Eric Handrick.....	Derby
John Hopp.....	Sabetha	Rich Holbrook.....	Neosho
Mike John.....	Pittsburg	Ann Johnson.....	Wichita South
Chris Jones.....	Parsons	Chris Jones.....	Newton
Carlos Kelly.....	Highland Park	Maddison's Koradi.....	Newton
Aaron Leesch.....	Highland	Darwin Korbak.....	Ingalis
Tom Malukewicz.....	Silver Lake	Lynn Langrath.....	Chaguan
B.J. McGovern.....	Hayden, Topoka	Cory Maynor.....	Wichita Northwest
Audy Murray.....	Blue Valley, Silivell	Scott McKim.....	EllDorado
Junior Neal.....	Birreton	Chad Merkle.....	Abbots
Keith Rodgers.....	Shawnee Mission NW	Jim Moore.....	Garden City
Joe Sanders.....	Shawnee Mission South	Chad McKegan.....	EllDorado
Brian Schotzenbeider.....	Blue Valley	Clint Newell.....	Hayes
Mihai Sharon.....	Warren	Brian Phelps.....	Liberal
Don Sibert.....	Olathe North	Darrel Schmidt.....	Plainville
Aaron Slig.....	Yates Center	Duane Sees.....	Sedon
Janet Smith.....	Pittsburg	Scott Smedema.....	Plainville
Eric Sutlorich.....	Ward, Kansas City	Curis Turner.....	Scott Community
Don Taggart.....	Olathe North	Chris Warren.....	Belle Plaine
Robert Trujillo.....	Bardonia	John Wheeler.....	Marion-Florence
Luke Yarnell.....	Wesbourn Rural	Myke Wynn.....	Wichita Northwest

COACHES:

Rick Clark (Head).....Spring Hill
 Ron Bowen.....Wesbourn Rural
 Lindell Frasz.....Fort Scott
 Dennis Dorr.....Ward, Kansas City
 Mark Lueckle.....Boersville
 Mike Ream.....Highland

COACHES:

Dave Anderson (Head).....Garden City
 Don Davis.....Wichita Northwest
 Gary Cornelien.....Liberal
 Mark Tompkin.....Andover
 Tom Smith.....Plainville
 Alan Mendaki.....Moronohidge

TRAINERS:

Mike Flynn & Kevin Harrison.....Topoka
 Matthew Schick.....Royal Valley
 Lenny Martens.....Paola
 Tom Leathers.....Warrego

TRAINERS:

Kurt Schmidt (Head).....Pl. Hwy's State
 Kelly Wright.....Latin
 Tracy Peterson.....Smith Center
 David Yabon.....Pl. Hwy's

Nineteenth Annual

SHRINE BOWL OF KANSAS, INC.
FOOTBALL PLAYER

APPRECIATION

BANQUET

Picnic In The Park
"An Election Year Banquet"

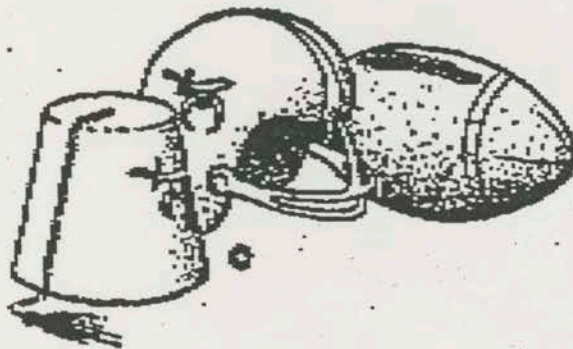

Special Thanks To Our Banquet Sponsors

Kansas Corn Growers Association; Mid-America Dairy & Mid-America Farms Sport Shake; National Beef Packing Co. & National Carriers; EMI, Inc. & Ramada Inn, Topeka; Dorothy's Land of Ahs & Paxico Brand Barbeque Sauce; Morton Salt; Louisburg Cider Mill, Dyer's IGA, and Fleming Foods

TOPEKA, KANSAS
RAMADA INN CONVENTION CENTER
FRIDAY, JULY 31, 1992

0 '92 15:14 RAMADA INN TOPEKA/KSH

BANQUET AND HALF-TIME ENTERTAINMENT PROVIDED BY:
**THE KANSAS HIGH SCHOOL
 MASONIC ALL-STATE MARCHING BAND**

These young men and women from high schools across Kansas have donated their time and talents for four days in the marching band camp, preparing for banquet and half-time entertainment. Our thanks to each of them, their financial sponsors and the Masonic Lodges and other Masonic organizations that made this all possible.

TRIPPER NAME	HOME TOWN	DEPT. NUMBER	POSITION
Tracy Anderson	Wichita	001	Ltdg #12
Earl Adams	Overland	002	Ltdg #13
Anthony Adams	Topeka	003	Ltdg #14
Anthony Adams	Lawrence	004	Ltdg #15
Charles Aday	Empire	005	Ltdg #16
Clay Arnold	Wichita	006	Ltdg #17
Frankie Badger	Chaney	007	Ltdg #18
Wyn Dale	Lawrence	008	Ltdg #19
David Bann	Topeka	009	Ltdg #20
Raymond Bann	Wichita	010	Ltdg #21
David Bann	Lawrence	011	Ltdg #22
James Bell	Lawrence	012	Ltdg #23
Henry Bertram	Empire	013	Ltdg #24
Paul Bick	Empire	014	Ltdg #25
Paul Bick	Empire	015	Ltdg #26
Charles Bickel	Lawrence	016	Ltdg #27
David Bickel	Lawrence	017	Ltdg #28
David Bickel	Lawrence	018	Ltdg #29
David Bickel	Lawrence	019	Ltdg #30
David Bickel	Lawrence	020	Ltdg #31
David Bickel	Lawrence	021	Ltdg #32
David Bickel	Lawrence	022	Ltdg #33
David Bickel	Lawrence	023	Ltdg #34
David Bickel	Lawrence	024	Ltdg #35
David Bickel	Lawrence	025	Ltdg #36
David Bickel	Lawrence	026	Ltdg #37
David Bickel	Lawrence	027	Ltdg #38
David Bickel	Lawrence	028	Ltdg #39
David Bickel	Lawrence	029	Ltdg #40
David Bickel	Lawrence	030	Ltdg #41
David Bickel	Lawrence	031	Ltdg #42
David Bickel	Lawrence	032	Ltdg #43
David Bickel	Lawrence	033	Ltdg #44
David Bickel	Lawrence	034	Ltdg #45
David Bickel	Lawrence	035	Ltdg #46
David Bickel	Lawrence	036	Ltdg #47
David Bickel	Lawrence	037	Ltdg #48
David Bickel	Lawrence	038	Ltdg #49
David Bickel	Lawrence	039	Ltdg #50
David Bickel	Lawrence	040	Ltdg #51
David Bickel	Lawrence	041	Ltdg #52
David Bickel	Lawrence	042	Ltdg #53
David Bickel	Lawrence	043	Ltdg #54
David Bickel	Lawrence	044	Ltdg #55
David Bickel	Lawrence	045	Ltdg #56
David Bickel	Lawrence	046	Ltdg #57
David Bickel	Lawrence	047	Ltdg #58
David Bickel	Lawrence	048	Ltdg #59
David Bickel	Lawrence	049	Ltdg #60
David Bickel	Lawrence	050	Ltdg #61
David Bickel	Lawrence	051	Ltdg #62
David Bickel	Lawrence	052	Ltdg #63
David Bickel	Lawrence	053	Ltdg #64
David Bickel	Lawrence	054	Ltdg #65
David Bickel	Lawrence	055	Ltdg #66
David Bickel	Lawrence	056	Ltdg #67
David Bickel	Lawrence	057	Ltdg #68
David Bickel	Lawrence	058	Ltdg #69
David Bickel	Lawrence	059	Ltdg #70
David Bickel	Lawrence	060	Ltdg #71
David Bickel	Lawrence	061	Ltdg #72
David Bickel	Lawrence	062	Ltdg #73
David Bickel	Lawrence	063	Ltdg #74
David Bickel	Lawrence	064	Ltdg #75
David Bickel	Lawrence	065	Ltdg #76
David Bickel	Lawrence	066	Ltdg #77
David Bickel	Lawrence	067	Ltdg #78
David Bickel	Lawrence	068	Ltdg #79
David Bickel	Lawrence	069	Ltdg #80
David Bickel	Lawrence	070	Ltdg #81
David Bickel	Lawrence	071	Ltdg #82
David Bickel	Lawrence	072	Ltdg #83
David Bickel	Lawrence	073	Ltdg #84
David Bickel	Lawrence	074	Ltdg #85
David Bickel	Lawrence	075	Ltdg #86
David Bickel	Lawrence	076	Ltdg #87
David Bickel	Lawrence	077	Ltdg #88
David Bickel	Lawrence	078	Ltdg #89
David Bickel	Lawrence	079	Ltdg #90
David Bickel	Lawrence	080	Ltdg #91
David Bickel	Lawrence	081	Ltdg #92
David Bickel	Lawrence	082	Ltdg #93
David Bickel	Lawrence	083	Ltdg #94
David Bickel	Lawrence	084	Ltdg #95
David Bickel	Lawrence	085	Ltdg #96
David Bickel	Lawrence	086	Ltdg #97
David Bickel	Lawrence	087	Ltdg #98
David Bickel	Lawrence	088	Ltdg #99
David Bickel	Lawrence	089	Ltdg #100

STUDENT NAME	HOME TOWN	HIGH SCHOOL	SPONSOR
John Keller	Norton	Sylvan High	Lodge #154
Rich Kayser	Yates Center	Yates Center High	Lodge #144
Laurie Kauter	Leavenworth	Leavenworth High	Lodge #201
Marvella Kellerman	Lincoln	Lincoln High	Lodge #154
Charley Krueger	Colera	Colera High	Lodge #149
Brenda Lager	Gravel	Gravel High	Lodge #233
Tom Lars	Plummer	Plummer High	Lodge #81
Fred Larson	Shedden	Shedden High	Lodge #189
Orville Lee	Haji	Royal Valley High	Lodge #283
Chris Lee	Urich	Urich High	Lodge #211
Steven Lee	Richman	Richman High	Lodge #1
Sharon Lehman	Levy	Levy High	Lodge #37
Andy Lewis	Cherokee	Cherokee High	Lodge #319
Shelby Liberty	Mission	Mission High	Lodge #345
Steve Lohmeyer	Granville	Granville High	Lodge #308
Caris Martin	Hopkins	Hopkins High	Lodge #408
Becky Martin	Wesport	Wesport High	Lodge #143
Michael Martin	Woodbine	Woodbine High	Lodge #54
Sharon McDermott	Grassburg	Grassburg High	Lodge #384, OES #384
Karl McGowan	Dighton	Lea County High	OES #341
Walter McKee	Argency	Chaparral High	OES #167
Jennifer Miller	Marysville	Marysville High	OES #104
William Miller	Stilwell	Stilwell High	Lodge #312
Tory Miller	Zion	Wilton High	Lodge #286
Neil Miner	Orange	Orange High	Lodge #188
Emilee Moore	Cherokee	Cherokee High	OES #421
Orville Morgan	Elgin	Sedon High	Wesport #236
Donald Morse	Wichita	Wichita West High	Lodge #433
Mary Lynn Morhart	Garden City	Garden City High	Lodge #218
Yell Moser	Intrepid	Royal Valley High	Lodge #388
Charly Muth	Great Bend	Great Bend High	Lodge #16
Mike Nelson	Shenandoah	Shenandoah Mission Northwest	Lodge #153
Leon Oatis	Urich	Urich High	Lodge #191
John Opper	Bearfield	Latta High	Lodge #285
Moby Overton	Carthage	Carthage High	Lodge #28
Cleve Page	Fort Scott	Fort Scott High	Lodge #8, OES #3
Rebecca Palko	Wichita	Wichita East High	Lodge #423
Ka Peterson	Salina	Salina Central High	Lodge #387
Kevin Pickett	Shenandoah	Shenandoah Mission Northwest	Lodge #153
Fred Pickett	Wesport	Dighton High	Lodge #198
Carole Pinner	Dale	Raytown High	Lodge #118
Bobbie Ponder	Wesport	Wesport High	Lodge #244
Kathy Ponder	St Francis	St Francis High	Chaparral #149
Janice Pomeroy	Osage Falls	Shenandoah Mission North	Lodge #34
Justin Potts	Haskell	South Barber High	Lodge #338
Collette Potts	Colby	Colby High	Lodge #251
Jessie Puffer	Lawing	Lawing High	Lodge #48
Stephanie Schultz	Russell	Wichita High	Lodge #173
Stephanie Sharp	Garden City	Garden City High	Lodge #278
Jim Sharp	Salina	Salina High	Lodge #38
Travis Shivers	Tapscott	Tapscott High	High Twelve Club
Doug Spawer	Orchard	Jackson Heights High	Lodge #28
Bonnie Spivey	Plummer	Harvest High	Lodge #194
Darf Stebbins	Stratton	South Topeka High	Lodge #182
Darrel Stebbins	McLouth	McLouth High	Lodge #256
Truman Tabor	Hasty	Hasty High	Lodge #279
Stephanie Talbot	Lansing	Lansing High	Lodge #1
Cynthia Tate	Clay Center	Clay Center Comm. High	Lodge #34
Mary Tatum	Raytown	Raytown High	Lodge #114
Mark Tatum	Hickman	Hickman High	Lodge #248
Tamara Taylor	Clatsop	Oregon Trail High	Lodge #18
Carly Taylor	Hickman	Hickman High	Lodge #124
Howard Teak	Corral	Corral High	Lodge #147
Janice Teak	Hickman	Hickman High	Lodge #147
Jeff Thacker	Fort Scott	Fort Scott High	Barren Co. Shrine, OES #225
Mike Whitman	Colby	Tripp Community High	Lodge #148
Bobby Whitman	Wichita	Chaparral High	Lodge #201
Mark Whitman	Tapscott	Wichita Rural High	Lodge #14
Sam Whitman	Blue Mound	Jayhawk Union High	Lodge #234
Janice Whitman	Clatsop	Oregon Trail Junior High	Lodge #18
Mark Whitman	Salina	Salina High	Lodge #14, OES #28
Marcy Whitman	Stratton	Stratton High	Lodge #285
Mark Whitman	Tapscott	Seaman High	Lodge #28
Brenda Ziller	Wesport	Chaparral High	Lodge #288

BAND CAMP STAFF

Net proceeds from the financial sponsorship of a band member benefit the Kansas Mesonic Oncology Clinic at the University of Kansas Medical Center in Kansas City, Kansas.

The 8th Annual Kansas Mesonic All-State Band has been coached and instructed during the 4-day camp and are being directed today by Kurt Saville, Band Director, Washburn University, and his staff.

July 30, 1992

TO: Senator Dole
FROM: Mo West
SUBJECT: Kansas Shrine Bowl Honors

The Kansas Shrine Bowl began in the early 1970's by dedicated Shriners to develop and promote the idea of a joint effort by all 5 Kansas Shrine Temples to sponsor a high school All-Star Football Game. In 1973, representatives of each of the Kansas Shrine Temples met and signed the articles of incorporation in forming the Shrine Bowl of Kansas, Inc.

The Kansas Shrine Bowl has two primary functions:

- * the financial aid and support of the Shriners Hospital for Crippled and Severely Burned Children.
- * the promotion of Kansas High School sports and top athletes.

Each year the Kansas Shrine Bowl generates approximately \$50,000,00 in profits and sends 100% of these profits to the Shriner hospitals. Half of the amount sent to the hospitals is used in Kansas for Kansas patients.

I have attached a copy of the Kansas Shrine Bowl operating budget as of January 1992.

Kansas Shrine Bowl
Hospital Facts as of January 1992

It is said by some that the Shrine Hospitals have the largest endowment fund in the world and do not need more money to support the hospitals. It is true we enjoy a large endowment (the 3rd largest in the world with the only Stanford's and Harvard's being larger) and the interest that the endowment earns pays most of the operating expenses of the hospitals. But the following facts are also true.

- * Medical costs have sky-rocketed in recent years; yet Shrine Hospitals continue to provide free care and treatment that is the best available in the world.
- * The remodeled, new and rebuilt hospitals are free to the kids but they are not free hospitals. They are very expensive to build, equip and staff.
- * For the past two years, 50 million dollars has been pulled into the operating budget from the capital growth portion of the Shrine Hospital endowment fund. It is obvious that if this continues the endowment fund may not be able to generate the interest needed by the hospitals in the future.
- * During the past 10 years the total active patient list for all hospitals has increased 73.4%; the number of operations have increased 70.8% and the number of out-patient visits have increased 70%. Obviously the needs have been there and Shrine Hospitals have answered the needs. But don't you wonder how much the needs will increase during the next decade and don't you also wonder if the Shrine Hospitals will be prepared to answer those needs?
- * In 1977 the \$5.00 Hospital Assessment that each Shriner pays annually made up 77% percent of the total hospital operational budget. Today a \$5.00 assessment can pay only 2% of the total hospital operational budget.
- * Today hospital fundraising projects such as those conducted by the Kansas Shrine Bowl provide twice as much money to the hospitals as does the hospital assessment.
- * During last year the recently remodeled St. Louis Unit of Shriners Hospitals:
 - Approved 1902 new applications
 - Increased the active patient list to 12,225 kids
 - Had 2,001 admissions, up 13%
 - Performed 1,470 surgeries, up 20%
 - Had 10,734 out-patient visits, over 40 per dayBut the most important statistic is that there still is 993 kids on the waiting list at St. Louis.
- * Total Shrine Hospital for Crippled Children budget for 1992 is 306 million dollars, nearly \$35,000.00 every hour.
- * The operating budget (excluding capital expenditures) is UP 15 million dollars over last year. That is \$1,712.32 more each hour than it cost us to run the hospitals and provide "free" care last year.
- * Construction of the new Sacramento Unit, that will encompass all three disciplines of care for which Shriners Hospitals are noted -- orthopedic, burns and spinal injuries -- is expected to be complete by mid 1995. It is estimated that the sales tax paid by Shriners Hospitals on this construction project would have totally funded the construction of our first 10 hospitals.

So to those who say there is not more money needed for the hospitals, I say **WAKE-UP!** Without the hospitals and the humanitarian services they provide, the Shrine is only a chowder and marching society. But with the hospitals and their growth, our future is insured as **The Greatest Philanthropy in the World**. The Shrine of North American, Master Masons of Kansas and the general public, working together for the benefit of all mankind.

Shrine Bowl Story

WHAT IS THE KANSAS SHRINE BOWL?

Early in the 1970's several dedicated Shriners began to develop and promote the idea of a joint effort of all 5 Kansas Shrine Temples to sponsor a high school All-Star Football Game. It is interesting to note that the farsighted individuals developed their plans individually and often in completely different cities.

On the 29th day of October, 1973, a representative of each of the Kansas Shrine Temples (J. Willis Toothaker of Hoxie, Robert C. Morrison of Wichita, Ralph Taylor of Pittsburg, William N. Bond of Shawnee Mission, and Jack A. Quinlan of Topeka) met and signed the articles of incorporation forming The Shrine Bowl of Kansas, Inc.

According to the bylaws the Shrine Bowl has two primary functions:

1. The financial aid and support of the Shriners Hospitals for Crippled and Severely Burned Children.

2. The promotion of Kansas High School sports and the top athletes.

Each year the Kansas Shrine Bowl generates approximately \$50,000.00 profit and send 100% of those profits to the hospitals. Half of the amount sent to the hospitals is used in Kansas for Kansas patients. Additionally, the Kansas Shrine Bowl produces a first-class, state-wide, family event that brings honor and recognition to game participants, their schools, and their communities.

HOW DOES THE KANSAS SHRINE BOWL GENERATE INCOME?

The Shrine Bowl has 6 principal sources to raise money for the hospitals.

1. Program Advertising: The Kansas Shrine Bowl Program is one of the largest football programs in the United States, generating approximately \$80,000.00 per year. It gives a business, merchant, Shrine Unit, or individual a chance to show their support of the game, and it is a very economical method of advertising state-wide.

2. Gold Pages: When a \$500.00 or larger gift is made to the Shriners Hospitals for Crippled or Burned Children through the Kansas Shrine Bowl a Gold Page acknowledgment is printed in the next Shrine Bowl Program Book. The Shrine Bowl absorbs the cost of printing and 100% of the amount of the gift goes into hospital operational funds. Another type of Gold Page is a \$500 or larger donation to the Endowment Fund. This is basically the same as a Hospital Gold Page except that an Endowment Gold Page does not go directly to the Hospital, but to the Endowment Fund where only the interest is used by the hospitals. Each Gold Page donor receives the Gold Page acknowledgment letter and a certificate from the hospital and Imperial Shrine and their name permanently inscribed in the "Book of Gold" in that hospital.

3. Ticket Sales: Every year hundreds of Shriners across the state buy thousands of tickets through a direct mail solicitation to support the game and the hospitals. Thanks to the support of the Shriners who buy their tickets and donate them back it is possible to give "free" tickets to many disabled or disadvantaged children or to others, such as coaches, cheerleaders, and students that would not otherwise attend the game. Tickets are sold state-wide in Shrine Temples, local business, and at the game.

4. Hospital Plaques: Many people across the state have indicated a desire to help

and support our worthwhile efforts, but do not wish to or cannot by ethical standards, advertise in the program. For those persons and others that wish to help in this way, there is a beautiful, personalized walnut plaque acknowledging their \$100.00 donation and the year they supported the Shrine Bowl and Hospitals. Plaques are available in Bronze, Silver, Gold and Platinum.

5. Merchandise Sales: Souvenirs of all types are available throughout the year and at the game. Pens, license plates, t-shirts, caps, and belt buckles are just a few of the many items available.

6. Grants, Gifts & Sponsorships: Each year employee clubs, charitable foundations, and friends of the hospitals make contributions to the Shriners Hospitals through grants to the Kansas Shrine Bowl. Various expenses are often off-set by commercial sponsors who are interested in helping the hospitals and using our public image to compliment or advertise their image or that of their product.

HOW ARE PARTICIPANTS CHOSEN?

Players are selected by mail ballot to a team of sports media professionals from all across Kansas. NO Shriner is allowed any input into final selections of the teams. After the selection committee has chosen 30 players for each squad the head coaches are allowed 3 additional selections to round out their squads.

Each head coach is selected from the previous year's staff of assistant coaches. The assistant coaches are selected according to their teams final standing in the state high school play-offs. As a result of this system each size school classification participating in 11-man football is represented by at least one coach on each squad.

The players and coaches attend a two week orientation and training session immediately prior to the game. During this camp all expenses, including meals and training uniforms, are paid by the Shrine Bowl. On the Saturday prior to the game all participants are taken to St. Louis for a break from training and a tour of the Shrine Crippled Children's Hospital.

WHAT HAPPENS ON SHRINE BOWL WEEKEND?

Many fun filled events combine to make Shrine Bowl weekend an exciting and popular family entertainment extravaganza. A large banquet honoring the players and coaches takes place on the night before the game. The annual Shrine Bowl game is scheduled for the first Saturday in August on a major university campus. There are special sales and promotions by area businesses, the largest annual Shrine parade in the state, and many picnics and tailgate parties. Special events sometimes include hot air balloons, clowns, parachutists, fireworks, and band performances.

Half-time, pre-game and post game shows feature the Kansas All-State Masonic Band. The band consists of approximately 160 of the state's most talented high school musicians who spend four days in a professionally administered marching band camp. Each participant in the band is sponsored by a Masonic Lodge, or other Masonic body in Kansas, and all sponsorship money generated in excess of the expenses of the camp are donated to the Kansas Masonic Foundation Oncology Clinic at K.U. Medical Center.

**SENATOR BOB DOLE
SHRINE BOWL BANQUET**

**THANK YOU. IT'S A
PLEASURE TO BE HERE, AND TO
EXTEND MY CONGRATULATIONS
TO THE PLAYERS, COACHES,
AND TRAINERS WHO WILL
PARTICIPATE IN TOMORROW'S
KANSAS SHRINE BOWL.**

**LOOKING AROUND THIS
ROOM THIS EVENING, I HAVE TO
SAY THAT I WISH I COULD HAVE
BROUGHT THE WASHINGTON,
D.C. MEDIA WITH ME. SO OFTEN,
THE MEDIA UP THERE FOCUSES
ON WHAT'S WRONG WITH
AMERICA.**

**AND, YES, WE HAVE OUR
PROBLEMS. BUT HERE THIS**

**EVENING, I AM REMINDED AGAIN
OF THE MANY THINGS THAT ARE
RIGHT WITH AMERICA.**

**I SEE YOUNG HIGH SCHOOL
GRADUATES, WHO ARE LOOKING
FORWARD TO COLLEGE AND TO
BUILDING A GREAT FUTURE FOR
THEMSELVES AND THEIR
COUNTRY. I SEE PARENTS WHO
HAVE WORKED HARD TO INSTILL**

**STRONG KANSAS VALUES IN
THEIR CHILDREN. I SEE
SHRINERS WHO ARE
CONSTANTLY REACHING OUT TO
CHILDREN IN NEED.**

**YES, AMERICA HAS HER
SHARE OF PROBLEMS. BUT THE
POINT I AM MAKING IS THAT WE
ARE THE MOST SUCCESSFUL
NATION ON EARTH BECAUSE WE**

**ARE ALL PART OF THE
SOLUTION. EACH OF US HAS
AN OPPORTUNITY TO PLAY A
ROLE IN SETTING AMERICA'S
COURSE FOR THE FUTURE.**

**TO THE YOUNG MEN WHO
WILL PLAY IN THE SHRINE
BOWL--LET ME JUST SAY THAT
TOMORROW, THE COACH WILL
PROBABLY CALL THE PLAYS.**

**BUT IN THE GAME OF LIFE, IT IS
NOW UP TO EACH OF YOU TO
CALL YOUR OWN PLAYS. EACH
OF YOU WILL MAKE THE
DECISIONS ABOUT WHAT ROADS
YOU WILL TAKE IN LIFE.
GOVERNMENT DOES NOT TELL
YOU IF YOU CAN OR CAN NOT
GO TO COLLEGE. GOVERNMENT
DOES NOT TELL YOU WHERE**

**YOU WILL WORK OR WHAT
YOU'LL DO. GOVERNMENT DOES
NOT PLACE ANY LIMITS ON
YOUR DREAMS. THOSE
DECISIONS ARE UP TO YOU.
AND SITTING AMONG YOU
TODAY MAY BE THE
QUARTERBACK WHO WILL HELP
THE KANSAS CITY CHIEFS WIN
THE SUPER BOWL...BUT I ALSO**

HOPE SITTING HERE IS THE
SCIENTIST WHO WILL DISCOVER
THE CURE TO AIDS, THE FARMER
WHO WILL HELP FEED THE
WORLD, THE VOLUNTEER WHO
WILL GIVE TIME AND ENERGY TO
THOSE IN NEED, AND THE
TEACHER WHO WILL EDUCATE
YOUR CHILDREN.

**AGAIN, MY
CONGRATULATIONS TO THE
SHRINERS AND TO ALL THOSE
WHO WILL PARTICIPATE IN
TOMORROW'S GAME. IN MY
VIEW, YOU ARE ALL "GOLD
MEDAL WINNERS."**