

## IOWA -- POLITICAL SCENARIO

### U.S. Senate Race

#### **POLLING:**

A poll commissioned by three Iowa television stations (KCCI-Des Moines, KGAN-Cedar Rapids, and KTIV-Sioux City) and conducted by Political-Media Research, Inc., shows Harkin leading Tauke by a mere 9-point margin (46% to 37%). Seventeen percent of Iowans surveyed were uncommitted.

Tauke's people contend that Harkin's dropping below 50% shows his vulnerability, while a Harkin spokesman maintained the sitting Senator's 17-point lead among Independents.

#### **SURROGATES:**

Tauke's campaign received an early boost from Clayton Yeutter in 1989. Also throughout the year, President Bush, Vice President Quayle, Secretary Sullivan, and Secretary Dole appeared. The Tauke campaign also has future commitments from Secretary Cavazos (June), Secretary Mosbacher (July), Secretary Brady (August), and Secretary Kemp. Iowa Native Son Cooper Evans will also appear.

#### **CAMPAIGN THEMES:**

Tauke is stressing his abilities as a coalition-builder in Congress -- as opposed to Harkin, who you'll recall gave a very strong statement in 1985 regarding your stand on portions of the Farm Bill. The character issue has worked well for Tauke -- and they're painting Harkin as accountable to influence peddlers. (90% of his fundraising money is from out-of-state donors).

#### **ISSUES TO STRESS:**

Tom Tauke is a friend to agriculture. The Harkin record is bad news for farmers, since he's beholden to special interests on both the East and West Coasts. (See specifics in Tauke campaign brief).

Also, Tauke has asked that you stress that if Harkin is defeated, Iowa won't lose a seat on the Senate Agriculture Committee -- since Harkin is fighting for agriculture interests outside of Iowa. Emphasize Tauke's futuristic ideas about agriculture. While you can't promise that Tauke will be a member of the Agriculture Committee once elected, you can stress Harkin's ineffectiveness in spite of his being an Agriculture Committee Member.

Let's let Iowa repeat history. No Democratic Senator has ever been elected to two consecutive terms in Iowa. With Grassley's popularity and strong reelection in 1986, with 66% of the vote, it's important for Iowa to stay on track -- by defeating Harkin and electing Tauke.

IOWA POLITICAL SCENARIO  
PAGE TWO

ISSUES TO AVOID:

Abortion. This issue is expected to play a significant role, with Tauke strongly pro-life and Harkin pro-choice. The National Abortion Rights Action League is spending thousands of dollars in an independent campaign against Tauke, although many Iowa radio and TV stations are refusing the air NARAL's advertisements due to their political content.

Americans With Disabilities Act. Harkin has already gotten a great deal of mileage out of his commitment to people with disabilities. However, Tauke's "innoculation strategy" involves the Grassley-Tauke amendment to the ADA, which extends the same protections for Congress. This was included in the House-passed version of the ADA.

Other Elections:

Gubernatorial. According to the poll cited above, the Democrat primary for Governor remains close, with Attorney General Tom Miller at 32%, and House Speaker Don Avenson at 27%. Former banker John Chrystal trails with 20%, and 21% are Undecided. The primary is next Tuesday, with the winner to face GOP Incumbent Governor Branstad.

Second C.D. With Tauke's seat open, there's a three-way race for the Republican nomination between Joe Ertl, Dr. Wayne Moldenhauer, and Jim Nussle. Steve Sovern and Eric Tabor will vie for the Democratic nod. Sovern ran against Tauke in 1980, and Tabor ran against him in 1986 and 1988.

Third C.D. Democrat Incumbent Rep. Dave Nagle will run against GOP challenger Jim Abbas.

Fourth C.D. Democrat Incumbent Rep. Neal Smith is unopposed.



## IOWA STOPS

### Des Moines

As you know, more than 60% of the voters in Iowa's Fourth District are in Polk County, mostly in the City of Des Moines. Smaller industrial towns and farm communities surround Des Moines, the commercial, financial, and government center.

White, protestant, middle class individuals live in Des Moines, a city with little ethnic flavor. It is the second largest insurance city, with more than 50 insurance companies.

The United Auto Workers has a significant presence, with about 4,000 members and a regional office. Some UAW members in the farm equipment industry have been hard hit by the farm depression. Naturally, the UAW's very presence provides the Democrats with the successes they've had in Iowa 4. (Rep. Dave Nagle currently represents the Fourth District).

The Fourth District was Dukakis' best in Iowa in 1988 (60% of the vote), although Reagan carried Polk County in 1980, and Mondale narrowly defeated him there in 1984.

### Ames

North of Des Moines in Story County is Ames, a city of 44,000. Ames is the home of Iowa State University. Story County gave independent John Anderson more than 19% of the vote, his fifth best county showing in the nation. Four years later, Reagan won Story County by a narrow percentage, and in 1988, it was Dukakis who was the victor.

Of course, Ames sticks in your memory due to the Mayor's "flip-flop" endorsement from you to Bush during the INF Treaty discussions, when you decided to hold off before committing immediately to the Treaty.

### Marshalltown

Iowa 3 remains Democrat territory with liberal Johnson County where the University of Iowa is located.

Black Hawk County, Iowa's fourth largest metropolitan area, casts the district's largest single block of votes (30%). Waterloo and Cedar Falls are two major towns located in Black Hawk and concentrated with workers in the farm-implement industry. Labor unions are strong, although Republicans have won this area in the past.

The Northern part of Iowa 3 stretches to the Minnesota border, and is filled with Republican voters in rural counties.

### Mason City

Located in Cerro Gordo County, in Northern Iowa 6, is the county seat, Mason City. Producer of ice machines and building materials, Mason City also processes meat and dairy products. Mason City was the inspiration of the musical, "The Music Man", by native son Meredith Wilson.

The Sixth, represented by Republican Congressman Fred Grandy, is one of the most agriculturally-productive areas in the State with flat, rich soil and consistently impressive yields of corn and soybeans. But with today's high costs of farming, many small scale farmers have sold their land to agri-businesses, eliminating jobs and causing migration from the district.

The Sixth also is home to Sioux City, an old meat-packing town that is the largest city in Western Iowa.



Iowa - Congressional Districts

# Iowa



**Terry E. Branstad (R)**  
**Moines — Elected 1982**  
 Born: 17, 1946, Leland, Iowa.  
 Education: U. of Iowa, B.A. 1969; Drake 1974.  
 Career: Army, 1969-71.  
 Occupation: Lawyer; farmer.  
 Religion: Roman Catholic.  
 Career: Iowa House, 1973-79;  
 34th governor, 1979-83.  
 Term: 1990.

	47%
	30%
	14%
<b>Workers</b>	
	18,248
	58,665
	129,747

\$ 20,052 (20th)

\$ 800 (31st)

April 12 \$ 3,619 (23rd)

14% (37th)

231 per 100,000 (41st)

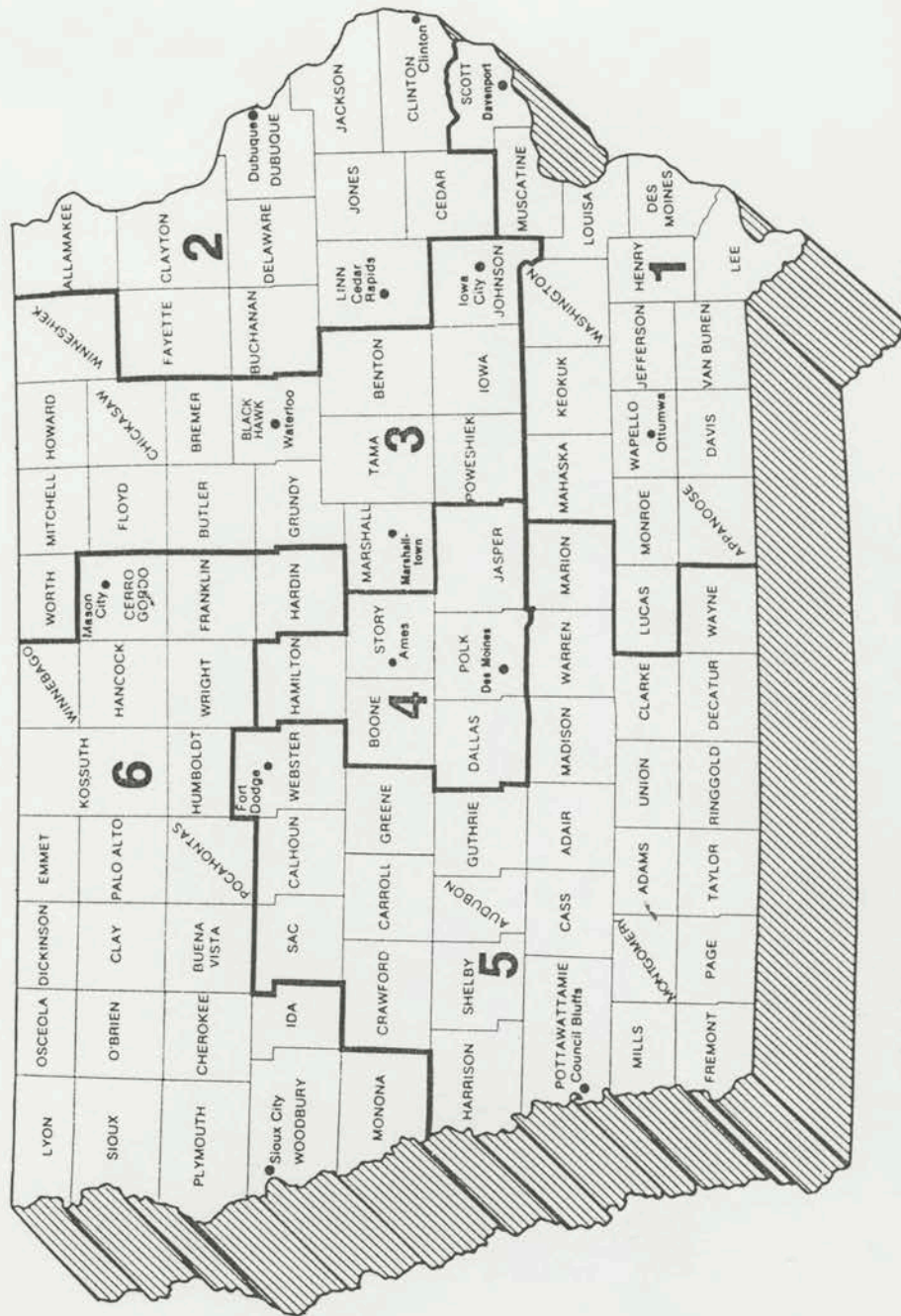



MAY 23 '90 10:53 FROM IOWANS FOR TAUKE

PAGE.006

ISSUE: HARKIN AND BOB DOLE

SUMMARY:

Bob Dole and Tom Harkin are not the best of friends.

- 1) In the Senate, though, the conventional wisdom has taken its toll on Harkin. The belligerence of his crusade for farmers and his crusade for farmers and against the Nicaraguan Contra rebels has jarred the nerves even of colleagues who agree with him, and alienated those who do not. His refusal to play by the rules is unsettling to many senators, who seem to see in him an attack on the network of mutual self-interest that keeps conflicts in the Chamber within manageable bounds. Harkin's effectiveness has suffered as a result. It did not help that, shortly after arriving in the Senate, he began lecturing his colleagues on farm problems in a way that implied they had scarcely heard of the issue before. Although he later toned down his rhetoric, he continued to clash with the leadership of both parties - especially with COP leader Robert Dole, whose distaste for his farm-state neighbor has been evident on more than one occasion. Several times, Harkin has entered into confrontations with the leadership, only to discover that he had just a handful of allies backing him up." (Politics in America, 1990)
- 2) "DOLES SAY HARKIN VOTE HURTS REAGAN"  
(Cedar Rapids Gazette, 11/1/84)
- 3) "HARKIN'S MAIDEN SPEECH TURNS INTO CLASH WITH DOLE ON FARM AID"  
  
"He described Dole's resistance to farm credit legislation as 'terribly insensitive,' saying it is another indication that Dole has left Kansas and the farm belt 'completely.' The majority leader has an 'acute case of Potomac Fever. He forgot about what's going on in his home state. He owes his first loyalty there, not to the president.'" (Cedar Rapids Gazette, 2/20/85)
- 4) "Mr. President, I had not expected my first word offered in this Chamber would be to engage in polemics with the distinguished majority leader, but when I came to the floor I heard the distinguished majority leader say that he did not want us to engage in political games." (Tom Harkin, Congressional Record, 2/19/85)



- 5) "FARM BILL DEBATE MANIPULATIONS PUT HARKIN, DOLE AT ODDS WITH EACH OTHER"
- "I like the guy. he's bright. There are a lot of things I agree with him on. But I don't like the way he runs the Senate. As a majority leader he comes close to abuse of power.... And he doesn't understand that he's majority leader and it comes with the power. He can dish it out but he can't take it." (Tom Harkin, Cedar Rapids Gazette, 11/22/85)
- 6) "Dole, who has been feuding with Harkin throughout the eight month farm bill debate, said the referendum would not call for 'mandatory participation by farmers, but it did represent 'voluntary bankruptcy.'" (SENATE WRAPPING UP FARM BILL, Cedar Rapids Gazette, 11/23/85)
- 7) "HARKIN STINGS, DOLE ITCHES"  
(Des Moines Register, 11/26/85)
- 8) "BOB AND TOM..."
- "Harkin on occasion has ventured into Kansas for some Dole Bashing and Dole in the past hasn't been coy about his feelings toward Harkin..."  
(Des Moines Register, 3/9/86)
- 9) "HARKIN BLOCKS WORD CHANGE; DOLE ANGRY"  
(Spencer Daily Reporter, 3/11/86)
- 10) "FIGHT ANOTHER DAY"
- "...earlier this week, Senate rookie Tom Harkin of Iowa needlessly antagonized Dole over a trivial wording change in a non-binding 'sense of Congress' resolution accompanying a crucial farm bill. Such brashness Iowans don't need."
- "Harkin's actions remain worrisome on several counts. He seemed to be politicking and grandstanding. If he wasn't, Dole still saw it that way. 'We'll keep an eye on something he (Harkin) wants some day,' the majority leader vowed. (A lot of good that will do Iowans.)" (Cedar Rapids Gazette Editorial, 3/14/86)
- 11) "HARKIN: DOLE PLAN CRUSHES GRAIN TRADE, Ships That Stop In Cuba Would be banned in U.S." (Des Moines Register, 7/11/87)
- 12) "'We might as well shut our exports down,' he said Friday. He referred to the bill as the 'Bob Dole Grain Embargo Act of 1987.' 'It's obvious that Bob Dole is pandering to the right wing and hoping no one from the farm states, including his own, will notice,' said Harkin." (Cedar rapids Gazette, 7/11/87)

MAY 23 '90 10:54

FROM IOWANS FOR DOLE

PAGE.008

13) "Harkin has the same problem with a guy like Bob Dole working the state showing some senators do more than pound crosses into Washington Parks for the TV cameras." (David Yepsen, "IOWA POLITICIANS ARE UPSTAGED BY CANDIDATES IN CAUCUS LIMELIGHT," Des Moines Register, 11/24/87)

14) "DOLE POLITICKS WHILE AG BILL WAITS: HARKIN"

"We could pass this bill right now and send it to conference with the House. I resent this." (Tom Harkin, Cedar Rapids Gazette, 12/8/87)



Page 14

March 15, 1990

## IOWA

TOM HARKIN

DEMOCRAT

RATING: Toss Up

## Recent Senate Elections:

Percent	Democrats	Year	Republicans	Percent
43	Dick Clark	1976	Roger Jepsen	51
48	John Culver	1980	Chuck Grassley	54
69	Tom Harkin	1984	Roger Jepsen	44
34	John Roehrik	1988	Chuck Grassley	66

## Democrats:

Tom Harkin—Incumbent

## Republicans:

Tom Tauke—U.S. Representative (1)

## ANALYSIS:

More so than any other Senate race in the country, this one is the most fully engaged and the battle lines are clearly drawn. Anyone watching the battle between Harkin and Tauke comes away with the impression that both sides are running full throttle. Although Tauke has been the only candidate on the air thus far, the blows that have been exchanged over the course of the last several months are sufficient enough to provide a taste of what the balance of the campaign will be like. With debates likely to commence in April, the campaign will likely remain at this pace or more for the duration.

The war will be fought on at least two levels, character and commitment to the needs of Iowans. On the character front, Harkin is positioning himself as a tough, relentless fighter for Iowa who will pull out all the stops when battling for the state or for what he thinks is right. Harkin will likely use this as a means of defining his strength of character for the voters. Third parties will most likely be utilized to cast abortion as a character issue in an attempt to cast Tauke as someone who would inject his personal value structure on women in unfortunate circumstances.

Tauke will probably be portrayed as a fundamentally decent, caring man who seeks to see and solve problems without recklessly making accusations or determining his positions through the means of political expediency. His campaign will likely try to paint Harkin as a man who, when cornered, will say or do what it takes—true or not, right or wrong—in order to get out of a situation or accomplish a task.

Iowans will be forced to sift through dozens of commercials to decide for themselves whether, for example, Harkin is deeply committed to the working people of Iowa or to a personal, liberal agenda that is out of synch with the average voter or whether Tauke is a man of Iowa values and upbringing who took those attributes to Washington or someone who sold out to a national conservative agenda.

There will be no kid-glove treatment in Iowa. You can tell from talking with people on both sides of the fight that they are giving their all to the effort, and that they don't have much use for the people on the other side. This race will be one which attempts to destroy the other guy.

What role abortion will play is unclear. If the debate is framed along the simple pro-choice/pro-life axis, the playing field will be tilted in favor of Harkin. Harkin supporters believe that if Tauke is thought to be fully supportive of the Dornan Amendment, which states that abortion is illegal under any

## Key Dates:

Filing Period ..... March -31  
Primary ..... June 6  
Runoff .....

## Committee Assignments:

Agriculture, Appropriations, Labor, and  
Small Business

First Elected: 1984

and all circumstances, his chances of winning are slim. On the other hand, if the debate goes deeper and becomes more complicated, the outcome is less clear. The Iowa Right-to-Life Committee has announced that they will counter the advertising of pro-choice forces with their own, attempting to shift the battle ground to terrain more favorable to their cause and candidates. The first wave of full-page newspaper ads ran in 55 small towns, was in the form of a quiz that asked people to mark down their own views toward specific situations and compare those positions with those of Harkin, Tauke and "mainstream America," as defined by polls released by CBS News/New York Times and Newsweek magazine. There are four questions on the quiz. First, "Should parents be notified before abortions are performed on teenage girls?" Second, "Once the baby is capable of living outside the womb, should abortion be allowed?" Third, "Do you believe women should by law be guaranteed counseling on alternatives and dangers before abortions are performed?" And finally, "Do you support abortion as a form of birth control?"

Conversely, the debate could shift to cases of rape, incest, mother's life or fetal deformity, which then tilts it back to the pro-choice side. For someone coming from the pro-life side, the options are stand your ground, switch, waffle or attempt to reposition the debate onto your own terms, the latter



of which is the course being taken in Iowa. It is a sophisticated approach and it will be interesting to see if it works.

Another flurry of punches and counter punches that took place in recent weeks has centered on whether a Harkin education plan would involve a tax increase. The Tauke camp charges that Harkin is seeking to raise taxes, but is not being honest about it. Harkin has made a semantical argument that establishing a dedicated funding source for educational improvement through a surcharge of some kind is not a tax increase. Tauke's campaign responded with a tape recording from a radio show of Harkin conceding that it was an "additional tax," but Harkin's campaign countered that the radio interview remarks were prior to the events in Eastern Europe and the advent of the peace dividend.

There is only a small chance that this will not be a 51 percent to 49 percent or a 52 percent to 48 percent race, one way or the other. Figuring out which of the two candidates will have the 50.1 percent of the vote is very difficult, if not impossible. The state is not a terribly expensive one, but not

cheap either. While many of the states to the west. As a result, while both campaigns will have to work hard to raise sufficient money, both, in the end, will have what they need.

There are two big questions for Tauke. First, is he, deep down, mean or tough enough to deliver the biting and very lively low punches that it takes to win? By most accounts, he is a caring and decent man who has not, in past campaigns, been forced to resort to the brutalization of opponents. As terrible as that sounds, in this particular kind of a Senate race it's true. If Tauke embraces the style, he can go toe to toe with Harkin for the distance, and he will stand a good chance of winning. If he shows reluctance to engage in these sorts of attacks, he could well end up in the loss column. The second question is whether the unusually early start and fast pace of this contest will deplete the arsenal of material to use against Harkin too quickly. In most challenger campaigns, there is a finite stockpile of prime arguments, examples or products of opposition research that correctly and precisely drive home your message. If utilized too early, the campaign's message can

weeks. This is a bigger problem for challengers than for incumbents, so Tauke is at greater risk due to the run and shoot nature of this game.

For Harkin, the question has long been whether he will attempt to run his own campaign or rely on the guidance of advisers. While there is always a danger in candidate-managed campaigns because the candidate may not always view situations as dispassionately or as clearly as a professional, Harkin's style is such that he may be particularly inclined to micro-manage the campaign. Control, focus and discipline are key in a race such as this one in order to clinically determine the right message, as well as the precise manner and timing of communicating that message. In the heat of a campaign, the candidate often either over-reacts to situations or ignores danger signs that others can more calmly diagnose and correct. Early indications are that Harkin recognizes the potential problems that would likely result and has brought on an unusually strong team, both in staff and consultants, that could provide an effective counterweight to such tendencies.

## KANSAS

NANCY KASSEBAUM

REPUBLICAN

RATING: Solid Rep

### Recent Senate Elections:

Percent	Democrate	Years	Republicans	Percent
42	William Ray	1978	Nancy Kassebaum	54
56	John Simpson	1980	Bob Dole	64
21	James Maher	1984	Nancy Kassebaum	78
30	Guy MacDonald	1986	Bob Dole	70

### Potential Democrats:

Dick Williams—Wichita State University professor (1)

### Republicans:

Nancy Kassebaum—incumbent

## ANALYSIS:

Once Rep. Dan Glickman announced that he would not challenge

### Key Dates

Filing Deadline ..... June 11  
Primary ..... August 7  
Runoff ..... none

### Committee Assignments:

Budget, Commerce, and Foreign Relations

First Elected: 1978

Kassebaum, any chance of a competitive race disappeared.



The Cook Political Report



TALKING POINTS REGARDING TOM HARKIN & AGRICULTURE  
SUGGESTED FOR DOLE EVENT - JUNE 1, 1990

- \* QUICK OUTLINE OF FRONT-BURNER CONGRESSIONAL BATTLES CRUCIAL TO IOWA, MIDWEST: AGRICULTURE, RURAL HEALTH CARE, ETC.
- \* IOWA SENATE RACE: IMPORTANCE IN LIGHT OF CRUCIAL BATTLES FOR IOWA, MIDWEST

AGRICULTURE AS A PRISM TO VIEW IOWA RACE:

- o THE HARKIN RECORD - BAD NEWS FOR FARMERS
- o THE TAUKE RECORD - COMMITTED TO IOWA FARMERS...NOT EAST COAST SEAFARERS UNION, NOT NEW YORK & CALIFORNIA FAT CATS (who give Harkin more \$\$ than Iowa Democrats; 90% of Harkin support from out-of-state)

- \* VICTORIES FOR IOWA IN U.S. SENATE REQUIRE A SENATOR TRUSTED, RESPECTED BY COLLEAGUES

- o GRASSLEY: WON THE RESPECT, TRUST, ADMIRATION OF REPUBLICANS DEMOCRATS ALIKE...WINS MANY BATTLES FOR IOWA WITH BIPARTISAN SUPPORT.
- o HARKIN'S COLLEAGUE-BASHING STYLE HAS ALIENATED OTHER SENATORS (Politics in America, 1988) - IOWA'S LOSS
- o TAUKE: BEST KNOWN AS A COALITION BUILDER - UNITING REPUBLICANS AND DEMOCRATS ALIKE FOR VICTORIES CRUCIAL TO IOWA.

\*\* REFERENCES FOR THE DOLE OFFICE:

- \* HARKIN: KEY POINTS ON AG RECORD  
MEDIA STORIES ON: HARKIN'S BOMBASTIC STYLE IN U.S. SENATE, ALIENATION OF COLLEAGUES, LOSS OF INFLUENCE BECAUSE OF ARROGANCE AND ABRASIVENESS. DEMOCRAT QUOTES ON HARKIN.
- \* TAUKE: KEY POINTS ON AG RECORD  
MEDIA STORIES ON: TAUKE AS RISING STAR IN CONGRESS, TAUKE ACHIEVEMENTS, TAUKE'S LEADERSHIP AS A COALITION BUILDER. DEMOCRAT QUOTES ON TOM TAUKE.

MAY 23 '90 10:50 FROM IOWANS FOR TAUKE

PAGE.003

## AGRICULTURE TALKING POINTS

Tom Harkin likes to talk about fighting for farmers but Harkin too often fights for things that farmers don't want.

### MANDATORY PRODUCTION CONTROLS:

Tom Harkin's legislation was denounced by the Iowa Farm Bureau, the Department of Agriculture, the Des Moines Register, and newspapers throughout the country because it would have idled up to 40 percent of our farm land, closed hundreds of Main Street businesses in Iowa, and created a huge agricultural bureaucracy.

Tom Tauke supports the 1985 farm bill that he helped fashion because it has brought hundreds of millions of dollars into the state. Survey after survey shows that Iowa farmers agree with Tom Tauke's position on the 1985 farm bill.

### CARGO PREFERENCE:

Tom Harkin has consistently voted to require that commodities sent to other countries be carried by U.S. ships - thus raising the cost of shipping and lowering exports of agricultural products from Iowa.

Tom Tauke opposes cargo preference legislation because it lowers the demand for Iowa products.

### CHICAGO BOARD OF TRADE SCANDAL:

Tom Tauke forced the Democratic House to ask the General Accounting Office for an independent probe of the July soybean scandal.

Tom Harkin skipped an April 5, 1989 hearing of the Senate Appropriations Subcommittee concerning the FBI probe of the Chicago Board of Trade.

### GRAIN EMBARGO:

Tom Tauke urged President Bush to drop any plans for a grain embargo against China when Secretary of State Baker did not rule out that possibility, and within hours President Bush publicly announced that there would be no grain embargo.



MAY 23 '80 10:51 FROM IOWANS FOR FARMERS <http://dolearchives.ku.edu>

PAGE.004

page 2

Tom Harkin's supposed attempt to "repeal" Jimmy Carter's grain embargo was labeled a "fraud" by current House Speaker Tom Foley and failed because Tom Harkin was the only member of the entire House to vote for his proposal. And, during Carter's grain embargo Harkin led the fight to persuade Carter to include phosphate fertilizers in the embargo.

#### FARM TAXES:

Tom Harkin voted against farm state Senators and was the deciding vote in favor of taxing farmers on their fertilizers and feed grains.

Tom Tauke led the charge to repeal the heifer tax and to insure tax-free diesel fuel for farmers.

#### AGRICULTURAL TRADE:

Tom Harkin voted to kill an amendment that would have barred implementation of textile quotas if the President determined that the quotas would lead to reductions in U.S. agricultural exports.

Tom Tauke cosponsored legislation to toughen grain quality standards and thus improve U.S. competitiveness.

#### SOIL & WATER CONSERVATION:

Tom Harkin voted against transferring \$300 million from the Legal Services Corporation to crop insurance and water conservation programs.

Tom Tauke sponsored legislation to create a national conservation reserve before the current CRP was established in 1985 and has since worked to insure flexibility in CRP guidelines.

#### AGRICULTURAL CREDIT:

Tom Harkin missed the vote on a proposal to cut \$1.2 billion from the Agricultural Credit Insurance Fund because he was out collecting a \$1000 honoraria that day.

Tom Tauke worked to develop secondary mortgage markets for farmers (Farmer Mac) and insure the integrity of those markets.



16 OMAHA WORLD-HERALD Tuesday, November 11, 1986 ★

## Harkin Deny Leadership Roles

# Idea Gets Fiery Zorinsky Reply

By David C. Beeder

WORLD-HERALD BUREAU

Washington — Iowa Sen. Tom Harkin's suggestion that Senate Democrats deny leadership positions to Sen. Edward Zorinsky, D-Neb., drew an angry response Monday from Zorinsky.

"I don't give much credence or support to anything Tom Harkin supports or is behind because I think he does it for personal gain," Zorinsky said. "And I think someday the people of Iowa will realize that."

Zorinsky said in August that he might consider rejoining the Republican Party if it would benefit Nebraska. He was rebuked by Harkin in an interview published after the Democrats won 55-45 control of the Senate last week.

Harkin, a Democrat, was quoted in the Lincoln Journal Thursday as saying of Zorinsky:

"Here's a guy who's willing to sell out and go with the Republicans. Why should we reward him?"

### Follow His Desires

Harkin said Zorinsky should "follow his innermost desires" and rejoin the Republican Party, according to the story. "Life is too short to push and espouse principles you don't believe in," Harkin was quoted as saying.

In an interview Monday night, Harkin confirmed the accuracy of the Journal story.

"If Ed Zorinsky thinks I am the only one who feels this way, he is sadly mistaken," Harkin said. "I may just be the only one with guts enough to say it."

Zorinsky said he had read Harkin's comments.

"The fact that Harkin didn't make these statements before the election indicates he is as much an opportunist as he accuses other people of being," Zorinsky said in a telephone interview from Omaha.

"He waited to make the comment until he found there were 55 Democrats



Zorinsky



Harkin

animosity toward people rather than his overall view toward bettering the government.

### Their Prerogative

"I have managed to survive for 10 years in the Senate with the bottom line being representing the people of my state," Zorinsky said.

"They happen to be of both parties. If Harkin and other people just want to represent one party in their state, that's their prerogative."

Zorinsky said that Harkin, as a member of the House of Representatives, called Zorinsky a number of times to praise Zorinsky's stand against giving aid to rebel forces fighting the Sandinista government in Central America.

Zorinsky said Harkin is the only one he knows who has suggested that Senate Democrats punish Zorinsky.

"If there are others, he said, they may be among those Democrats who weren't happy with me five years ago before party was an issue."

"I am a conservative Democrat, and they don't like conservative Democrats, even though they are Democrats themselves," he said.

### Foreign Relations

Zorinsky said Harkin has indicated that he would be interested in serving on the Foreign Relations Committee and has asked for Zorinsky's support.

"Chris Dodd (D-Conn.) called me and said he would be interested in the subcommittee chairmanship if I weren't," Zorinsky said.

"He didn't phrase his question in a way that indicated they are going to take it away from me," he said.

"In fact, the new chairman of the Foreign Relations Committee, Claiborne Pell, (D-R.I.), is a very strong advocate of seniority, and I do have the seniority to assume that chairmanship," Zorinsky said.

Harkin denied that he is seeking a seat on the Foreign Relations Committee. He said he had written to Zorinsky in October to seek his support on the steering committee for an appointment to the Commerce Committee.

### Not Personal

Harkin now is a member of three committees, agriculture, appropriations and small business.

"It is not a personal animosity," Harkin said in an interview. "It's just that I think Ed has violated those traditional concepts of keeping your word, loyalty to one's friends and some measure of political consistency."

Harkin said anyone who joins a group, "a fraternity, a social organization, whatever it is, has to pledge to be part of the group."

Harkin said he had not intended to attack Zorinsky personally.

"Actually, I find Ed a rather enjoyable individual, as I do his wife," Harkin said.

"I am sorry that Ed has seen fit to make this a personal attack on me. I have tried to make this only a matter of saying, which party does someone want to be in?"



CURRENT STATE OF THE PORK INDUSTRY

\*YOU CANNOT FIND AN UNHAPPY HOG FARMER IN IOWA\*

KEY MARKET INDICATORS:

--	AVERAGE MARKETPRICE (YEAR TO DATE)	<u>1990</u>	<u>1989</u>
		\$52-\$58	\$44
--	7-MARKET PRICE	<u>SEPT., 89</u>	<u>APRIL, 90</u>
			<u>MAY, 90</u>
	*ON THE RISE*	\$44	\$54
			\$62
--	HOG:CORN PRICE RATIO	<u>CURRENT</u>	<u>1989</u>
		24.6	18

\*\* THIS RATIO OF HOG PRICES TO CORN PRICES REFLECTS THE TREMENDOUS STRENGTH IN THE HOG MARKET. CORN PRICES HAVE REMAINED STRONG, BUT THE RISING HOG MARKET HAS BEEN GREATER AND ALLOWED THE RATIO TO CLIMB.

\*\* THE HIGHER THE RATIO, THE HIGHER THE RETURNS TO PRODUCERS.

CURRENTLY RIDING HIGH ON A PRICE INCREASE THAT STARTED LAST FALL. HOG PRICES IN DES MOINES REACHED AN ALL-TIME HIGH OF \$68 LAST WEDNESDAY.

<u>TRADE:</u>	<u>JANUARY - MARCH</u>	<u>1990</u>	<u>1989</u>
EXPORTS		69 MILLION LBS.	55 MILLION LBS.
IMPORTS		212 MILLION LBS.	251 MILLION LBS.

\*\* CURRENT TRADE FIGURES REPRESENT AN IMPROVEMENT IN THE BALANCE OF TRADE.

EXPORT NUMBERS HAVE BENEFITTED FROM LARGE FOOD-AID SHIPMENTS TO POLAND.

MARKET ANALYSTS ARE LOOKING AT THE CONSISTENT STRENGTH IN THE MARKET AND ATTEMPTING TO PREDICT WHEN AN EXPANSION IN HERD SIZE WILL BEGIN. SEVERAL SOURCES DO NOT EXPECT TO SEE EXPANSION UNTIL THE END OF THE YEAR, AND THEN THE EFFECT-OF PRODUCERS HOLDING BACK BREEDING HERD REPLACEMENTS SHOULD CONTINUE THE STRONG MARKET.

RETAIL SALES WILL PROBABLY NOT SUPPORT PRICES IN THE UPPER \$60'S. AT THESE PRICES, RETAIL PRODUCT HAS BEEN MOVING SLOWLY, AND SLAUGHTER PRICES WILL PROBABLY BACK OFF CURRENT LEVELS TO MAINTAIN MARKET DEMAND STRENGTH.



NATIONAL PORK PRODUCERS COUNCIL (NPPC)  
POSITION UPDATE

NPPC SUPPORTS AMENDMENT FOR HIGH AND VALUE-ADDED PRODUCTS

- \*\* CURRENTLY, LESS THAN 2% OF U.S. PORK PRODUCTION IS EXPORTED. NPPC IS SUPPORTIVE OF THE SENATE AG COMMITTEE'S PROVISION OF 10% OF EEP FUNDS EARMARKED FOR VALUE-ADDED PRODUCTS.

INTEGRATED RESOURCE MANAGEMENT (IRM) ASSISTS PORK PRODUCERS

- \*\* "IRM" WOULD BE A PROGRAM OPERATED BY USDA, PROVIDING INFORMATION TO LIVESTOCK PRODUCERS THAT WILL ASSIST THEM IN MAKING BUSINESS DECISIONS BASED ON INFORMATION FROM MANY DIFFERENT DISCIPLINES (NUTRITION, FINANCES, ANIMAL HEALTH, ETC)

NPPC SUPPORTS RETAINING THE INDEPENDENCE OF CFTC

SENATE VERSION OF USDA SEAFOOD INSPECTION ENCOURAGES CONSISTENCY

- \*\* NPPC SUPPORTS USDA OPERATION OF THE SEAFOOD INSPECTION PROGRAM, IN THAT INSPECTION WILL BE CONSISTENT WITH OTHER MEATS AND FEDERAL INSPECTION LAWS WOULD PRECLUDE STATE LAWS.

NPPC SUPPORTS ANIMAL FACILITY PROTECTION ACT

- \*\* THIS BILL (CURRENTLY IN THE HOUSE) WOULD PROVIDE PROTECTION AGAINST VIOLENT ACTS COMMITTED IN THE NAME OF ANIMAL RIGHTS.

NPPC SUPPORTS PSEUDORABIES FUNDING

- \*\* THE PSUEDORABIES ERADICATION AND CONTROL PROGRAM IS A TOP PRIORITY FOR MOST PRODUCERS.



*Senator*

FINAL DRAFT  
5/31/90

SENATOR DOLE SCHEDULE - IOWA

FRIDAY, JUNE 1

11:00 AM      Lv. Washington National  
Butler Aviation  
703/549-8340

NOTE: PLEASE LEAVE AS SOON AS POSSIBLE, AS THE SCHEDULE IN IOWA IS  
EXTREMELY TIGHT.

MANIFEST: Senator Dole  
Clarkson Hine  
Mike Glassner

AIRCRAFT: RELCO (American Financial)  
Falcon 50 - Tail No. 5DL  
Seats 10 + Jump seat  
PHONE: QM40500-077

PILOTS: Tom McGeehan and Mike Railton  
513/579-2121 or 871-0848

CONTACT: Mary Lynn Webb  
513/579-2121  
513/579-2580 (FAX)

FLIGHT TIME: 2 hrs 10 min.  
TIME CHANGE: -1 hr  
MEAL SERVICE: COFFEE, JUICE & DANISH

12:10 PM      Ar. Des Moines, Iowa  
FBO: Elliot Beechcraft  
515/285-6551

MET BY: Sara Rickert  
Iowans for Tauke  
515/282-1990  
or 800/373-1990

ADVANCE: Sara Rickert

12:15 PM-      Proceed by auto to:  
12:20 PM

12:25 PM-      PHOTO OPPORTUNITY WITH TAUKE MAJOR DONORS  
12:35 PM      The Bohemian Club  
Capital Square, 400 Locust  
515/288-5748



PAGE TWO

FRIDAY, MAY 31 (CONTINUED)

12:40 PM- ATTEND/ADDRESS FUNDRAISING LUNCHEON FOR TOM TAUKE  
1:00 PM The Bohemian Club  
Capital Square, 400 Locust  
515/288-5748

HOST COMMITTEE:

Bill and Corky Classen  
Bob and Sharon Dee  
Robb Kelley  
Gary Kirke  
Hal and Marabel Manders  
Larry and Jean Miller  
Dean Mitchell  
Dale Nelson  
Fred and Linda Nesbit  
Daniel Ochylski  
John Ruan  
Donald Runger  
Mel Straub

CROWD SIZE: 50  
TICKET PRICE: \$500 per person  
PRESS: CLOSED  
PODIUM AND MIKE

PROGRAM: John Ruan introduces Congressman Tauke  
Congressman Tauke introduces Senator Dole  
SENATOR DOLE REMARKS - 10-15 minutes

CONTACT: Tom Synhorst or Chip Gately  
515/282-1990 (O)  
515/282-0610 (FAX)  
Tom: 515/279-7730 (H)

1:05 PM- Motor to Airport  
1:15 PM

1:20 PM- PRESS CONFERENCE  
1:40 PM Elliott Beechcraft Lobby  
515/285-6551

1:40 PM Depart Des Moines

FLIGHT TIME: 20 minutes  
MANIFEST: Senator Dole  
Congressman Tauke  
Clarkson Hine  
Mike Glassner  
Tom Synhorst



PAGE THREE

FRIDAY, JUNE 1 (CONTINUED)

2:00 PM        Ar. Mason City, Iowa  
                 Municipal Airport  
                 Dwyer Aircraft Sales  
                 515/423-6453

ADVANCE:    Clay Tenquist  
                 525/282-1990

2:00 PM-       Drive Time  
2:20 PM

2:20 PM-       ATTEND/ADDRESS MASON CITY RECEPTION  
2:45 PM       Home of Jack & Margaret MacNider  
                 Taylor Hill, Mason City  
                 515/423-3316

HOST:        Jack and Margaret MacNider  
FORMAT:      Informal Stand-up Reception  
                 ("Mix and Mingle")  
                 Attendance: 80  
                 \$250 per couple  
                 PRESS: CLOSED  
                 Podium and Mike

PROGRAM:    Jack MacNider introduces Tom Tauke  
                 Tom Tauke introduces Senator Dole  
                 SENATOR DOLE REMARKS - 10 minutes

2:45 PM-       Drive Time to Airport  
2:55 PM

3:00 PM        Lv. Mason City  
                 FLIGHT TIME: 2 hours 40 minutes  
                 MANIFEST:    Senator Dole  
                        Clarkson Hine

6:40 PM        Ar. Washington, D.C.  
                 Butler Aviation  
                 703/549-8340

PROCEED TO SOVIET EMBASSY FOR DINNER



*Senator*

NOTE: SCHEDULE IS CURRENT AS OF 4:00 P.M. THURSDAY. CHANGES WILL BE MADE, IF JUDY KAY IS SUCCESSFUL IN FINDING OTHER ACTIVITIES IN SOUTHEAST KANSAS OR JOHNSON COUNTY TO DO ON THE WAY TO WICHITA SUNDAY.

DRAFT #4  
5/31/90

SENATOR BOB DOLE SCHEDULE - KANSAS

SUNDAY, JUNE 3

4:30 PM           Lv. Washington National en route Wichita, Kansas  
FBO: Butler Aviation  
703/549-8340

AIRCRAFT: CONAGRA Lear 35  
TAIL NO.: N823CA  
PILOTS: \_\_\_\_\_

Hangar: 402/978-4550

MANIFEST: Senator Dole  
Greg Schnacke (one-way only)  
Sara Belden

FLIGHT TIME: 3 hours  
TIME CHANGE: -1 hour

CONTACT: Paul Korody  
202/223-5115  
FAX: 223-5118  
Mary Robbins, AA to Mike Harper  
402/978-4041 (O)  
402/339-1846 (H)  
FAX: 402/978-4452

6:30 PM           Arrive Wichita, Kansas - Jabara Airport  
Midwest Corporate Aviation  
316/636-9700

MET BY: Mike Glassner  
316/263-4956 (O)  
316/264-7219 (H)

NOTE: Greg Schnacke will proceed directly to Salina, and  
can be reached at the Holiday Inn Holidome  
913/823-1739



PAGE TWO

SUNDAY, JUNE 3 (CONTINUED)

6:35 PM Depart Jabara Airport en route Wichita Country Club

DRIVE TIME: 5-10 minutes

6:45 PM Arrive Wichita Country Club  
316/682-5566

ATTEND DOLE FOR SENATE '92 EVENT

6:30 PM Cocktails

7:15 PM Dinner

CONTACT: Jordan Haines  
316/261-4311  
(Ann Brady, Exec. Asst.)

ATTENDEES: George Ablah  
Brian Barents  
Bob Beren  
Mike Cutchall  
Tom Clevenger  
Joe Doolittle  
Jordan Haines  
Harvey Jabara  
Larry Jones  
Charles Koch  
Bob Newton  
Jack Ranson  
Pat Ranson  
Carl Sebits  
Ken Wagnon  
Bill Wohlford  
Jack DeBoer  
Don Sbarra  
Dick Smith  
Kim Wells

FORMAT: Informal social event  
4 tables combined as one

RON: Wichita Marriott  
316/651-0333

MONDAY, JUNE 4

7:30 AM Fundraising Breakfast - Sedgwick County GOP  
Wichita Marriott - Ballroom  
9100 East Corporate Hills Drive  
316/651-0333



PAGE THREE

MONDAY, JUNE 4 (CONTINUED)

HOSTS: Clark Owens, SG County Chairman  
(Law ofc: 316/265-1844)  
Jan Henrie Fry, County Vice Chair

CONTACT: Jan Henrie Fry  
316/721-3645 (H)  
316/264-VOTE (Hqtrs)

NOTE: Jan will arrive at the hotel at 6:30 AM

CROWD SIZE: 200-250 (estimate)

TICKET PRICE: \$25

PRESS: OPEN

TABLE-TOP PODIUM AND MIKE

FORMAT: Rounds of 8

HEAD TABLE: Senator Dole  
Governor Hayden  
Patti Hayden (?)  
Jack Ranson  
Clark Owens, SG Co. Chairman  
Jan Henrie Fry, SG Co. Vice-Chair  
Majority Leader Robert Miller  
Mike Haggard, Pachyderm Club Chairman  
Jerry Threllfall, SG Women's Volunteer

PROGRAM: Prayer  
Salute to Flag  
Brief welcome and introductions  
Jan Fry introduces Senator Dole  
REMARKS - SENATOR DOLE  
Closing Remarks - Governor Hayden

NOTE: Photographer will be present to take pictures with Senator, Governor and candidates

8:30 AM Depart Marriott en route Koch Industries

8:45 AM Arrive Koch Industries, Inc.  
4027 East 37th Street North - BUILDING D  
(SEE MAP - Hillside closed from 21st Street North  
to 37th Street North)  
316/832-5203 (Charles Koch's Ofc.)

MET BY: Lee Abdnor

ATTEND GROUNDBREAKING CEREMONIES FOR EXPANSION  
OF KOCH INDUSTRIES' CORPORATE HEADQUARTERS

8:30 AM VIP Reception - Building D

PAGE FOUR

MONDAY, JUNE 4 (CONTINUED)

9:00 AM- GROUND-BREAKING CEREMONY PROGRAM  
9:30 AM (In triangle betw. Bldg. D, Construction Site and Building B)

(BRIEF remarks by the following)  
William W. Hanna, Pres. & CEO, Koch  
Don Cordes, Exec. V.P., Legal/Corp. Affairs  
Brian Johnson, Chairman of WISE  
SENATOR DOLE  
Senator Kassebaum (Telegram to be read)  
Congressman Dan Glickman  
Governor Mike Hayden  
Wichita Mayor Bob Knight  
Mark Schroeder, Chairman of SG County Commission  
Charles Koch, Chairman and CEO, Koch Industries  
David H. Koch, Exec. V.P., Koch Industries  
CROWD: 1700 Koch Wichita employees  
300 invited guests and press

9:30 AM Ground-Breaking

(Charles Koch will speak briefly to the press)

9:45 AM SENATOR DOLE and CHARLES KOCH proceed to BUILDING B  
Charles Koch's Office  
316/832-5203

PRIVATE MEETING - Senator Dole and Charles Koch

CONTACT: Lee Abdnor  
202/408-1230

10:15 AM Depart Koch Industries en route Jabara Airport

DRIVE TIME: 15 minutes

10:30 AM Arrive Jabara Airport  
Midwest Corporate Aviation  
316/636-9700

10:32 AM Depart Wichita

FLIGHT TIME: 30 minutes

MANIFEST: Senator Dole  
Mike Glassner  
Sara Belden



PAGE FIVE

MONDAY, JUNE 4 (CONTINUED)

11:02 AM Arrive Salina, Kansas - Municipal Airport  
Moore's Midway Aviation  
913/825-6261

MET BY: Randy Duncan, Saline Co. GOP Chair  
913/825-8859

11:05 AM Depart Moore's Midway Aviation en route  
Bicentennial Center

11:15 AM Arrive Bicentennial Center  
North Door

Proceed to office of Office Manager and Event  
Coordinator, Karen Fecteau, nearby the North Door  
and Flags.

913/823-2295

Karen will escort you to back-stage star dressing  
room, which is being made available for your use as  
holding room or office during your stay at  
conference. Restroom facilities and telephone.

NOTE FOR MIKE GLASSNER: This room is locked at all  
times, and can only be entered by combination lock.  
Karen will give you the combination on your  
arrival.

TIME PERMITTING:

PRIVATE MEETING

Merle Miller, Belleville Telescope  
Re Highway 81 Expansion  
(He will look for Senator or Greg Schnacke)  
913/527-2244

NOTE: He is bringing in a delegation to  
"demonstrate" at the Conference on behalf of this  
project; therefore, cannot meet at airport.

Time Permitting: Wander through the Trade Fair  
exhibits (open at 10:00)

NOTE: Rita Reilly will also attend Conference  
and available for whatever staff needs arise

PAGE SIX

MONDAY, JUNE 4 (CONTINUED)

11:30 AM            Opening Luncheon - Economic Development Conference  
                    Bicentennial Center

12:15 PM            (Approx.) - KEYNOTE:    Nancy Kassebaum

12:40 PM            TENTATIVE - JOINT PRESS CONFERENCE  
                    SENATORS DOLE & KASSEBAUM AND GOVERNOR HAYDEN

1:10 PM-            Plenary Session - Developing Kansas Communities  
1:40 PM            in the '90's  
                    (KEYNOTE:    Pat Roberts)  
                    (Moderator:    Rochelle Chronister)

1:30 PM            Depart Economic Development Conference and  
                    Arrive Back-stage Star Dressing Room

1:40 PM-            PRIVATE MEETING  
2:00 PM            Dean Evans  
                    913/827-4484 (Betty Garrison)

2:00 PM            Depart Bicentennial Center

2:15 PM            Arrive Moore's Midway Aviation  
                    913/825-6261

2:20 PM            Depart Salina en route Topeka  
  
                    FLIGHT TIME:    45 minutes  
  
                    MANIFEST:    Senator Dole  
                                Sara Belden  
                                Mike Glassner

3:05 PM            Arrive Topeka, Kansas  
                    Philip Billard Municipal Airport  
                    T. J. Terminals  
                    913/234-2602  
  
                    MET BY:    Judy Kay

3:10 PM            Depart Billard Airport en route Hayden Headquarters

3:25 PM            Arrive Topeka Hqtrs, Hayden for Governor  
                    214 West 6th  
                    913/234-6453



PAGE SEVEN

MONDAY, JUNE 4 (CONTINUED)

3:30 PM- ATTEND HEADQUARTERS OPENING  
4:00 PM

CONTACT: John Pinegar, Campaign Manager  
913/234-6453

(OPEN TO THE PRESS)  
4:00 PM Depart Hayden Headquarters en route Billard Airport

4:15 PM Arrive Billard Airport, T.J. Terminals  
913/234-2602

4:20 PM Depart Topeka en route Johnson County

FLIGHT TIME: 30 minutes

MANIFEST: Senator Dole  
Sara Belden  
Mike Glassner

4:50 PM Arrive Kansas City, Missouri  
Downtown Airport (MKC)  
Executive Beechcraft  
816/842-8484

MET BY: Gale Grosch

4:55 PM Kansas City Downtown Airport

DRIVE TIME: 10 minutes

5:05 PM Arrive Hayden for Governor Fundraiser  
Home of Mr. and Mrs. Michael Merriman  
6435 Indian Lane, Mission Hills, Kansas  
913/362-1223 (H)  
816/391-2006 (O)

500 invitations mailed -- \$1,000 per couple  
Expect 30 in attendance  
Target: Insurance & Investment Bankers  
Closed to the Press

PROGRAM:

5:30 PM Mr. Merriman introduces Governor Hayden  
Governor Hayden introduces Senator Dole  
SENATOR DOLE - REMARKS

CONTACT: Kathy Peterson  
913/234-6453

PAGE EIGHT

MONDAY, JUNE 4 (CONTINUED)

6:00 PM            Depart Merriman residence en route airport  
                  DRIVE TIME: 15 minutes

6:15 PM            Arrive Olathe, Kansas  
                  Johnson County Executive Airport  
                  Kansas City Aviation  
                  913/782-0530

6:20 PM            Depart Johnson County, Kansas en route Washington  
                  MANIFEST: Senator Dole  
                              Sara Belden  
                  FLIGHT TIME: 2 hours 15 minutes  
                  TIME CHANGE: +1 hour

9:35 PM            Arrive Washington, D.C., National Airport  
                  Butler Aviation  
                  703/549-8340  
                  PROCEED TO PRIVATE



P.3/6

MAY 30 '90 13:24 202 408-1182/KII-WDC

Page 28 of 85

Use 4027 Address Entrance

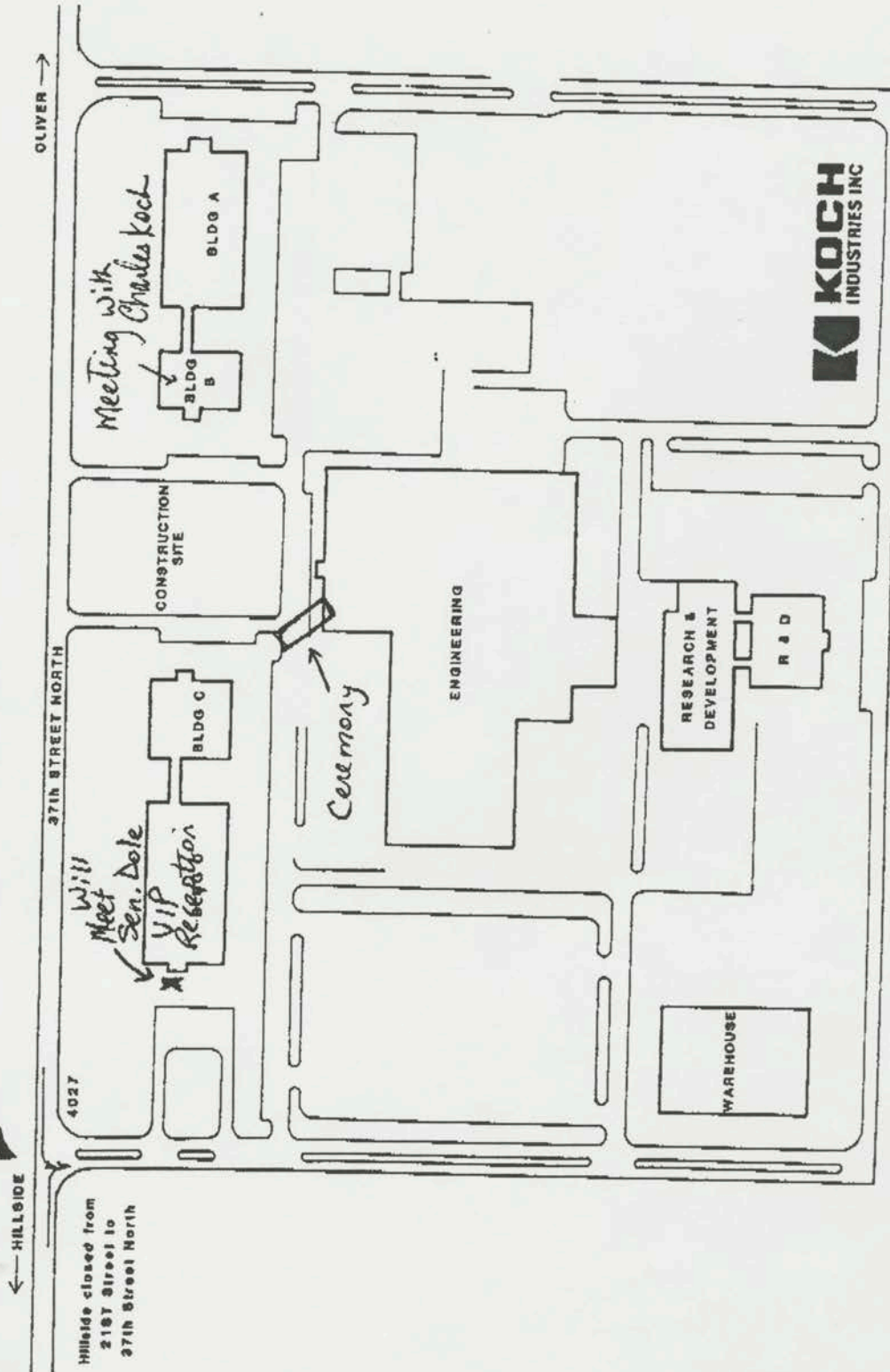

National Pork Producers Council

# CAPITOL CONNECTION

*Strengthening  
the voice of America's  
Pork Producers  
in Washington, D.C.*







# The Pork Producers' CAPITOL CONNECTION

## What Is The "Capitol Connection" Program?

- ★ The National Pork Producers Council's (NPPC) "Capitol Connection" Program creates a core group of politically-oriented, issue active producers to join together in helping to strengthen the voice of pork producers in Washington, D.C.
- ★ Annual dues are \$100 which compares with the price of one market hog.
- ★ This is *not* a Political Action Committee and no funds will be spent to support the election of candidates to public office.
- ★ These funds will be invested in high priority public policy issues which cannot be funded with checkoff dollars.
- ★ Allied industry and other friends are invited to join with producers in this important effort.
- ★ Interested producers may also serve in NPPC's key person legislative contact program.

## Why Are Capitol Connection Funds Needed?

- ★ Most national organizations have a presence in Washington to tell their story. It's important that pork producers' views are both heard and duly considered by government decisions-makers.
- ★ Past NPPC Washington efforts have paid producers great dividends, including:
  - winning a countervailing duty on subsidized Canadian hogs
  - sending U.S. pork bellies to Poland
  - increasing government pork purchases
  - obtaining withdrawal of the USDA bill-back proposal

- increasing government pork research funding
- providing easier access to Washington's centers of congressional, regulatory and political power
- ★ The coming decade brings to the national agenda a whole new slate of industry issues.
- ★ Capitol Connection funds will help assure that when NPPC leaders and staff talk on producers behalf, the right people listen.

## How Will These Funds Be Used?

- ★ To help effectively represent producers' views on public policy issues such as:
  - Animal Rights
  - Biotechnology
  - Disease Control
  - Environment
  - Farm Credit
  - Food Safety
  - General Farm Legislation
  - Government Pork Purchases
  - International Trade
  - Nutrition, Diet, Health
  - Research
  - Taxation
- ★ To help finance the NPPC Washington office operations.
- ★ To assure an effective, daily presence at USDA, in the halls of Congress and at the White House.

## Why Should I Get Involved?

- ★ Members of Congress represent 250 million people, while America's pork producers represent less than one-tenth of one percent of the U.S. population — about 200,000 people.
- ★ That means producers need a high degree of involvement in order to make sure government decision-makers hear their voice on important issues.
- ★ By joining the Capitol Connection, you can help shape public policy in the best interests

of pork producers and help determine our industry's future direction.

## Will Issues Important To Pork Producers In My State Be Addressed?

- ★ \$20 of your \$100 dues will be returned to your home state association to help meet state non-checkoff needs.

## Your Benefits!

- ★ You will receive an exclusive Capitol Connection newsletter which will feature an inside Washington analysis of issues important to the pork industry and U.S. Agriculture.
- ★ You will be provided a Capital Connection Public Policy Handbook which details NPPC's specific views on important public policy. The handbook will be updated to keep you abreast of changing legislative and regulatory matters and will enable you to discuss pork industry issues with your U.S. Senators and Representative.
- ★ You will provide valuable input into industry programs by participating in issue priority surveys.
- ★ You will gain the satisfaction of helping to influence governmental policies affecting the economic well-being of producers and the pork industry.
- ★ Your name will be listed on a Capitol Connection Honor Roll Plaque on permanent display in the NPPC Washington office.
- ★ NPPC will send a letter to your U.S. Senators and Representative to notify them of your active participation in the Capitol Connection program.



## Join The Capitol Connection Today!

Tear off and send in this attached card, along with your check for \$100 today. Please encourage other pork producers to help the pork industry by joining. Together, we can strengthen the voice of America's pork producers in Washington, D.C.

Please make check payable to: National Pork Producers Council

Send to: National Pork Producers Council  
P.O. Box 10383  
Des Moines, Iowa 50306

NAME: \_\_\_\_\_

ADDRESS: \_\_\_\_\_

CITY: \_\_\_\_\_

STATE: \_\_\_\_\_ ZIP: \_\_\_\_\_

TELEPHONE: (       ) \_\_\_\_\_

YOUR U.S. REPRESENTATIVE: \_\_\_\_\_

This certifies that I have joined the National Pork Producers Council's "Capitol Connection." I understand that my annual dues are effective from July 1 to June 30.

Signature \_\_\_\_\_

Date \_\_\_\_\_

Contact your tax consultant to determine if your contribution can be deductible as a business expense. It is not deductible as a charitable contribution.

## 12 Reasons why America's Pork Producers need a stronger voice in Washington D.C. during the 1990's.

- ★ Animal Rights
- ★ Biotechnology
- ★ Disease Control
- ★ Environment
- ★ Farm Credit
- ★ Food Safety
- ★ General Farm Legislation
- ★ Government Pork Purchases
- ★ International Trade
- ★ Nutrition, Diet, Health
- ★ Research
- ★ Taxation



**National Pork Producers Council**  
Box 10383, Des Moines, Iowa 50306  
515/223-2600



FINAL  
6/1/90

SENATOR BOB DOLE SCHEDULE - KANSAS

SUNDAY, JUNE 3

1:00 PM

Lv. Washington National en route Des Moines, Iowa  
FBO: Butler Aviation  
703/549-8340

AIRCRAFT: CONAGRA Lear 35  
TAIL NO.: N823CA  
PILOTS: Steve Walling  
402/496-3889 (H)  
Bruce Clark  
402/498-8405 (H)  
Hangar: 402/978-4550

MANIFEST: Senator Dole  
Greg Schnacke (one-way only)  
Sara Belden

FLIGHT TIME: 2 hrs 15 min  
TIME CHANGE: -1 hour  
MEAL SERVICE: Lunch

CONTACT: Paul Korody  
202/223-5115  
FAX: 223-5118  
Mary Robbins, AA to Mike Harper  
402/978-4041 (O)  
402/339-1846 (H)  
FAX: 402/978-4452  
Chief Pilot: Jim Hollenbeck  
402/978-4159

2:15 PM

Ar. Des Moines, Iowa  
Elliot Beechcraft  
515/285-6551

CONTACT: Gordon Paulsen  
515/282-1990

MET BY: John Swanson

Motor to Iowa State Fairgrounds

DRIVE TIME: 20 minutes

PAGE TWO

SUNDAY, JUNE 3 (CONTINUED)

2:35 PM Ar. Iowa State Fairgrounds - North Entrance  
MET BY: Congressman Tom Tauke  
Kirk Farrell, Exec. Dir., National Pork  
Producers Council  
Don Gingerich, Past President, National  
Pork Producers

Proceed via golf carts to MEDIA CENTER

2:45 PM PRESS CONFERENCE  
SENATOR DOLE AND CONGRESSMAN TAUKE

3:15 PM Don Gingerich and Kirk Farrell will conduct  
Senator Dole and Congressman Tauke on tour of

WORLD PORK EXPO

(including the "barbecue-lossal" -- a 300 foot  
barbecue pit where they are cooking pork)

SENATOR DOLE AND CONGRESSMAN TAUKE TO WORK  
THE FOOD LINE

4:45 PM Meet with pork industry political  
leaders (NPPC Pork PAC)  
WALNUT STAGE

5:00 PM Depart Iowa State Fairgrounds en route airport

5:25 PM Arrive Elliot Beechcraft  
515/285-6551

5:30 PM Depart Des Moines

FLIGHT TIME: 1 hour

6:30 PM Arrive Wichita, Kansas - Jabara Airport  
Midwest Corporate Aviation  
316/636-9700

MET BY: Mike Glassner  
316/263-4956 (O)  
316/264-7219 (H)

NOTE: Greg Schnacke will proceed directly to Salina, and  
can be reached at the Holiday Inn Holidome  
913/823-1739



PAGE THREE

SUNDAY, JUNE 3 (CONTINUED)

6:35 PM Depart Jabara Airport en route Wichita Country Club

DRIVE TIME: 5-10 minutes

6:45 PM Arrive Wichita Country Club  
316/682-5566

ATTEND DOLE FOR SENATE '92 EVENT

6:30 PM Cocktails

7:15 PM Dinner

CONTACT: Jordan Haines  
316/261-4311  
(Ann Brady, Exec. Asst.)

ATTENDEES: George Ablah  
Brian Barents  
Bob Beren  
Tom Clevenger  
Mike Cutchall  
Jack DeBoer  
Joe Doolittle  
Jordan Haines  
Harvey Jabara  
Larry Jones  
Charles Koch  
Bob Newton  
Jack Ranson  
Pat Ranson  
Don Sbarra  
Carl Sebits  
Dick Smith  
Ken Wagnon  
Kim Wells  
Bill Wohlford

FORMAT: Informal social event  
4 tables combined as one

RON: Wichita Marriott  
316/651-0333

PAGE FOUR

MONDAY, JUNE 4

7:30 AM

Fundraising Breakfast - Sedgwick County GOP  
Wichita Marriott - Ballroom  
9100 East Corporate Hills Drive  
316/651-0333

HOSTS: Clark Owens, SG County Chairman  
(Law ofc: 316/265-1844)  
Jan Henrie Fry, County Vice Chair

CONTACT: Jan Henrie Fry  
316/721-3645 (H)  
316/264-VOTE (Hqtrs)

NOTE: Jan will arrive at the hotel at 6:30 AM

CROWD SIZE: 200-250 (estimate)  
TICKET PRICE: \$25  
PRESS: OPEN  
TABLE-TOP PODIUM AND MIKE  
FORMAT: Rounds of 8

HEAD TABLE: Senator Dole  
Governor Hayden  
Patti Hayden (maybe)  
Jack Ranson  
Clark Owens, SG Co. Chairman  
Jan Henrie Fry, SG Co. Vice-Chair  
Majority Leader Robert Miller  
Mike Haggard, Pachyderm Club Chairman  
Jerry Threllfall, SG Women's Volunteer

PROGRAM: Prayer  
Salute to Flag

Brief welcome and introductions:  
Jan Fry introduces Senator Dole  
REMARKS - SENATOR DOLE  
Closing Remarks - Governor Hayden

NOTE: Photographer will be present to take  
pictures with Senator, Governor and candidates

8:30 AM

Depart Marriott en route Koch Industries

8:45 AM

Arrive Koch Industries, Inc.  
4027 East 37th Street North - BUILDING D  
(SEE MAP - Hillside closed from 21st Street North  
to 37th Street North)  
316/832-5203 (Charles Koch's Ofc.)



PAGE FIVE

MONDAY, JUNE 4 (CONTINUED)

MET BY: Lee Abdnor

ATTEND GROUNDBREAKING CEREMONIES FOR EXPANSION  
OF KOCH INDUSTRIES' CORPORATE HEADQUARTERS

8:30 AM VIP Reception - Building D

9:00 AM- GROUND-BREAKING CEREMONY PROGRAM

9:30 AM (In triangle betw. Bldg. D, Construction Site and  
Building B) (SEE MAP ATTACHED)

(BRIEF remarks by the following)

William W. Hanna, Pres. & CEO, Koch

Don Cordes, Exec. V.P., Legal/Corp. Affairs

Brian Johnson, Chairman of WISE

SENATOR DOLE

Senator Kassebaum (Telegram to be read)

Congressman Dan Glickman

Governor Mike Hayden

Wichita Mayor Bob Knight

Mark Schroeder, Chairman of SG County Commission

Charles Koch, Chairman and CEO, Koch Industries

David H. Koch, Exec. V.P., Koch Industries

CROWD: 1700 Koch Wichita employees  
300 invited guests and press

9:30 AM Ground-Breaking

(Charles Koch will speak briefly to the press)

9:45 AM SENATOR DOLE and CHARLES KOCH proceed to BUILDING B  
Charles Koch's Office  
316/832-5203

PRIVATE MEETING:

SENATOR DOLE

CHARLES KOCH

DON CORDES

DAVID KOCH (maybe)

RICHARD FINK, V.P. for Public Affairs

CONTACT: Lee Abdnor  
202/408-1230

10:15 AM Depart Koch Industries en route Jabara Airport

DRIVE TIME: 15 minutes

PAGE SIX

MONDAY, JUNE 4 (CONTINUED)

10:30 AM Arrive Jabara Airport  
Midwest Corporate Aviation  
316/636-9700

10:32 AM Depart Wichita  
  
FLIGHT TIME: 30 minutes

MANIFEST: Senator Dole  
Mike Glassner  
Sara Belden

11:02 AM Arrive Salina, Kansas - Municipal Airport  
Moore's Midway Aviation  
913/825-6261

MET BY: Randy Duncan, Saline Co. GOP Chair  
913/825-8859

11:05 AM Depart Moore's Midway Aviation en route  
Bicentennial Center

11:15 AM Arrive Bicentennial Center  
North Door

Proceed to office of Office Manager and Event  
Coordinator, Karen Fecteau, nearby the North Door  
and Flags.

913/823-2295

Karen will escort you to back-stage star dressing  
room, which is being made available for your use as  
holding room or office during your stay at  
conference. Restroom facilities and telephone.

NOTE FOR MIKE GLASSNER: This room is locked at all  
times, and can only be entered by combination lock.  
Karen will give you the combination on your  
arrival.

TIME PERMITTING:

PRIVATE MEETING  
Merle Miller, Belleville Telescope  
Re Highway 81 Expansion  
(He will look for Senator or Greg Schnacke)  
913/527-2244



PAGE SEVEN

MONDAY, JUNE 4 (CONTINUED)

NOTE: Merle Miller is bringing in a delegation to "demonstrate" at the Conference on behalf of this project; therefore, cannot meet at airport.

Time Permitting: Wander through the Trade Fair exhibits (open at 10:00)

NOTE: Rita Reilly will also attend Conference and available for whatever staff needs arise

11:30 AM Opening Luncheon - Economic Development Conference  
Bicentennial Center

12:15 PM (Approx.) - KEYNOTE: Nancy Kassebaum

12:40 PM TENTATIVE - JOINT PRESS CONFERENCE  
(Dole/Kassebaum/Hayden/Roberts)  
(At Stage-Center)

1:10 PM- Plenary Session - Developing Kansas Communities  
1:40 PM in the '90's  
(KEYNOTE: Pat Roberts)  
(Moderator: Rochelle Chronister)

1:30 PM Depart Economic Development Conference and  
Arrive Back-stage Star Dressing Room

1:40 PM- PRIVATE MEETING  
2:00 PM Dean Evans  
913/827-4484 (Betty Garrison)

2:00 PM Depart Bicentennial Center

2:15 PM Arrive Moore's Midway Aviation  
913/825-6261

2:20 PM Depart Salina en route Topeka

FLIGHT TIME: 45 minutes

MANIFEST: Senator Dole  
Sara Belden  
Mike Glassner

3:05 PM Arrive Topeka, Kansas  
Philip Billard Municipal Airport  
T. J. Terminals  
913/234-2602

MET BY: Judy Kay

PAGE EIGHT

MONDAY, JUNE 4 (CONTINUED)

3:10 PM Depart Billard Airport en route Hayden Headquarters

3:25 PM Arrive Topeka Hqtrs, Hayden for Governor  
214 West 6th  
913/234-6453

3:30 PM- ATTEND HEADQUARTERS OPENING  
4:00 PM

CONTACT: John Pinegar, Campaign Manager  
913/234-6453

(OPEN TO THE PRESS)

4:00 PM Depart Hayden Headquarters en route Billard Airport

4:15 PM Arrive Billard Airport, T.J. Terminals  
913/234-2602

4:20 PM Depart Topeka en route Johnson County

FLIGHT TIME: 30 minutes

MANIFEST: Senator Dole  
Sara Belden  
Mike Glassner

4:50 PM Arrive Kansas City, Missouri  
Downtown Airport (MKC)  
Executive Beechcraft  
816/842-8484

MET BY: Gale Grosch

4:55 PM Depart Kansas City Downtown Airport

DRIVE TIME: 10 minutes

5:05 PM Arrive Hayden for Governor Fundraiser  
Home of Mr. and Mrs. Michael Merriman  
6435 Indian Lane, Mission Hills, Kansas  
913/362-1223 (H)  
816/391-2006 (O)

500 invitations mailed -- \$1,000 per couple  
Expect 30 in attendance  
Target: Insurance & Investment Bankers  
Closed to the Press



PAGE NINE

MONDAY, JUNE 4 (CONTINUED)

**PROGRAM:**

5:30 PM Mr. Merriman introduces Governor Hayden  
Governor Hayden introduces Senator Dole  
SENATOR DOLE - REMARKS

**CONTACT:** Kathy Peterson  
913/234-6453

6:00 PM Depart Merriman residence en route airport

**DRIVE TIME:** 15 minutes

6:15 PM Arrive Kansas City  
Downtown Airport  
Executive Beechcraft  
816/842-8484

6:20 PM Depart Kansas City en route Washington

**MANIFEST:** Senator Dole  
Sara Belden

**FLIGHT TIME:** 2 hours 15 minutes

**TIME CHANGE:** +1 hour

**MEAL SERVICE:** Dinner

9:35 PM Arrive Washington, D.C., National Airport  
Butler Aviation  
703/549-8340

**PROCEED TO PRIVATE**

P. 3/6

MAY 30 '90 13:24 202 408-1182/K11-WDC

Page 41 of 85

Use 4027 Address Entrance

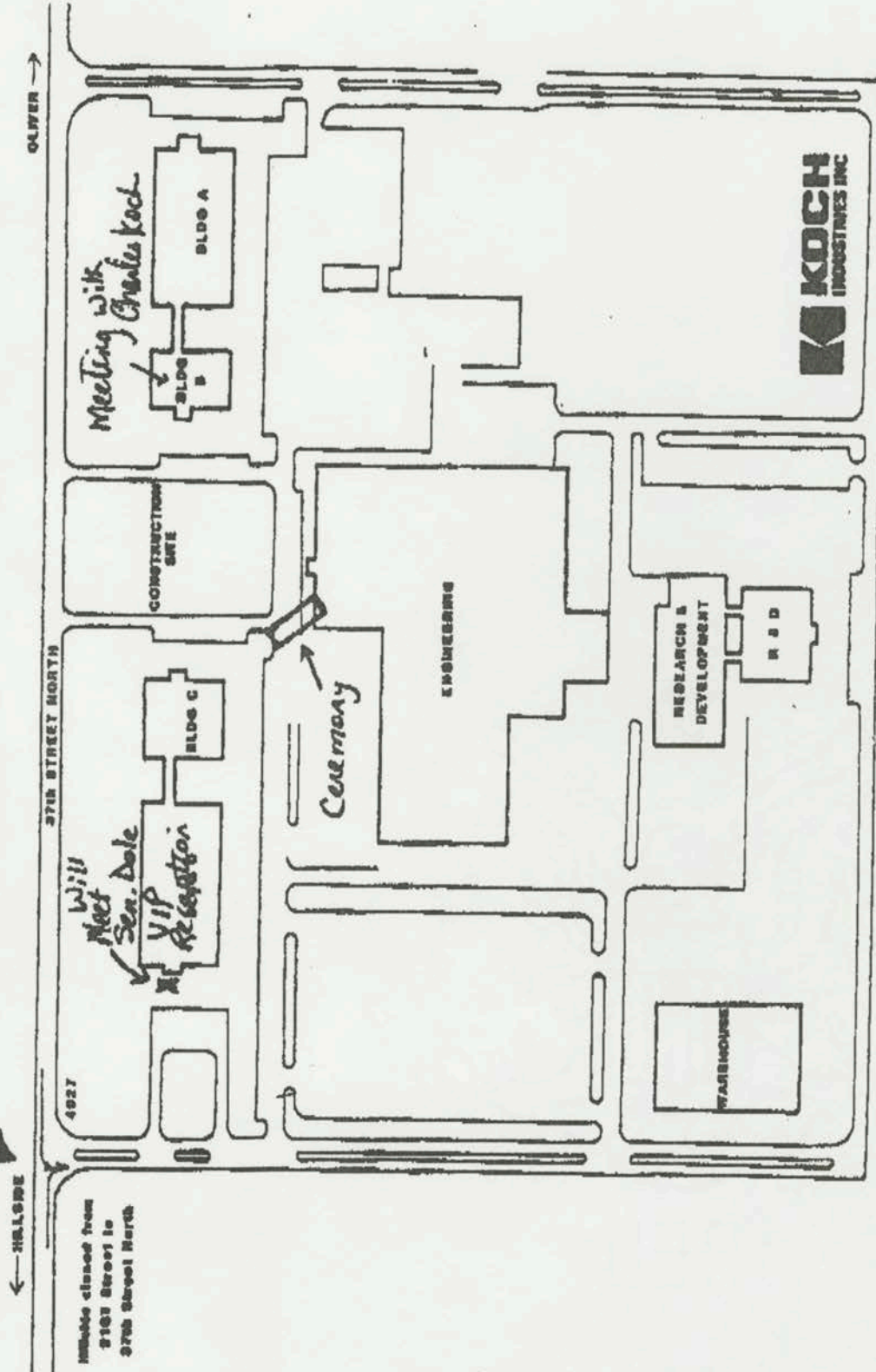



MEMORANDUM

JUNE 1, 1990

TO: SENATOR DOLE  
FROM: JO-ANNE  
SUBJ: NATIONAL PORK PRODUCERS EVENT IN IOWA

Attached for your information is a copy of the invitation that was sent to Tom Tauke for the Third Annual World Pork Expo this Sunday in Des Moines.

According to Tom Synhorst, this is indeed a "big deal" and it would be helpful for you to be there.

I believe the scheduler's handwritten notes on second page are self-explanatory, but in case not:

2:30       Tauke arrives State Fairgrounds  
2:30-       Tauke serves ribs and other barbecued pork products  
3:00       to the public at a huge charcoal grill  
3:00-       Tauke fires the gun to start one of the hourly  
3:15       pig races  
3:20-       Press event  
3:50  
3:55-       He returns to the charcoal grill to serve more ribs  
4:15  
4:30-       He meets with and makes remarks to pork industry  
5:30       political leaders (Pork PAC)

Total crowd expected for this 3-day event is 100,000, with 40,000 expected on Sunday.

Ample time to do this event and still get to Wichita in time for the dinner.

MAY 7 '90 14111

Don Gunglun 2021

TO 1315282061

PAGE.002



APR 27 1990

MAY 7 1990

## NPPC PORK PAC

P.O. Box 10383 • Des Moines, Iowa 50308 • Phone: (515) 223-2800

Kirk Farrell

April 20, 1990

Honorable Thomas J. Tauke  
United States House of Representatives  
Washington, D.C. 20515

Dear Representative Tauke:

On behalf of the National Pork Producers Council, I am pleased to extend you an invitation to attend our third annual World Pork Expo on June 3, 1990 at the Iowa State Fairgrounds in Des Moines, Iowa. World Pork Expo is the world's "picture window" on the U.S. pork industry. It's expected to attract nearly 100,000 people - pork producers, consumers, allied industry, news media and academia - to Des Moines for three days to see and hear what is new in the multi-billion dollar pork industry.

After last year's meeting in Springfield, Illinois, World Pork Expo is proud to return to Des Moines, Iowa for the next three years. It's estimated that for 1990, Expo's economic benefit to the greater Des Moines area will be nearly \$5 million dollars.

In three short years World Pork Expo has developed into an event of world class magnitude. We would be honored if you would attend and participate in one or all of the following VIP activities scheduled for June 3 from 12:00 Noon to 5:00 p.m.:

"Grill Master"

12:30-5:30

While the 300 feet long "Big Grill" is cookin' up pork ribs, shoulders and fresh ham, take your turn at greeting and serving some of the expected 40,000 hungry customers.

"Official Pig Races Starter"

Before a packed house of pork producers, raise the gun and start the world's most famous pig races.

(family)

"Honorary Hog Show Ringman"

Show off your sale ring skills at the nation's premiere hog show.

"NPPC PAC Reception"

Wrap up your Expo day with a visit and short remarks to pork industry political leaders at 4:45 p.m.

2:30  
Meet at North entrance  
Admin Bldg. - meet Don

Walnut Stage

2110



MAY 7 '90 14:12

TO 1515282061

PAGE.003

To make sure that you feel right at home, a producer leader of the Iowa Pork Producers Association will escort you throughout your visit to World Pork Expo. Not only will Expo give you a firsthand look at what's happening in the pork industry, but you'll have a chance to visit with literally hundreds of Iowans. In addition, over 100 farm broadcasters and news media from across Iowa and the country will be in attendance.

The National Pork Producers Council is ready to make whatever arrangements are necessary for you to attend World Pork Expo. Kirk Ferrell, Director of Special Projects, will be contacting your office to answer any questions you may have about Expo's VIP activities. We sincerely hope that you will join us at this year's exciting pork extravaganza.

Sincerely,

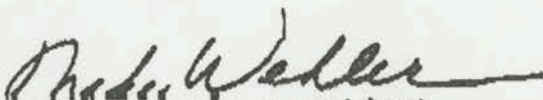

Mike Wahler, President  
National Pork Producers Council

2:30 - Tour meet Don Gingerich  
at Administration Bldg.

2:30-3:00 - Serve pork chops at  
"Big Grill"

3:00-3:15 - Start Pig race

3:20-3:50 Press

3:55-4:15 "Big Grill"

4:30-5:30 PAC Reception

MEMO  
TO: SENATOR DOLE  
FROM: TOM SYNHORST  
RE: RUAN/TAUKE REQUEST

Bush is coming to Iowa next Friday, June 8, to do a funder for Governor Branstad.

Ruan and Tauke have asked if Bush would do a 15 minute press conference announcing:

1. That the World Food Prize is being relocated in Iowa (Ruan is underwriting it)
2. Announce this year's recipient.

Until today, it looked as if they were going to do it.

Now the staff (Dave Carney) has said there is no time.

We know that there is time.

Tonight at dinner we would like you to ask the President to do this press conference for Tauke and Ruan.

#### Background

Bush has presented this award in the past.

Ruan and Iowa State University will be the new home for the foundation that processes the World Food Prize

Cooper Evans gave his approval to do the press conference

It could be that Branstad doesn't want any of his thunder stolen. Branstad will definitely be included in the press conference.

A letter of invitation is on file with the President (see attached)



IOWA

SENATOR HARKIN INTRODUCED LEGISLATION WITH SEVERAL OTHER SO-CALLED FELLOW "PRAIRIE POPULISTS" (KERREY, CONRAD, DASCHLE, EXON) THAT IS NOT ONLY BUDGETARILY IRRESPONSIBLE BUT ALSO CRUEL TO FARMERS.

IN MY OPINION, OFFERING PROPOSALS WITH ESCALATING TARGET PRICES, HIGHER LOAN RATES AND LARGE ARPs IS NOT ONLY BAD FARM POLICY BUT A CRUEL HOAX TO FARMERS. NON-COMPETITIVE LOAN RATES AND LARGE ACREAGE REDUCTION PROGRAMS HELP FOREIGN PRODUCERS GAIN MARKET SHARE, HURT OUR LIVESTOCK INDUSTRY (WHICH IS 50% OF GROSS RECEIPTS), AND PUNISH SMALL TOWNS IN RURAL AMERICA BY DOWNSIZING THE FARM ECONOMY. SOME OF THE PROPOSALS I HAVE HEARD ARE A THROW-BACK TO THE FAILED POLICIES OF THE PAST PROGRAMS THAT ARE DESIGNED TO ACHIEVE SHORT-TERM POLITICAL GAIN WHILE HURTING PRODUCERS LONG-TERM ECONOMIC WELL-BEING.

THEIR PROPOSAL INCLUDES HIGHER TARGET PRICES AND LOAN RATES WHICH SOUNDS GREAT AND PLAYS WELL TO FARMERS BUT IN REALITY IS NOT ACHIEVABLE. THE MONEY SIMPLY IS JUST NOT THERE.

IN THE CONSERVATION TITLE, SENATOR HARKIN INTRODUCED A GROUND WATER MANAGEMENT PLAN THAT WAS SIMILAR TO LEGISLATION THAT I INTRODUCED IN 1987 (ECARP). IN FACT, THIS CONCEPT WAS MADE PART OF MY EARLIER INTRODUCED LEGISLATION IN THIS YEAR'S FARM BILL.

## IOWA -- POLITICAL SCENARIO

### U.S. Senate Race

#### **POLLING:**

A poll commissioned by three Iowa television stations (KCCI-Des Moines, KGAN-Cedar Rapids, and KTIV-Sioux City) and conducted by Political-Media Research, Inc., shows Harkin leading Tauke by a mere 9-point margin (46% to 37%). Seventeen percent of Iowans surveyed were uncommitted.

Tauke's people contend that Harkin's dropping below 50% shows his vulnerability, while a Harkin spokesman maintained the sitting Senator's 17-point lead among Independents.

#### **SURROGATES:**

Tauke's campaign received an early boost from Clayton Yeutter in 1989. Also throughout the year, President Bush, Vice President Quayle, Secretary Sullivan, and Secretary Dole appeared. The Tauke campaign also has future commitments from Secretary Cavazos (June), Secretary Mosbacher (July), Secretary Brady (August), and Secretary Kemp. Iowa Native Son Cooper Evans will also appear.

#### **CAMPAIGN THEMES:**

Tauke is stressing his abilities as a coalition-builder in Congress -- as opposed to Harkin, who you'll recall gave a very strong statement in 1985 regarding your stand on portions of the Farm Bill. The character issue has worked well for Tauke -- and they're painting Harkin as accountable to influence peddlers. (90% of his fundraising money is from out-of-state donors).

#### **ISSUES TO STRESS:**

Tom Tauke is a friend to agriculture. The Harkin record is bad news for farmers, since he's beholden to special interests on both the East and West Coasts. (See specifics in Tauke campaign brief).

Also, Tauke has asked that you stress that if Harkin is defeated, Iowa won't lose a seat on the Senate Agriculture Committee -- since Harkin is fighting for agriculture interests outside of Iowa. Emphasize Tauke's futuristic ideas about agriculture. While you can't promise that Tauke will be a member of the Agriculture Committee once elected, you can stress Harkin's ineffectiveness in spite of his being an Agriculture Committee Member.

Let's let Iowa repeat history. No Democratic Senator has ever been elected to two consecutive terms in Iowa. With Grassley's popularity and strong reelection in 1986, with 66% of the vote, it's important for Iowa to stay on track -- by defeating Harkin and electing Tauke.



IOWA POLITICAL SCENARIO  
PAGE TWO

ISSUES TO AVOID:

Abortion. This issue is expected to play a significant role, with Tauke strongly pro-life and Harkin pro-choice. The National Abortion Rights Action League is spending thousands of dollars in an independent campaign against Tauke, although many Iowa radio and TV stations are refusing the air NARAL's advertisements due to their political content.

Americans With Disabilities Act. Harkin has already gotten a great deal of mileage out of his commitment to people with disabilities. However, Tauke's "innoculation strategy" involves the Grassley-Tauke amendment to the ADA, which extends the same protections for Congress. This was included in the House-passed version of the ADA.

Other Elections:

Gubernatorial. According to the poll cited above, the Democrat primary for Governor remains close, with Attorney General Tom Miller at 32%, and House Speaker Don Avenson at 27%. Former banker John Chrystal trails with 20%, and 21% are Undecided. The primary is next Tuesday, with the winner to face GOP Incumbent Governor Branstad.

Second C.D. With Tauke's seat open, there's a three-way race for the Republican nomination between Joe Ertl, Dr. Wayne Moldenhauer, and Jim Nussle. Steve Sovern and Eric Tabor will vie for the Democratic nod. Sovern ran against Tauke in 1980, and Tabor ran against him in 1986 and 1988.

Third C.D. Democrat Incumbent Rep. Dave Nagle will run against GOP challenger Jim Abbas.

Fourth C.D. Democrat Incumbent Rep. Neal Smith is unopposed.

ISSUE: HARKIN AND BOB DOLE

SUMMARY:

Bob Dole and Tom Harkin are not the best of friends.

- 1) In the Senate, though, the conventional wisdom has taken its toll on Harkin. The belligerence of his crusade for farmers and his crusade for farmers and against the Nicaraguan Contra rebels has jarred the nerves even of colleagues who agree with him, and alienated those who do not. His refusal to play by the rules is unsettling to many senators, who seem to see in him an attack on the network of mutual self-interest that keeps conflicts in the Chamber within manageable bounds. Harkin's effectiveness has suffered as a result. It did not help that, shortly after arriving in the Senate, he began lecturing his colleagues on farm problems in a way that implied they had scarcely heard of the issue before. Although he later toned down his rhetoric, he continued to clash with the leadership of both parties - especially with GOP leader Robert Dole, whose distaste for his farm-state neighbor has been evident on more than one occasion. Several times, Harkin has entered into confrontations with the leadership, only to discover that he had just a handful of allies backing him up." (Politics in America, 1990)
- 2) "DOLES SAY HARKIN VOTE HURTS REAGAN"  
(Cedar Rapids Gazette, 11/1/84)
- 3) "HARKIN'S MAIDEN SPEECH TURNS INTO CLASH WITH DOLE ON FARM AID"  
  
"He described Dole's resistance to farm credit legislation as 'terribly insensitive,' saying it is another indication that Dole has left Kansas and the farm belt 'completely.' The majority leader has an 'acute case of Potomac Fever. He forgot about what's going on in his home state. He owes his first loyalty there, not to the president.'" (Cedar Rapids Gazette, 2/20/85)
- 4) "Mr. President, I had not expected my first word offered in this Chamber would be to engage in polemics with the distinguished majority leader, but when I came to the floor I heard the distinguished majority leader say that he did not want us to engage in political games." (Tom Harkin, Congressional Record, 2/19/85)



MAY 23 '90 10:53 FROM IOWANS FOR DOLE

PAGE.007

- 5) "FARM BILL DEBATE MANIPULATIONS PUT HARKIN, DOLE AT ODDS WITH EACH OTHER"  
  
"I like the guy. he's bright. There are a lot of things I agree with him on. But I don't like the way he runs the Senate. As a majority leader he comes close to abuse of power.... And he doesn't understand that he's majority leader and it comes with the power. He can dish it out but he can't take it." (Tom Harkin, Cedar Rapids Gazette, 11/22/85)
- 6) "Dole, who has been feuding with Harkin throughout the eight month farm bill debate, said the referendum would not call for 'mandatory participation by farmers, but it did represent 'voluntary bankruptcy.'" (SENATE WRAPPING UP FARM BILL, Cedar Rapids Gazette, 11/23/85)
- 7) "HARKIN STINGS, DOLE ITCHES"  
(Des Moines Register, 11/26/85)
- 8) "BOB AND TOM..."  
  
"Harkin on occasion has ventured into Kansas for some Dole Bashing and Dole in the past hasn't been coy about his feelings toward Harkin..."  
(Des Moines Register, 3/9/86)
- 9) "HARKIN BLOCKS WORD CHANGE; DOLE ANGRY"  
(Spencer Daily Reporter, 3/11/86)
- 10) "FIGHT ANOTHER DAY"  
  
"...earlier this week, Senate rookie Tom Harkin of Iowa needlessly antagonized Dole over a trivial wording change in a non-binding 'sense of Congress' resolution accompanying a crucial farm bill. Such brashness Iowans don't need."  
  
"Harkin's actions remain worrisome on several counts. He seemed to be politicking and grandstanding. If he wasn't, Dole still saw it that way. 'We'll keep an eye on something he (Harkin) wants some day,' the majority leader vowed. (A lot of good that will do Iowans.)" (Cedar Rapids Gazette Editorial, 3/14/86)
- 11) "HARKIN: DOLE PLAN CRUSHES GRAIN TRADE, Ships That Stop In Cuba Would be banned in U.S." (Des Moines Register, 7/11/87)
- 12) "'We might as well shut our exports down,' he said Friday. He referred to the bill as the 'Bob Dole Grain Embargo Act of 1987.' 'It's obvious that Bob Dole is pandering to the right wing and hoping no one from the farm states, including his own, will notice,' said Harkin." (Cedar rapids Gazette, 7/11/87)

MAY 23 '90 10:54 FROM IOWANS FOR MORE

PAGE.008

- 13) "Harkin has the same problem with a guy like Bob Dole working the state showing some senators do more than pound crosses into Washington Parks for the TV cameras." (David Yepsen, "IOWA POLITICIANS ARE UPSTAGED BY CANDIDATES IN CAUCUS LIMELIGHT," Des Moines Register, 11/24/87)
- 14) "DOLE POLITICKS WHILE AG BILL WAITS: HARKIN"
- "We could pass this bill right now and send it to conference with the House. I resent this." (Tom Harkin, Cedar Rapids Gazette, 12/8/87)



Page 14

March 25, 1990

# IOWA

**TOM HARKIN**

**DEMOCRAT**

**RATING: Tough**

## Recent Senate Elections:

Percent	Democrat	Year	Republican	Percent
48	Dick Clark	1978	Roger Jepsen	51
48	John Culver	1980	Chuck Grassley	54
66	Tom Harkin	1984	Roger Jepsen	44
34	John Roehrik	1986	Chuck Grassley	66

## Democrat:

Tom Harkin—Incumbent

## Republican:

Tom Tauke—U.S. Representative (1)

## ANALYSIS:

More so than any other Senate race in the country, this one is the most fully engaged and the battle lines are clearly drawn. Anyone watching the battle between Harkin and Tauke comes away with the impression that both sides are running full throttle. Although Tauke has been the only candidate on the air thus far, the blows that have been exchanged over the course of the last several months are sufficient enough to provide a taste of what the balance of the campaign will be like. With debates likely to commence in April, the campaign will likely remain at this pace or more for the duration.

The war will be fought on at least two levels, character and commitment to the needs of Iowans. On the character front, Harkin is positioning himself as a tough, relentless fighter for Iowans who will pull out all the stops when battling for the state or for what he thinks is right. Harkin will likely use this as a means of defining his strength of character for the voters. Third parties will most likely be utilized to cast abortion as a character issue in an attempt to cast Tauke as someone who would inject his personal value structure on women in unfortunate circumstances.

Tauke will probably be portrayed as a fundamentally decent, caring man who seeks to see and solve problems without recklessly making accusations or determining his positions through the means of political expediency. His campaign will likely try to paint Harkin as a man who, when cornered, will say or do what it takes—true or not, right or wrong—in order to get out of a situation or accomplish a task.

Iowans will be forced to sift through dozens of commercials to decide for themselves whether, for example, Harkin is deeply committed to the working people of Iowa or to a personal, liberal agenda that is out of synch with the average voter or whether Tauke is a man of Iowa values and upbringing who took those attributes to Washington or someone who sold out to a national conservative agenda.

There will be no kid-glove treatment in Iowa. You can tell from talking with people on both sides of the fight that they are giving their all to the effort, and that they don't have much use for the people on the other side. This race will be one which attempts to destroy the other guy.

What role abortion will play is unclear. If the debate is framed along the simple pro-choice/pro-life axis, the playing field will be tilted in favor of Harkin. Harkin supporters believe that if Tauke is thought to be fully supportive of the Dornan Amendment, which states that abortion is illegal under any

## Key Dates:

Filing Period ..... March 31  
 Primary ..... June 6  
 Runoff .....

## Committee Assignments:

Agriculture, Appropriations, Labor, and Small Business

First Elected: 1984

and all circumstances, his chances of winning are slim. On the other hand, if the debate goes deeper and becomes more complicated, the outcome is less clear. The Iowa Right-to-Life Committee has announced that they will counter the advertising of pro-choice forces with their own, attempting to shift the battle ground to terrain more favorable to their cause and candidates. The first wave of full-page newspaper ads ran in 55 small towns, was in the form of a quiz that asked people to mark down their own views toward specific situations and compare those positions with those of Harkin, Tauke and "mainstream America," as defined by polls released by CBS News/New York Times and Newsweek magazine. There are four questions on the quiz. First, "Should parents be notified before abortions are performed on teenage girls?" Second, "Once the baby is capable of living outside the womb, should abortion be allowed?" Third, "Do you believe women should by law be guaranteed counseling on alternatives and dangers before abortions are performed?" And finally, "Do you support abortion as a form of birth control?"

Conversely, the debate could shift to cases of rape, incest, mother's life or fetal deformity, which then tilts it back to the pro-choice side. For someone coming from the pro-life side, the options are stand your ground, switch, waffle or attempt to reposition the debate onto your own terms, the latter



of which is the college being taken in Iowa. It is a sophisticated approach and it will be interesting to see if it works.

Another flurry of punches and counter punches that took place in recent weeks has centered on whether a Harkin education plan would involve a tax increase. The Tauke camp charges that Harkin is seeking to raise taxes, but is not being honest about it. Harkin has made a semantical argument that establishing a dedicated funding source for educational improvement through a surcharge of some kind is not a tax increase. Tauke's campaign responded with a tape recording from a radio show of Harkin conceding that it was an "additional tax," but Harkin's campaign countered that the radio interview remarks were prior to the events in Eastern Europe and the advent of the peace dividend.

There is only a small chance that this will not be a 51 percent to 49 percent or a 52 percent to 48 percent race, one way or the other. Figuring out which of the two candidates will have the 50.1 percent of the vote is very difficult, if not impossible. The state is not a terribly expensive one, but not

states to the west. As a result, while both campaigns will have to work hard to raise sufficient money, both, in the end, will have what they need.

There are two big questions for Tauke. First, is he, deep down, mean or tough enough to deliver the biting and very nasty low punches that it takes to win? By most accounts, he is a caring and decent man who has not, in past campaigns, been forced to resort to the brutalization of opponents. As terrible as that sounds, in this particular kind of a Senate race it's true. If Tauke embraces the style, he can go toe to toe with Harkin for the distance, and he will stand a good chance of winning. If he shows reluctance to engage in these sorts of attacks, he could well end up in the loss column. The second question is whether the unusually early start and fast pace of this contest will deplete the arsenal of material to use against Harkin too quickly. In most challenger campaigns, there is a finite stockpile of prime arguments, examples or products of opposition research that correctly and precisely drive home your message. If utilized too early, the campaign's message can

weeks. This is a bigger problem for challengers than for incumbents, so Tauke is at greater risk due to the run and shoot nature of this game.

For Harkin, the question has long been whether he will attempt to run his own campaign or rely on the guidance of advisers. While there is always a danger in candidate-managed campaigns because the candidate may not always view situations as dispassionately or as clearly as a professional, Harkin's style is such that he may be particularly inclined to micro-manage the campaign. Control, focus and discipline are key in a race such as this one in order to clinically determine the right message, as well as the precise manner and timing of communicating that message. In the heat of a campaign, the candidate often either over-reacts to situations or ignores danger signs that others can more calmly diagnose and correct. Early indications are that Harkin recognizes the potential problems that would likely result and has brought on an unusually strong team, both in staff and consultants, that could provide an effective counterweight to such tendencies.

## KANSAS

NANCY KASSEBAUM

REPUBLICAN

RATING: Solid Rep

### Recent Senate Elections:

Percent	Democrats	Years	Republicans	Percent
42	William Rife	1978	Nancy Kassebaum	54
36	John Simpson	1980	Bob Dole	64
21	James Maher	1984	Nancy Kassebaum	78
30	Guy MacDonald	1988	Bob Dole	70

### Potential Democrats:

Dick Williams—Wichita State University professor (1)

### Republicans:

Nancy Kassebaum—Incumbent

## ANALYSIS:

Once Rep. Dan Glickman announced that he would not challenge

### Key Dates

Filing Deadline ..... June 11  
Primary ..... August 7  
Runoff ..... none

### Committee Assignments:

Budget, Commerce, and Foreign Relations

### First Elected:

1978

Kassebaum, any chance of a competitive race disappeared.



The Cook Political Report



MAY 23 '90 10:49 FROM IOWANS FOR TAUKE

PAGE.002

TALKING POINTS REGARDING TOM HARKIN & AGRICULTURE  
SUGGESTED FOR DOLE EVENT - JUNE 1, 1990

- \* QUICK OUTLINE OF FRONT-BURNER CONGRESSIONAL BATTLES CRUCIAL TO IOWA, MIDWEST: AGRICULTURE, RURAL HEALTH CARE, ETC.
- \* IOWA SENATE RACE: IMPORTANCE IN LIGHT OF CRUCIAL BATTLES FOR IOWA, MIDWEST

AGRICULTURE AS A PRISM TO VIEW IOWA RACE:

- o THE HARKIN RECORD - BAD NEWS FOR FARMERS
- o THE TAUKE RECORD - COMMITTED TO IOWA FARMERS...NOT EAST COAST SEAFARERS UNION, NOT NEW YORK & CALIFORNIA FAT CATS (who give Harkin more \$\$ than Iowa Democrats; 90% of Harkin support from out-of-state)

- \* VICTORIES FOR IOWA IN U.S. SENATE REQUIRE A SENATOR TRUSTED, RESPECTED BY COLLEAGUES

- o GRASSLEY: WON THE RESPECT, TRUST, ADMIRATION OF REPUBLICANS DEMOCRATS ALIKE...WINS MANY BATTLES FOR IOWA WITH BIPARTISAN SUPPORT.
- o HARKIN'S COLLEAGUE-BASHING STYLE HAS ALIENATED OTHER SENATORS (Politics in America, 1988) - IOWA'S LOSS
- o TAUKE: BEST KNOWN AS A COALITION BUILDER - UNITING REPUBLICANS AND DEMOCRATS ALIKE FOR VICTORIES CRUCIAL TO IOWA.

\*\* REFERENCES FOR THE DOLE OFFICE:

- \* HARKIN: KEY POINTS ON AG RECORD  
MEDIA STORIES ON: HARKIN'S BOMBASTIC STYLE IN U.S. SENATE, ALIENATION OF COLLEAGUES, LOSS OF INFLUENCE BECAUSE OF ARROGANCE AND ABRASIVENESS. DEMOCRAT QUOTES ON HARKIN.
- \* TAUKE: KEY POINTS ON AG RECORD  
MEDIA STORIES ON: TAUKE AS RISING STAR IN CONGRESS, TAUKE ACHIEVEMENTS, TAUKE'S LEADERSHIP AS A COALITION BUILDER. DEMOCRAT QUOTES ON TOM TAUKE.

MAY 23 '90 10:50 FROM IOWANS <http://dolearchives.ku.edu>

PAGE.003

## AGRICULTURE TALKING POINTS

Tom Harkin likes to talk about fighting for farmers but Harkin too often fights for things that farmers don't want.

MANDATORY PRODUCTION CONTROLS:

Tom Harkin's legislation was denounced by the Iowa Farm Bureau, the Department of Agriculture, the Des Moines Register, and newspapers throughout the country because it would have idled up to 40 percent of our farm land, closed hundreds of Main Street businesses in Iowa, and created a huge agricultural bureaucracy.

Tom Tauke supports the 1985 farm bill that he helped fashion because it has brought hundreds of millions of dollars into the state. Survey after survey shows that Iowa farmers agree with Tom Tauke's position on the 1985 farm bill.

CARGO PREFERENCE:

Tom Harkin has consistently voted to require that commodities sent to other countries be carried by U.S. ships - thus raising the cost of shipping and lowering exports of agricultural products from Iowa.

Tom Tauke opposes cargo preference legislation because it lowers the demand for Iowa products.

CHICAGO BOARD OF TRADE SCANDAL:

Tom Tauke forced the Democratic House to ask the General Accounting Office for an independent probe of the July soybean scandal.

Tom Harkin skipped an April 5, 1989 hearing of the Senate Appropriations Subcommittee concerning the FBI probe of the Chicago Board of Trade.

GRAIN EMBARGO:

Tom Tauke urged President Bush to drop any plans for a grain embargo against China when Secretary of State Baker did not rule out that possibility, and within hours President Bush publicly announced that there would be no grain embargo.



MAY 23 '90 10:51

This document is from the collections at the Dole Archives, University of Kansas  
FROM IOWANS FOR TAUKE  
<http://dolearchives.ku.edu>

PAGE.004

page 2

Tom Harkin's supposed attempt to "repeal" Jimmy Carter's grain embargo was labeled a "fraud" by current House Speaker Tom Foley and failed because Tom Harkin was the only member of the entire House to vote for his proposal. And, during Carter's grain embargo Harkin led the fight to persuade Carter to include phosphate fertilizers in the embargo.

#### FARM TAXES:

Tom Harkin voted against farm state Senators and was the deciding vote in favor of taxing farmers on their fertilizers and feed grains.

Tom Tauke led the charge to repeal the heifer tax and to insure tax-free diesel fuel for farmers.

#### AGRICULTURAL TRADE:

Tom Harkin voted to kill an amendment that would have barred implementation of textile quotas if the President determined that the quotas would lead to reductions in U.S. agricultural exports.

Tom Tauke cosponsored legislation to toughen grain quality standards and thus improve U.S. competitiveness.

#### SOIL & WATER CONSERVATION:

Tom Harkin voted against transferring \$300 million from the Legal Services Corporation to crop insurance and water conservation programs.

Tom Tauke sponsored legislation to create a national conservation reserve before the current CRP was established in 1985 and has since worked to insure flexibility in CRP guidelines.

#### AGRICULTURAL CREDIT:

Tom Harkin missed the vote on a proposal to cut \$1.2 billion from the Agricultural Credit Insurance Fund because he was out collecting a \$1000 honoraria that day.

Tom Tauke worked to develop secondary mortgage markets for farmers (Farmer Mac) and insure the integrity of those markets.



16 OMAHA WORLD-HERALD Tuesday, November 11, 1986

## Harkin Deny Leadership Roles

## Idea Gets Fiery Zorinsky Reply

By David C. Beeder

WORLD-HERALD BUREAU

Washington — Iowa Sen. Tom Harkin's suggestion that Senate Democrats deny leadership positions to Sen. Edward Zorinsky, D-Neb., drew an angry response Monday from Zorinsky.

"I don't give much credence or support to anything Tom Harkin supports or is behind because I think he does it for personal gain," Zorinsky said. "And I think someday the people of Iowa will realize that."

Zorinsky said in August that he might consider rejoining the Republican Party if it would benefit Nebraska. He was rebuked by Harkin in an interview published after the Democrats won 55-45 control of the Senate last week.

Harkin, a Democrat, was quoted in the Lincoln Journal Thursday as saying of Zorinsky:

"Here's a guy who's willing to sell out and go with the Republicans. Why should we reward him?"

**Follow His Desires**

Harkin said Zorinsky should "follow his innermost desires" and rejoin the Republican Party, according to the story. "Life is too short to push and capouse principles you don't believe in," Harkin was quoted as saying.

In an interview Monday night, Harkin confirmed the accuracy of the Journal story.

"If Ed Zorinsky thinks I am the only one who feels this way, he is sadly mistaken," Harkin said. "I may just be the only one with guts enough to say it."

Zorinsky said he had read Harkin's comments.

"The fact that Harkin didn't make these statements before the election indicates he is as much an opportunist as he accuses other people of being," Zorinsky said in a telephone interview from Omaha.

"He waited to make the comment until he found there were 55 Democratic senators. If he felt that way about it, I don't know why he waited until after the election to make the comment."

**Leahy Has Seniority**

In an interview published Aug. 31 in The World-Herald, Zorinsky said he might consider returning to the Republican Party if he could be assured of the chairmanship of the Senate Agriculture Committee, where he has served as ranking minority member.

Zorinsky was a Republican before he ran for the Senate in 1976. He said he considered the party switch after learning that Sen. Patrick Leahy, D-Vt., intended to claim the Agriculture Committee chairmanship to fulfill a campaign pledge made to Vermont dairy farmers.

Leahy, who has seniority over Zorinsky on the committee, had allowed Zorinsky to be ranking minority member, under Republican control, while Leahy chose to be vice chairman of the Senate Select Committee on Intelligence.

Zorinsky had said he would use his party-switching option only if the Democrats won control of the Senate by a margin of 51-49 and the Republicans agreed to name Zorinsky head of the Agriculture Committee when Vice President George Bush broke the tie.

Zorinsky said he stopped commenting on the possibility of switching parties "many weeks ago when I said there are more important issues than my membership in either party."

Zorinsky said he had campaigned for Democratic candidates in Nebraska and nationwide this fall.

"I made a television interview for Leahy, encouraging the people of Vermont to support him," Zorinsky said.

He said Leahy, who won by a 2-1 margin, never was placed in jeopardy by Zorinsky's party-switching comments.

Zorinsky described Harkin as having "a very short memory" regarding help Zorinsky had given Harkin.

"It so happens I even campaigned for Harkin to help him get elected," he said. "People like Harkin will never be



Zorinsky



Harkin

animosity toward people rather than his overall view toward bettering the government.

**Their Prerogative**

"I have managed to survive for 10 years in the Senate with the bottom line being representing the people of my state," Zorinsky said.

"They happen to be of both parties. If Harkin and other people just want to represent one party in their state, that's their prerogative."

Zorinsky said that Harkin, as a member of the House of Representatives, called Zorinsky a number of times to praise Zorinsky's stand against giving aid to rebel forces fighting the Sandinista government in Central America.

Zorinsky said Harkin is the only one he knows who has suggested that Senate Democrats punish Zorinsky.

If there are others, he said, they may be among those Democrats who "weren't happy with me five years ago before party was an issue."

"I am a conservative Democrat, and they don't like conservative Democrats, even though they are Democrats themselves," he said.

**Foreign Relations**

Zorinsky said Harkin has indicated that he would be interested in serving on the Foreign Relations Committee and has asked for Zorinsky's support because Zorinsky is a member of the Democratic steering committee, where committee assignments are made in January.

Zorinsky also serves on the Foreign Relations Committee, where he said he is in line to be chairman of the Western Hemisphere subcommittee.

"Chris Dodd (D-Conn.) called me and said he would be interested in the subcommittee chairmanship if I weren't," Zorinsky said.

"He didn't phrase his question in a way that indicated they are going to take it away from me," he said.

"In fact, the new chairman of the Foreign Relations Committee, Claiborne Pell, (D-R.I.), is a very strong advocate of seniority, and I do have the seniority to assume that chairmanship," Zorinsky said.

Harkin denied that he is seeking a seat on the Foreign Relations Committee. He said he had written to Zorinsky in October to seek his support on the steering committee for an appointment to the Commerce Committee.

**Not Personal**

Harkin now is a member of three committees, agriculture, appropriations and small business.

"It is not a personal animosity," Harkin said in an interview. "It's just that I think Ed has violated those traditional concepts of keeping your word, loyalty to one's friends and some measure of political consistency."

Harkin said anyone who joins a group, "a fraternity, a social organization, whatever it is," has to pledge to be part of the group.

Harkin said he had not intended to attack Zorinsky personally.

"Actually, I find Ed a rather enjoyable individual, as I do his wife," Harkin said.

"I am sorry that Ed has seen fit to make this a personal attack on me. I have tried to make this only a matter of saying, which party does someone want to be in?"



CURRENT STATE OF THE PORK INDUSTRY

\*YOU CANNOT FIND AN UNHAPPY HOG FARMER IN IOWA\*

KEY MARKET INDICATORS:

--	AVERAGE MARKETPRICE (YEAR TO DATE)	<u>1990</u>	<u>1989</u>	
		\$52-\$58	\$44	
--	7-MARKET PRICE	<u>SEPT., 89</u>	<u>APRIL, 90</u>	<u>MAY, 90</u>
	*ON THE RISE*	\$44	\$54	\$62
--	HOG:CORN PRICE RATIO	<u>CURRENT</u>	<u>1989</u>	
		24.6	18	

\*\* THIS RATIO OF HOG PRICES TO CORN PRICES REFLECTS THE TREMENDOUS STRENGTH IN THE HOG MARKET. CORN PRICES HAVE REMAINED STRONG, BUT THE RISING HOG MARKET HAS BEEN GREATER AND ALLOWED THE RATIO TO CLIMB.

\*\* THE HIGHER THE RATIO, THE HIGHER THE RETURNS TO PRODUCERS.

CURRENTLY RIDING HIGH ON A PRICE INCREASE THAT STARTED LAST FALL. HOG PRICES IN DES MOINES REACHED AN ALL-TIME HIGH OF \$68 LAST WEDNESDAY.

<u>TRADE:</u>	<u>JANUARY - MARCH</u>	<u>1990</u>	<u>1989</u>
EXPORTS		69 MILLION LBS.	55 MILLION LBS.
IMPORTS		212 MILLION LBS.	251 MILLION LBS.

\*\* CURRENT TRADE FIGURES REPRESENT AN IMPROVEMENT IN THE BALANCE OF TRADE.

EXPORT NUMBERS HAVE BENEFITTED FROM LARGE FOOD-AID SHIPMENTS TO POLAND.

MARKET ANALYSTS ARE LOOKING AT THE CONSISTENT STRENGTH IN THE MARKET AND ATTEMPTING TO PREDICT WHEN AN EXPANSION IN HERD SIZE WILL BEGIN. SEVERAL SOURCES DO NOT EXPECT TO SEE EXPANSION UNTIL THE END OF THE YEAR, AND THEN THE EFFECT OF PRODUCERS HOLDING BACK BREEDING HERD REPLACEMENTS SHOULD CONTINUE THE STRONG MARKET.

RETAIL SALES WILL PROBABLY NOT SUPPORT PRICES IN THE UPPER \$60'S. AT THESE PRICES, RETAIL PRODUCT HAS BEEN MOVING SLOWLY, AND SLAUGHTER PRICES WILL PROBABLY BACK OFF CURRENT LEVELS TO MAINTAIN MARKET DEMAND STRENGTH.

**NATIONAL PORK PRODUCERS COUNCIL (NPPC)  
POSITION UPDATE**

NPPC SUPPORTS AMENDMENT FOR HIGH AND VALUE-ADDED PRODUCTS

- \*\* CURRENTLY, LESS THAN 2% OF U.S. PORK PRODUCTION IS EXPORTED. NPPC IS SUPPORTIVE OF THE SENATE AG COMMITTEE'S PROVISION OF 10% OF EEP FUNDS EARMARKED FOR VALUE-ADDED PRODUCTS.

INTEGRATED RESOURCE MANAGEMENT (IRM) ASSISTS PORK PRODUCERS

- \*\* "IRM" WOULD BE A PROGRAM OPERATED BY USDA, PROVIDING INFORMATION TO LIVESTOCK PRODUCERS THAT WILL ASSIST THEM IN MAKING BUSINESS DECISIONS BASED ON INFORMATION FROM MANY DIFFERENT DISCIPLINES (NUTRITION, FINANCES, ANIMAL HEALTH, ETC)

NPPC SUPPORTS RETAINING THE INDEPENDENCE OF CFTC

SENATE VERSION OF USDA SEAFOOD INSPECTION ENCOURAGES CONSISTENCY

- \*\* NPPC SUPPORTS USDA OPERATION OF THE SEAFOOD INSPECTION PROGRAM, IN THAT INSPECTION WILL BE CONSISTENT WITH OTHER MEATS AND FEDERAL INSPECTION LAWS WOULD PRECLUDE STATE LAWS.

NPPC SUPPORTS ANIMAL FACILITY PROTECTION ACT

- \*\* THIS BILL (CURRENTLY IN THE HOUSE) WOULD PROVIDE PROTECTION AGAINST VIOLENT ACTS COMMITTED IN THE NAME OF ANIMAL RIGHTS.

NPPC SUPPORTS PSEUDORABIES FUNDING

- \*\* THE PSUEDORABIES ERADICATION AND CONTROL PROGRAM IS A TOP PRIORITY FOR MOST PRODUCERS.



IOWA

POPULATION: 2,834,000  
Voting Age: 2,068,000  
Largest City: Des Moines (192,060)  
Second Largest: Cedar Rapids (108,370)  
Third Largest: Sioux City (98,750)

GOVERNOR: Terry E. Branstad (R)  
Democrat challenger:

SENATORS: Grassley (New Hartford), Harkin (Cumming)

CONGRESSIONAL DELEGATION:

2 Democratic Representatives:  
3rd: Dave Nagle (Cedar Falls)  
4th: Neal Smith (Altoona)

4 Republican Representatives:

1st: Jim Leach (Davenport)  
2nd: Tom Tauke (Dubuque)  
5th: Jim Ross Lightfoot (Shenandoah)  
6th: Fred Grandy (Sioux City)

REDISTRICTING/  
CENSUS IMPACT

A loss of one congressional seat is expected, due to economic decline of Iowa's farm and industrial sectors. Population has dropped in every district except the 4th, so virtually anyone in either party is vulnerable. Iowa Democrats have a majority in the Senate (30-20) and House 61-38), but the district map will be drawn by a non-partisan agency of the state legislature.

DEMOGRAPHICS: 97% White, 59% urban and 41% rural, Iowa's major land use is farm (91%).

MEDIAN FAMILY INCOME: \$20,052 (20th)

VIOLENT CRIME RATE: 231 per 100,000 (41st)

Post

## POLITICS

### Harkin Under Fire In Campaign for Helping Lobbyist

Influence peddling has become the issue of the week in the heated Iowa Senate race between Sen. Tom Harkin (D) and Rep. Thomas J. Tauke (R). Harkin is under fire for doing what his press secretary described as a "personal courtesy for a party official": Harkin told the governor of Puerto Rico that Robert Farmer, a Washington lobbyist and treasurer of the Democratic National Committee, would like to meet with him.

An article in this week's National Journal, which explored Harkin's involvement with Farmer to illustrate Farmer's dual roles as lobbyist and DNC official, reported that Farmer's firm, Cassidy and Associates, subsequently won a contract to represent Puerto Rico on food stamp issues in Congress. Harkin is chairman of a Senate subcommittee that has jurisdiction over food stamp programs.

Denouncing what it called "an obvious and untenable conflict" created by Farmer's two hats, the Des Moines Register editorialized, "Every Democrat with whom Farmer has contact is placed in a potentially compromising position, as was Harkin."

While Tauke has not said anything publicly, his campaign did not waste any time. It sent newspaper articles on the National Journal story to reporters along with a memo titled, "Allegations of influence peddling rock Harkin reelection campaign." The memo also referred to a Florida newspaper report that a Harkin aide "repeatedly suggested" to federal bank regulators that they drop a lawsuit against an Iowa bank.

Harkin is furious at implications of wrongdoing. "There are no law violations, no ethics violations and no one is making any allegations of that," he told Iowa reporters. He added that Farmer "has never donated a cent to my campaign and never raised money for it."

### Youth Vote on the Wane

■ The "glory days" of the youth vote are fading as the huge



SEN. TOM HARKIN

... furious about implications

post-World War II Baby Boom generation ages. People aged 18 to 24 will be only 13.8 percent of those eligible to vote this fall, down from 14.5 percent in 1988 and 18.4 percent in 1980, according to a census report released yesterday.

The bulk of voters are in the 25 to 44 age group. They will make up 43.9 percent of eligible voters in November's election, up from 43.5 percent two years ago and 38.5 percent in 1980.

The middle-aged, those 45 to 64, will comprise 25.2 percent of potential voters, down from 25.3 percent in 1988 and 27.3 percent in 1980.

But the 65-and-over age group will be 17 percent of the total, an increase from 16.7 percent two years ago and 15.7 percent in 1980.

The nation's voting-age population will climb to 186.4 million by November's election, the Census Bureau reported—up more than 3.6 million from two years ago. Women outnumber men in that group, 97.1 million to 89.2 million. Potential voters include 21.1 million blacks and 6.1 million people of other races.

Although there will be more Americans eligible to vote this fall, odds are that a lower percentage than ever will cast ballots. Only half of those eligible voted in the 1988 elections and, without a presidential race this year, the turnout is bound to be lower.

—Maralee Schwartz



5 AP 05-25-90 04:04 EDT

43 LINES

BC-IA--In Brief,350<

DES MOINES, Iowa (AP) Fueled by a ``much touted rebound'' in heavy construction, Iowa's unemployment rate dropped sharply to 4.2 percent in April, officials said.

The April rate is down from the 4.9 percent in March and is slightly above the 4 percent jobless rate for the same month last year, said Cynthia Eisenhauer, Department of Employment Services director.

She said employment in the construction industry reached its highest level since 1981, while initial claims for jobless benefits a leading indicator of economic trends declined by 27 percent over the month.

DES MOINES, Iowa (AP) Following a downtrend during most of 1989, demand for farm loans rebounded in early 1990 in the upper Midwest and is expected to strengthen further this spring, a new report indicates.

The survey of Midwest bankers by the Federal Reserve Bank of Chicago said banks remain flush with funds to meet the rising loan demand.

It also said loan repayment rates continued to strengthen in the first quarter of 1990.

DES MOINES, Iowa (AP) Democratic candidate for governor Don Avenson is back on the campaign trail and insisting ``there's no reason to be limited'' by a brief hospital stay for treatment of a heart condition.

He scheduled a full day of campaigning in eastern Iowa today after returning to the campaign trail Thursday night.

Avenson said he passed the final medical tests ``with flying colors'' and declared himself completely recovered from a balloon procedure used to clear an artery in his heart that was 95 percent blocked.

DES MOINES, Iowa (AP) Democratic Sen. Tom Harkin is holding to a big financial edge over Republican challenger Tom Tauke and has raised \$3.7 million so far, new disclosure records show.

Tauke has raised roughly \$2.6 million, Federal Election Commission disclosure reports showed.

The reports also showed Harkin holds a big lead in cash on hand, with \$1,043,000 in the bank. Tauke has \$325,298 in the bank with \$15,423 in debts.



# Harkin's Trust to Raise Funds to Pay Legal Fees Incurred in Suit Filed Four Years Ago

## \$162,000 Bill From Akin Gump for Libel Defense Sent to Iowa Senator Just Last Year

By Glenn R. Simpson

The names of two of the three Senators who have recently set up legal defense trust funds are unsurprising: Sens. David Durenberger (R-Minn) and Alan Cranston (D-Calif), after all, are under scrutiny by the Senate Ethics Committee.

But what about the third, Sen. Tom Harkin (D-Iowa)?

Harkin established the trust to pay legal bills for the now-complete defense of a libel suit filed against him four years ago.

The suit against Harkin, who is up for re-election this year, arose from his last campaign — the 1984 race in which then-Rep. Harkin unseated Sen. Roger Jepsen (R-Iowa). James Secrist, the former aide to Jepsen who filed, pursued the case all the way to the Supreme Court, to no avail. The Court refused to hear it last October, and Harkin and his staff charge that the suit amounted to politically motivated harassment.

The basis for the suit was a press release issued four weeks before the 1984 election by the Harkin camp alleging that Secrist, who had been assigned to Jepsen's Senate office by the Department of Defense to handle Pentagon procurement from Iowa businesses, was instead acting as a campaign fundraiser.

Jepsen lost the election, 55 to 44 percent, and, in the fall of 1986, Secrist sued Harkin as well as two of his campaign aides and several media organizations for libel, arguing that the press release falsely accused him of violating federal law. The 1939 Hatch Act forbids federal employees from raising funds for a candidate.

In October 1988, an Iowa district court granted summary judgment to Harkin and the other defendants — a blanket rejection of the suit before it even came to trial — saying, among other things, that Secrist was a "public figure" (the standard of proof for public figures is much more vigorous than for private citizens in libel cases) and that the press release was clearly protected political speech under the Constitution.

But Secrist continued his appeals to the US Supreme Court.

"I think there's no question that it was a totally frivolous lawsuit, that Senator Harkin's the victim here," said Kay Casstevens, Harkin's legislative director.

To buttress that contention, Casstevens

***'It's unusual for law firms to carry an amount of that magnitude for so long,' said Professor Gillers.***

notes that better-heeled defendants in the case, including the Des Moines Register, were dropped from the \$4 million suit in subsequent appeals.

"So you have to wonder why he would choose a defendant with much less of a deep pocket," she said.

Harkin was defended in the suit by Akin Gump Strauss Hauer and Feld, a high-powered Washington law firm whose partners include Bob Strauss, former US Trade Representative and chairman of the Democratic National Committee. Over three years, Harkin ran up a \$162,000 bill at the firm, and to date he has paid none of it.



Photo by Laura Patterson

Sen. Tom Harkin and his wife Ruth, a lawyer specializing in agricultural matters with Akin Gump, are shown here at a recent reception. The law firm successfully defended the Senator against a libel suit filed by a GOP campaign worker who said he was defamed during Harkin's 1984 campaign.

Harkin did not report owing Akin Gump any money in his financial disclosure forms for 1987 and 1988. An aide said that the Senator was not required to disclose the debt because Akin Gump had not presented him with a bill.

The obligation is reflected in Harkin's 1989 disclosure form, which was filed with the Secretary of the Senate recently.

Harkin recently told the Des Moines Register that he had not paid any of the bill because Akin Gump lawyer Mike Madigan had only recently totaled up the hours he spent working on the case.

Was it unusual that the firm did not present Harkin with interim bills over the three years? Roll Call contacted law professors and other jurists and received different answers. Law firms are notoriously lax in their billing practices.

One complicating factor for Harkin is that his wife Ruth is a partner in the Akin Gump firm. She practices agricultural law and is a lobbyist.

Sen. Harkin chairs the Senate Agriculture Committee's nutrition and investigations subcommittee and also sits on the agriculture subcommittee of the Senate Appropriations Committee. Ruth Harkin is a former Agriculture Department official and has had agribusiness clients.

Both the Senator's office and Ruth Harkin say that she has never lobbied her husband and that Akin Gump does not currently lobby Sen. Harkin.

Harkin's staff counsel and his press secretary said they were unaware of what payment arrangement might have been reached between the Senator and the law

firm and referred questions to Akin Gump.

Larry Hoffman, a spokesman for Akin Gump, said the firm agreed when it took the case not to bill Harkin until the lawsuit had been fully resolved. "Basically, that was the arrangement that was entered into when we took the case, that we would bill at the end of the case," he said.

"It is definitely unusual," said Stephen Gillers, a professor of law at New York University, of the billing arrangement. "It's unusual for law firms to carry an amount of that magnitude for so long. To my mind, it's a kind of a gift."

But Geoffrey Hazard, a legal ethics specialist at Yale University Law School, said there was nothing unusual or unethical

exactly an unknown commodity," he said, and thus a better-than-usual credit risk.

Now that the case is over, however, Harkin has received his bill. But the firm apparently is still not clamoring for payment: Harkin says he won't raise funds for the trust until after the election because it could create a potential conflict with fundraising for his re-election campaign.

"He was concerned about the appearance of a potential conflict if funds were raised concurrently for both the re-election campaign and for the trust, and he wanted to avoid any sort of circumstance in which the solicitation or the contribution for the funds of the trust might be viewed in the context of a campaign," said Casstevens.

Senate rules require Members to terminate their trusts six months after conclusion of the legal action for which they are created, but the Senate Ethics Committee, in a letter to Harkin on file with the Secretary of the Senate, recently approved an extension of the trust fund sought by Harkin.

The letter does not state why Harkin was allowed the extension, and Casstevens declined to release communications from the committee to Harkin outlining its reasoning.

Technically, it appears that Harkin could accept Akin Gump's services on a pro-bono basis, but he has no intention of doing so, said Casstevens (it's also not clear that Akin Gump would forego the \$162,000).

Because Akin Gump is a law and lobbying firm with a direct interest in legislation, Harkin would probably have to seek permission from the panel before accepting the work as a donation to the trust.

***But Geoffrey Hazard, a legal ethics specialist at Yale, said there was nothing unusual or unethical about the late billing.***

about a law firm withholding its billing until a case is fully litigated.

Gillers, Hazard and others agreed that any number of circumstances could account for the firm's willingness to delay charging Harkin. Told that a lawyer had said the delay was unusual, Hoffman responded that Harkin was, in effect, not the usual client. "A United States Senator is not



# BNR Editorial

## Senator Harkin

In the newspaper business, we sent people out to take photographs. Over the years, we've noticed that there seem to be two kinds of photographers.

One kind takes 45 minutes surveying the scene, checking the lighting, organizing his equipment and perhaps arranging his subjects. Then he takes a picture. Perhaps, to be on the safe side, he'll take two more.

The other kind whips out his camera when he arrives and starts shooting. Thirty-six exposures later, he leaves.

Both photographers take about the same overall time, and both come back with at least one usable photo.

If Sen. Tom Harkin were a photographer, he'd be type 2. We've never seen a legislator who can think up and get behind new legislation faster than Harkin.

Frankly, we're inclined to throw away most of his ideas, but, once in a while, he comes up with a keeper.

Generally, Harkin's enthusiasms call for spending more taxpayers' dollars or more business dollars.

For example, Harkin backs higher subsidies for farmers who grow surplus crops, and he backs extending subsidies to new crops so that we can create new surpluses. Those are plans we'd leave on the darkroom floor.

Now, Harkin has come up with a plan to pay farmers to curtail the use of fertilizers, herbicides and pesticides through the use of sustainable agriculture techniques and practices which curtail erosion and water contamination.

Costs would be recovered by cutting down the number of acres in the Conservation Reserve program. Harkin estimates that, by cutting the size of the reserve from 45 million acres to 43 million acres, enough would be saved to provide incentive payments for environmentally sound practices on 50 million acres of farm land.

Of course, Harkin would do this in addition to boosting and extending subsidies for surplus crop production.

We would do this instead of paying subsidies for surplus crops.

Frankly, runaway use of chemicals is encouraged by high subsidies. The high cost of boosting production with heavy applications of chemicals is only justified by high prices. Lower prices make low-input farming more profitable than high-input farming.

The experience of Richard and Sharon Thompson of near Boone makes it clear, though, that the switch to low-input farming is not an automatic winner. They've spent years experimenting and refining their technique, and, along the way, they've encountered rough spots.

Declining crop subsidies, the advantage of the experience of pioneers such as the Thompsons and federal incentive payments might combine to encourage farming practices which make sense for the farmer and the environment.

If the new farming techniques make economic as well as environmental sense, of course, there should be no necessity for perpetual incentives for their use. Unfortunately, we haven't yet figured out how to keep government spending programs from going on forever—regardless of the fact that some of them are no longer needed.

Still, we like the Harkin plan for encouraging more environmentally sound farming practices. It would be particularly appealing if it were combined with reduced crop subsidies.

~~The Waterloo City Daily Freeman~~  
Journal on the Senate race:

Think anyone still cares who wins by the time the Harkin-Tanke massacre gurgles to its bloody halt in November? ... the rhetoric so far casts aside any chance of this being an "issues" campaign. Both sides have indicated they will leave no slander unspoken, no mud unsung in their efforts to win or retain the Iowa Senate seat....

Some of the most negative releases are those that complain about the supposedly negative campaigning of the opponent. The candidates are each trying to say he is running a cleaner campaign than the other, but they are both wallowing in the gutter. ...

Earlier, the candidates agreed to seven debates to discuss topics of importance to Iowans and promised to show the nation that campaigns can be run on issues instead of images. ... they are diametrically opposed on numerous issues and this election should have offered voters a clear choice in November.

But so far any issue differences ... have been buried in the slime.

We're sick of the election already. ... It looks like by November people will be forced to make a choice that is becoming all too common in recent campaigns: not picking the person you like best, but the one who's campaign conduct has offended you least.



# Harkin alleges McCarthyism on the part of Tauke campaign

By John Kirsch  
Gazette political writer

U.S. Sen. Tom Harkin, D-Iowa, said Saturday that he is the target of a McCarthy-like campaign of "insinuations, innuendos and rumors" engineered by the campaign of his re-election opponent, U.S. Rep. Tom Tauke, R-Iowa.

"We've seen it all before," Harkin told about 230 Democrats at the 2nd District Democratic convention in Monticello. "Those who are at least as old as I am saw it back in the '50s, when Joe McCarthy was riding high."

The "coordinated" Republican campaign is based on "insinuations, innuendos, rumors and trying to destroy my good name and my character," Harkin said.

"Instead of substance, we're getting public relations," he said. "They must have the fastest fax machine in the world."

Tauke's campaign is using character attacks because his record in office is weak, Harkin said.

"We knew they wouldn't be content to fight the battle on the issues because on the issues they lose and they lose badly," Harkin said. "When it comes to records, his and mine, he doesn't have a leg to stand on."

Harkin pledged to run a re-election campaign "...that Iowans can be proud of. Let's hope, for his sake, that my opponent wises up and stops using surrogates to put this Senate race on the low

*"Those who are at least as old as I am saw it back in the '50s, when Joe McCarthy was riding high."*

Sen. Tom Harkin



road...You're still going to lose but not quite so badly and you'll be able to look at yourself in the mirror on the day after the election."

The negative tactics that Harkin accused Tauke of using will not work in Iowa, Harkin said.

"Iowans recognize trash for what it is and they recognize where it comes from," he said. "My opponent doesn't seem to have learned this lesson -- yet."

Harkin and Tauke are competing in Iowa's U.S. Senate race. Harkin issued his blast against Tauke without mentioning Tauke by name. The first-term

Democratic Senate incumbent did not offer specific examples of the rumor campaign he said Republicans have launched against him.

"What can he point to?" asked Tauke spokesman Allen Finch. "He derides a campaign of false accusations and innuendo by false accusation and innuendo."

On a related topic, Harkin cautioned that a Tauke victory would lead presidential candidates to downplay their "progressive" views in the Iowa precinct caucuses.

"If they succeed in defeating me, when Democratic presi-

dential candidates come to Iowa, they're going to be told, 'trim your sails,'" Harkin said.

CEDAR RAPIDS GAZETTE

Sunday, May 20, 1990

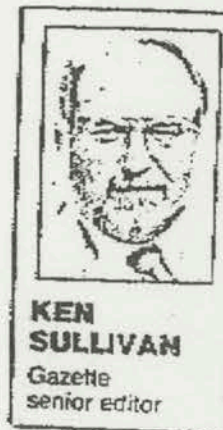

KEN SULLIVAN  
Gazette  
senior editor

## POLITICAL NOTES

### No connection to RNC

Speaking of accepting things at face value, I did in this space. And shouldn't have.

I noted that Harkin dismissed a National Journal article about undesirable relationships between lawmakers and lobbyists. The author, Harkin had told a Gazette colleague the previous week, was written by a former member of the Republican National Committee staff. The inference was what else could be expected from a refugee of GOP headquarters.

A National Journal editor called Monday to set me straight. However embarrassing the article may have been to Harkin and other politicians — Democrat or otherwise — the author owes no allegiance to the RNC and has never been on the RNC staff.



1 '90 12:27

FROM IOWANS FOR TAUKE

PAGE.009



# TOM TAUKE

## U.S. SENATE

### MEMORANDUM

TO: Political Reporters, Writers, Editors  
FR: Allen Finch, Iowans for Tauke  
RE: Statewide poll confirms Harkin reelection woes  
DT: May 31, 1990

A statewide poll of 813 Iowans has concluded that the Iowa Senate race is 'too close to call,' with Republican Congressman Tom Tauke trailing Democratic Senator Tom Harkin by only nine points.

The poll, commissioned by an NBC affiliate in Sioux City (KTIV) and CBS affiliates in Cedar Rapids (KGAN) and Des Moines (KCCI) found that Harkin has fallen below 50 percent to 46 percent of the vote. Tauke, on the other hand, comes in at 37 percent. That leaves Harkin "very vulnerable," according to poll analysis.

The Political/Media Research, Inc., poll released today by the three television news operations reported the following:

"The fall election for the U.S. Senate appears to be shaping up as a close contest. Incumbent Democrat Tom Harkin leads Republican challenger Tom Tauke by only 46 percent to 37 percent statewide. Given that Harkin has a 20 percent advantage in name recognition, the fact that he is under 50 percent, and maintains only a nine-point lead indicates he is very vulnerable."

The poll, conducted from May 25 - 28, also revealed that:

"Harkin's job performance rating is more mixed than that of other statewide officials. While Charles Grassley (69 percent) and Jerry Branstad (61 percent) are rated "excellent" or "good" by over 60 percent of the state's voters, Harkin's "excellent" or "good" rating is only 57 percent."

Despite spending more than \$240,000 on television ads less than two months ago, Tom Harkin continues to slide in the polls.



MEMO  
Page 2

1986 -- When Undersecretary of Education, Gary Bauer, criticized Harkin at a congressional hearing because Harkin compared the Soviet right to vote with the right to vote in the U.S., Harkin responded: "Wait a God Damn minute! That's the worst McCarthyite tactic I've ever seen." Heritage Foundation Education Update, Spring, 1986, Vol. 9, Page 3

1988 -- In a letter to a constituent, Harkin complained about the "McCarthy-like tactics" used to "smear any individual or organization which differs with administration policy on Central America," January 1988

1989 -- In June, Harkin complained that "modern-day McCarthyism" was already being practiced by Tauke in his senate Campaign. "I see it happening already in my campaign." Associated Press, June 9, 1989

"Coordinated Republican campaign:"

When news broke in Iowa that Tom Harkin had done a favor for lobbyist and Democratic National Committee Treasurer, Bob Farmer, Harkin dismissed the story as "biased," claiming the National Journal reporter, Jim Barnes, was a former Republican National Committee employee.

The Cedar Rapids Gazette Senior Editor, Ken Sullivan, in this Sunday's column, No Connection to RNC, noted that while he had accepted what Harkin said "at face value," he "shouldn't have." He said he found out that "the author (Jim Barnes) owes no allegiance to the RNC and has never been on the RNC staff."

Meanwhile, the Harkin campaign continues to face mounting allegations of influence peddling. It has recently been reported that: 1) Harkin did a favor for Bob Farmer, a lobbyist whose firm does work on an issue under the jurisdiction of a committee chaired by Harkin; 2) Harkin unsuccessfully intervened with federal regulators on behalf of a Council Bluffs Bank; 3) Owes more than \$160,000 to the lobbying firm, Akin, Gump, Strauss, Hauer, and Feld, which also employs his wife; 4) Has collected 90 percent of his individual itemized campaign contributions from out-of-state; and 4) Has admitted to several irregularities, what he called "typos," in his Personal Financial Disclosure Reports.

\*\* While you should have received all aforementioned news articles, if not, contact Joe Bormann at 1-800-373-1990 for copies.



## MEMORANDUM

TO: Political Reporters, Writers, Editors  
FR: Allen Finch, Iowans for Tauke  
RE: Harkin employs oft-used "McCarthyism" defense against repeated allegations of influence peddling.  
DT: May 21, 1990

In response to a series of national and state news stories detailing allegations of influence peddling against Sen. Tom Harkin, Iowa's junior Senator yesterday dusted off one of his favorite defenses: McCarthyism.

In a Sunday Cedar Rapids Gazette article entitled, "Harkin alleges McCarthyism on the part of Tauke campaign," Harkin claimed to be the target of a "McCarthy-like campaign" run by Tauke "surrogates." Though Harkin "did not offer specific examples," The Gazette wrote, he claimed to be the victim of a "coordinated Republican campaign."

There are two points as regards this latest development about which you should be aware: 1) Tom Harkin has accused his foreign policy and campaign opponents of using "McCarthyite" tactics at least seven times in his political career; 2) The "coordinated Republican campaign" about which Tom Harkin speaks in fact consists of recent negative news reports and editorials by the The National Journal, The Washington Post, The New York Times, The Wall Street Journal, Roll Call, the Des Moines Register, The Waterloo Courier and the Cedar Rapids Gazette.

### "McCarthy-like tactics:"

1972 -- When Congressman Bill Scherle released congressional material concerning Tom Harkin's involvement in the Vietnam tiger cages controversy, Harkin accused Scherle of "using McCarthy tactics to smear me." Des Moines Register, November 3, 1972

1985 -- "Such simplistic and misguided reasoning plagues the administration's Nicaragua policy. In fact, I believe this display of international McCarthyism is a smokescreen to hide the fact that the President's policy is not succeeding and is doomed." Des Moines Register, March 18, 1985

1985 -- "(Jean) Kirkpatrick accused Harkin and other opponents of the Contra aid of appeasement. Harkin accused Kirkpatrick and the Reagan Administration of international McCarthyism." Cedar Rapids Gazette, April 18, 1985

1985 -- When Sec. of State George Schultz criticized Harkin and others for acting as "self-appointed emissaries to the communist regime" in Nicaragua, Harkin accused Schultz of "international McCartyism." Associated Press, May 24, 1985



# Road turns rocky on the Harkin campaign trail

Things sure can fall apart in a big hurry.

Just ask Sen. Tom Harkin's campaign staff.

OK, that was sort of rhetorical, something columnists just do for effect.

The truth is Harkin's people wouldn't admit something was wrong if you held their bare, little piggies over hot coals.

But, that doesn't change the facts.

Something is wrong.

And Harkin's heretofore smooth ride to a second term is getting very bumpy.

You can't chalk it up to challenger Tom Tauke. The trouble is the doings of Harkin & Co.

There's the legal defense fund.

And his favor for a top party fund-raiser/lobbyist.

We've got his aide's intervention on behalf of a Council Bluffs bank.

And some double talk solely intended to keep the cash flowing into the campaign coffers.

It's just plain weird.

The senator established the defense fund to pay costs of a libel suit filed against him by military officer who was an aide to the man Harkin beat in 1984. The suit was tossed out of court after court, but it cost Harkin a lot of money.

Still, you've got to question his judgment when he runs up a



**Eric Woolson**

Courier  
political writer

\$160,000 bill at one of the most expensive law and lobbying firms in Washington, which just happens to employ his wife.

Why not go someplace else?

Harkin also helped Democratic National Committee treasurer Bob Farmer make contact with Puerto Rico's governor. Turns out the political pal was trying to win a lobbying contract on an issue that would have been before Harkin's subcommittee.

The senator said he assumed Farmer had party business — not money making — in mind.

Harkin has complained loudly about resulting stories, but he should have been more careful. And he should get fellow Democrats, already steeped in conflicts of interest because of their reliance on special interest money, to find someone other than a lobbyist to fill the party's bank account.

The story of intervention on

behalf of a Council Bluffs bank is noteworthy because it occurred after five senators were under investigation for taking contributions to help the president of an S&L that seems to have misplaced \$2 billion.

While most everybody in Washington became much more cautious about twisting regulators' arms, a Harkin aide was persistent in suggesting the case should be dropped.

It's ironic, too, because the bank is very healthy and its violation was merely technical, a failure to disclose its average interest rate.

Sure, there are probably logical explanations for all of that stuff.

But what can't be explained away is a kind of money-grubbing pitch that would make Jim and Tammy Bakker blush.

It all started early this year when Tauke launched an advertising campaign to boost his name ID. Harkin campaign manager Tim Rafis said it was a "desperate gamble."

"Historically, candidates who have spent money on early advertising did not gain any solid support for the general election," he wrote to PAC directors.

A month later, Harkin's campaign started its own early advertising campaign. Tauke's people said the Harkin blitz cost \$250,000, which the Democrats denied.

Now, Harkin sends out a fund-raising letter saying the campaign needs money because it spent more than \$240,000 on advertising in just three weeks.

"We did what we had to do — spent the money we had available to make sure Tauke didn't get a jump start on us," he wrote.

He noted that Tauke's plan is to "hit early and hard."

"This means that for the next eight months we cannot let false accusations and innuendos go unanswered. We must be prepared to go on the air at any time — to fight back at a moment's notice," Harkin wrote.

Talk about false accusations and innuendos!

Tauke's ads were anything but hard hitting. They were upbeat, sappy biographical sketches that didn't even mention Harkin.

Nonetheless, Harkin said he needs \$240,000 in the next three weeks to replenish his emergency media fund to "keep up with Tauke's fund-raising and media barrage."

"Unlike my opponent, who receives his campaign money from GOP fat cats, I rely on concerned individuals like yourself for financial support," he wrote.

He adds with a tone of urgency,

"My margin over Tauke is only 11 points!"

I don't know who received that letter, but it must have been Democratic fat cats in New York, Florida and California because he receives more money from them than his so-called Iowa skinny cats.

Maybe political action committees got the letter, too, because he gets most of his money from them.

While he makes himself sound like a poor, battered underdog, Harkin has actually raised a lot more money than Tauke. His staff has been bragging about it for weeks.

They've also crowed about the 11-point lead.

It's time for a little truth in advertising before it becomes impossible to keep track of what's going on in the Harkin campaign.

I had a little conversation with Tauke spokesman Allen Finch a few days ago about these developments.

"Lincoln said if you tell the truth you don't have to remember what you said. These guys probably ought to start keeping files so they can remember what they said," he laughed.

At this rate, it won't be the last laugh Finch enjoys.



53 LINES

AM-IA--TV Poll, Bjt,450<

Harkin Holds Nine-Point Edge in New Poll; Gov Race Close<

By MIKE GLOVER=

Associated Press Writer=

DES MOINES, Iowa (AP) Incumbent Democrat Tom Harkin holds a nine-point edge in Iowa's heated U.S. Senate race and the battle for the Democratic gubernatorial nomination remains a close one, a new poll says.

The poll, commissioned by three television stations and conducted by Political-Media Research Inc., shows Harkin leading GOP challenger Tom Tauke by a 46-37 margin, with 17 percent of those surveyed uncommitted.

In the Democratic primary for governor, Attorney General Tom Miller got 32 percent to 27 percent for House Speaker Don Avenson. With a 6 percent margin of error in that sample, Miller's lead is statistically insignificant.

Former banker John Chrystal got 20 percent, and the sample matched campaign polls in reporting that 21 percent of those surveyed said they had yet to make up their minds about which candidate they would back.

Almost all the candidates found something they liked in the new numbers, which come only five days before Tuesday's primary election.

The poll was commissioned by Des Moines television station KCCI, Cedar Rapids station KGAN and Sioux City station KTIV.

In the Senate race, 813 registered voters who said they were likely to vote in November were questioned by telephone May 25-28 and the poll has a 3.5 percent margin of error.

During that sampling, the firm polled 262 likely Democratic voters and the smaller sample resulted in a 6 percent margin of error for the governor's race.

Iowa's U.S. Senate race is one of the most heated in the nation. The new poll showed Harkin maintaining an edge over Tauke.

"What this poll does show is that the group of voters who hold this election in the palm of their hands are independents," said Harkin spokesman Phil Roeder. "We've got a 17 point lead among independents and we feel very comfortable."

Tauke aides said the polls shows Harkin dropping beneath 50 percent and that means he is "very vulnerable."

"Despite spending \$240,000 on television ads less than two months ago, Tom Harkin continues to slide in the polls," said Tom Synhorst, Tauke's campaign manager.

In the Democratic gubernatorial primary, the race remains closely contested with the outcome still in the hands of those who have not made up their minds, though Miller aides were claiming victory.

"I feel really good," said spokesman John Cacciatore. "Tom Miller has led this race from wire to wire."

Avenson aides pointed to the closeness of the two candidates and the relatively large margin of error and said it shows the race essentially a dead heat. They claimed momentum heading into the campaign's final weekend.

<



# Harkin aide embroiled in bank dispute with regulators

By JANE NORMAN

Of The Register's Washington Bureau

WASHINGTON, D.C. — In 1984, officials with the First National Bank of Council Bluffs, Ia., decided to offer consumer loans with a discounted first-year interest rate as a way to attract new customers.

Four years later, the way in which the bank disclosed the interest rates on these loans has become a key issue in a dispute between the bank and federal regulators. First National may have to pay refunds of about \$32 each to several hundred customers.

But the dispute also has gained attention because of allegations that a longtime aide to Sen. Tom Harkin, D-Ia., tried to exert pressure on federal regulators on behalf of the Council Bluffs bank. The aide, Richard Bender, has denied the allegations, saying he was just seeking information from the regulators.

"I also happen to think there is a

certain ombudsman function it is appropriate for a congressional office to do," Bender said.

Anthony Payne, president and chief executive officer of First National, said federal regulators were the ones who first suggested that Council Bluffs bank officials approach legislators for help.

## "An Un-American Thing"

"When we did, we got caught up in this turmoil, and it's almost like it's an un-American thing," Payne said.

The dispute first was disclosed as part of a lengthy article in the St. Petersburg, Fla., Times headlined "Lawmakers still pressure bank regulators."

The article said there is a "new sensitivity" in Washington to intervention by lawmakers on behalf of financial institutions in the wake of

ethics investigations of five senators who used their influence to help out a failing, poorly managed savings and loan directed by Charles Keating.

Despite that sensitivity, records obtained by the newspaper showed that since August, at least 25 members of Congress or their aides "have called S&L and bank regulators to pressure them or to inquire about enforcement actions." The Times said a log of the contacts showed they ranged from "innocuous queries to persistent pressure."

Quoting a memo written by federal regulators, the article said that last December, Bender "repeatedly suggested" that regulators use a 1935 Florida case as a precedent for the dispute involving First National Bank of Council Bluffs. The regulators "told him the ruling was irrelevant," the article said.

## "Persisted"

Bender "persisted" and said the other case "might provide a basis" for regulators to drop their case against First National, the article said. Regulators objected that the Council Bluffs case involved "non-technical and substantive violations," the Times said.

Unlike the Keating case, the Council Bluffs bank is not in trouble, it is not accused of unwise business practices, and its top executive is not a major campaign contributor to Harkin.

Payne said he has made one \$50 donation to Harkin, and that was before this dispute began. "We don't live lavishly," Payne said. "Our bank car is an '84 Buick with 62,000 miles on it."

The controversy also has its political element.

Harkin is in a tough re-election race against Rep. Tom Tauke, R-Ia., and aides to Tauke have been circulating copies of the Times article to Iowa and national reporters in a bid to gain wider attention for it.

Allen Finch, press secretary to

**"Why can't I go see my legislator and ask them for help on something? ... They're the ones legislating the laws."**

—Anthony Payne

president and chief executive officer of Council Bluffs bank

Payne said that four years ago, the bank offered installment loans to consumers with interest rates that were discounted in the first year of the loan. During the rest of the life of the loan, the interest rate would be the bank's usual consumer loan rate.

Payne said the loans probably were about \$7,000 each on average and were used for items such as cars or home improvements.

First National is regulated by the federal Office of the Comptroller of the Currency, or OCC. In August 1984, OCC examiners from Kansas City, in their usual examination of the bank's books, decided the bank had not properly disclosed the annual percentage rate being charged for the loans.

The bank should have predicted its interest rates during the entire length of the loan and come up with a composite, or blended, rate that was disclosed to customers, the OCC said.

Payne said that decision was made not on the basis of lengthy federal bank regulations on such loans, which First National had followed, but of a sentence in a "staff commentary" accompanying the rules. Payne said there was no indication in the regulations that the bank also was required to consult the commentary.

## Challenged Decision

First National challenged the OCC decision, and Payne said the examiners told him to approach his congressional representatives if he was unhappy with the way the regulation was written.

On a visit to Washington, D.C., in November 1989 on other business,

spelling out ethics laws and saying Lightfoot could inquire about the case in writing with regulators.

Bender began looking into the case. He said Harkin "did not give me any direction" and, as of Friday, had not discussed it with Bender since.

## Florida Oversight

Bender spoke with First National officials. They told him they had learned "in a casual fashion" that an error similar to theirs had been committed by a Florida institution, and the regulator of that bank decided the error was an oversight rather than a purposeful violation. No money had to be reimbursed.

The OCC had told First National the cases were not similar and would not disclose the name of the Florida bank, Bender said.

Bender said he first called a lawyer in the Kansas City office of the OCC and talked about the dispute in general. In the second call, he said, he zeroed in on the Florida case.

"What I asked the attorney at the OCC was that I thought it was appropriate that the Iowa bank be given the facts of the case of the Florida decision," Bender said. "I happen to think it is appropriate for (First National) to be able to make their own judgment what the facts of that case are and what the precedent is."

Bender said it would have been "absurd on its face" for him to argue to the OCC that they should have accepted the Florida case as a precedent. "If I know no information about a case other than it's about a general





# TOM TAUKE

## U.S. SENATE

### MEMORANDUM

TO: Political Reporters, Writers, Editors  
FR: Allen Finch, Iowans for Tauke  
RE: Allegations of influence peddling continue to command 'center stage' in Harkin campaign. Harkin's problems likened to Jepsen's in 1984.  
DT: May 14, 1990

Iowa political writers continue to explore Sen. Tom Harkin's increasing problems with allegations of influence peddling. On Sunday, May 13, 1990;

The Cedar Rapids Gazette wrote, "Harkin can't afford to ignore a magazine article that claimed he introduced the Governor of Puerto Rico and a Washington lobbyist. This situation has a life of its own, as did Jepsen's encounter with the massage parlor." ('90 Senate race begins to mirror '84)

The Waterloo Courier, reported that "things sure can fall apart in a big hurry. Something is wrong (with the Harkin campaign.) There's the legal defense fund. And his favor for a top party fundraiser/lobbyist. His aide's intervention on behalf of a Council Bluffs bank. And some double talk intended to keep the cash flowing into the campaign coffers. It's just plain weird." (Road turns rocky on the Harkin campaign trail)

The Des Moines Register explored "allegations that a longtime aid to Sen. Tom Harkin tried to exert pressure on federal regulators on behalf of (a) Council Bluffs bank." (Harkin aide embroiled in bank dispute with regulators)



## POLITICAL NOTES

# '90 Senate race begins to mirror '84

One of the names on the ballot will be different, but aside from that, Iowans should be prepared for a U.S. Senate campaign this year that is becoming increasingly similar to the 1984 Senate race.

I was reminded of that last weekend when Sen. Tom Harkin found it necessary to take the defensive because of something that had been written about him in Washington. There was a lot of that going around in 1984.

Then, the choice facing Iowa voters was between 5th District Rep. Harkin, the Democratic challenger, and Republican Sen. Roger Jepsen.

Once again, an incumbent U.S. senator (Harkin) is being challenged in his bid for reelection by a member of the U.S. House of Representatives. Tom Tauke has represented the 2nd District since 1979.

Already having the office firmly in hand, Harkin probably has to be regarded as the favorite. On the other hand, perhaps Tauke is finding some encouragement in the fact that both Iowa senators — Harkin and Republican Charles Grassley — were serving in the House of Representatives when they successfully challenged senators of the opposite party.

Harkin and Tauke are at opposite ends of the philosophical spectrum, but not to the extreme that was the case in 1980 when Grassley, a staunch conservative, defeated Democratic Sen. John Culver, frequently described as "the most liberal member of the U.S. Senate."

The pattern in Iowa over most of the last two decades has been to trade a senator near one end of the ideological range for a challenger near the other end. Jepsen, another devout conservative, won his term in the Senate in 1978 in an upset over another acknowledged liberal Democrat, Richard Clark. The 1984 contest in which Jepsen was unseated was also a case of swapping widely divergent political philosophies.

There's another historical voting pattern in Iowa that Tauke clearly wants continued, while Harkin is striving to bring it down: No Democrat has ever been re-elected to the U.S. Senate from Iowa.

None of these factors can be ignored — nor will they be — in a contest as intense and expensive as this one promises to be. Both men are well-financed, both are experienced lawmakers, both have demonstrated the organizational skills it takes to win consistently, and both are "known quantities" on those issues that likely are to have a bearing on the campaign.

Then there's the question of a "hot button." In nearly every campaign, we won't know until it happens what is going to get the voters talking about the candidates. I'm confident there will be

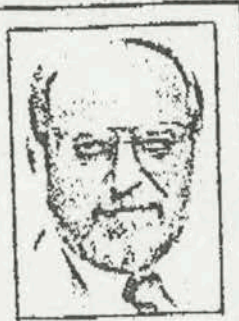

**KEN SULLIVAN**  
Gazette  
senior editor

years ago with a series of developments: one that he'd set himself apart from the rest of the crowd in using the traffic lane in Washington, D.C., that is reserved for multipassenger vehicles; another when it was revealed he had frequented a massage parlor.

Not exactly earth-shattering situations, but juicy ammunition to fire across the bow of a one-term Republican lawmaker who had done little to establish himself as a political powerhouse in Washington.

Now it's apparently Harkin's turn to maneuver through suggestive pitfalls, spending time in rear-guard actions that would better be invested in campaign strategy of his choosing.

It has to be done. With all the notoriety extended to Congress in the last year or so over ethics violations, Harkin can't afford to ignore a magazine article that claimed he introduced the governor of Puerto Rico and a Washington lobbyist, who also happens to be top official in the Democratic National Committee. The lobbyist landed a contract to represent Puerto Rico's interests on issues before Congress.



**Sen. Tom Harkin**

No wrongdoing intended or involved, Harkin insisted, further claiming the article in the National Journal was biased. It was written by a former employee of the Republican National Committee who was a speechwriter for Secretary of State James Baker when Baker was treasury secretary.

The beauty of this situation from a challenger's perspective is that he doesn't need to lift a finger. The situation has a life of its own, as did Jepsen's encounter with the massage parlor. It might keep popping up throughout a campaign, or it might disappear overnight.



## IOWA STOPS

### Des Moines

As you know, more than 60% of the voters in Iowa's Fourth District are in Polk County, mostly in the City of Des Moines. Smaller industrial towns and farm communities surround Des Moines, the commercial, financial, and government center.

White, protestant, middle class individuals live in Des Moines, a city with little ethnic flavor. It is the second largest insurance city, with more than 50 insurance companies.

The United Auto Workers has a significant presence, with about 4,000 members and a regional office. Some UAW members in the farm equipment industry have been hard hit by the farm depression. Naturally, the UAW's very presence provides the Democrats with the successes they've had in Iowa 4. (Rep. Dave Nagle currently represents the Fourth District).

The Fourth District was Dukakis' best in Iowa in 1988 (60% of the vote), although Reagan carried Polk County in 1980, and Mondale narrowly defeated him there in 1984.

### Ames

North of Des Moines in Story County is Ames, a city of 44,000. Ames is the home of Iowa State University. Story County gave independent John Anderson more than 19% of the vote, his fifth best county showing in the nation. Four years later, Reagan won Story County by a narrow percentage, and in 1988, it was Dukakis who was the victor.

Of course, Ames sticks in your memory due to the Mayor's "flip-flop" endorsement from you to Bush during the INF Treaty discussions, when you decided to hold off before committing immediately to the Treaty.



### Marshalltown

Iowa 3 remains Democrat territory with liberal Johnson County where the University of Iowa is located.

Black Hawk County, Iowa's fourth largest metropolitan area, casts the district's largest single block of votes (30%). Waterloo and Cedar Falls are two major towns located in Black Hawk and concentrated with workers in the farm-implement industry. Labor unions are strong, although Republicans have won this area in the past.

The Northern part of Iowa 3 stretches to the Minnesota border, and is filled with Republican voters in rural counties.

### Mason City

Located in Cerro Gordo County, in Northern Iowa 6, is the county seat, Mason City. Producer of ice machines and building materials, Mason City also processes meat and dairy products. Mason City was the inspiration of the musical, "The Music Man", by native son Meredith Wilson.

The Sixth, represented by Republican Congressman Fred Grandy, is one of the most agriculturally-productive areas in the State with flat, rich soil and consistently impressive yields of corn and soybeans. But with today's high costs of farming, many small scale farmers have sold their land to agri-businesses, eliminating jobs and causing migration from the district.

The Sixth also is home to Sioux City, an old meat-packing town that is the largest city in Western Iowa.



# Iowa



**Terry E. Branstad (R)**  
Des Moines — Elected 1982

Age: 47, 17, 1946, Leland, Iowa.  
 Education: U. of Iowa, B.A. 1969; Drake U., 1974.  
 Career: Army, 1969-71.  
 Religion: Roman Catholic.  
 Career: Iowa House, 1973-79; Iowa governor, 1979-83.  
 Election: 1990.

47%  
 30%  
 14%

## Workers

18,248  
 58,665  
 129,747

\$20,052 (20th)

\$800 (31st)

## IN

per pupil \$3,619 (23rd)

ees 14% (37th)

rate 231 per 100,000 (41st)

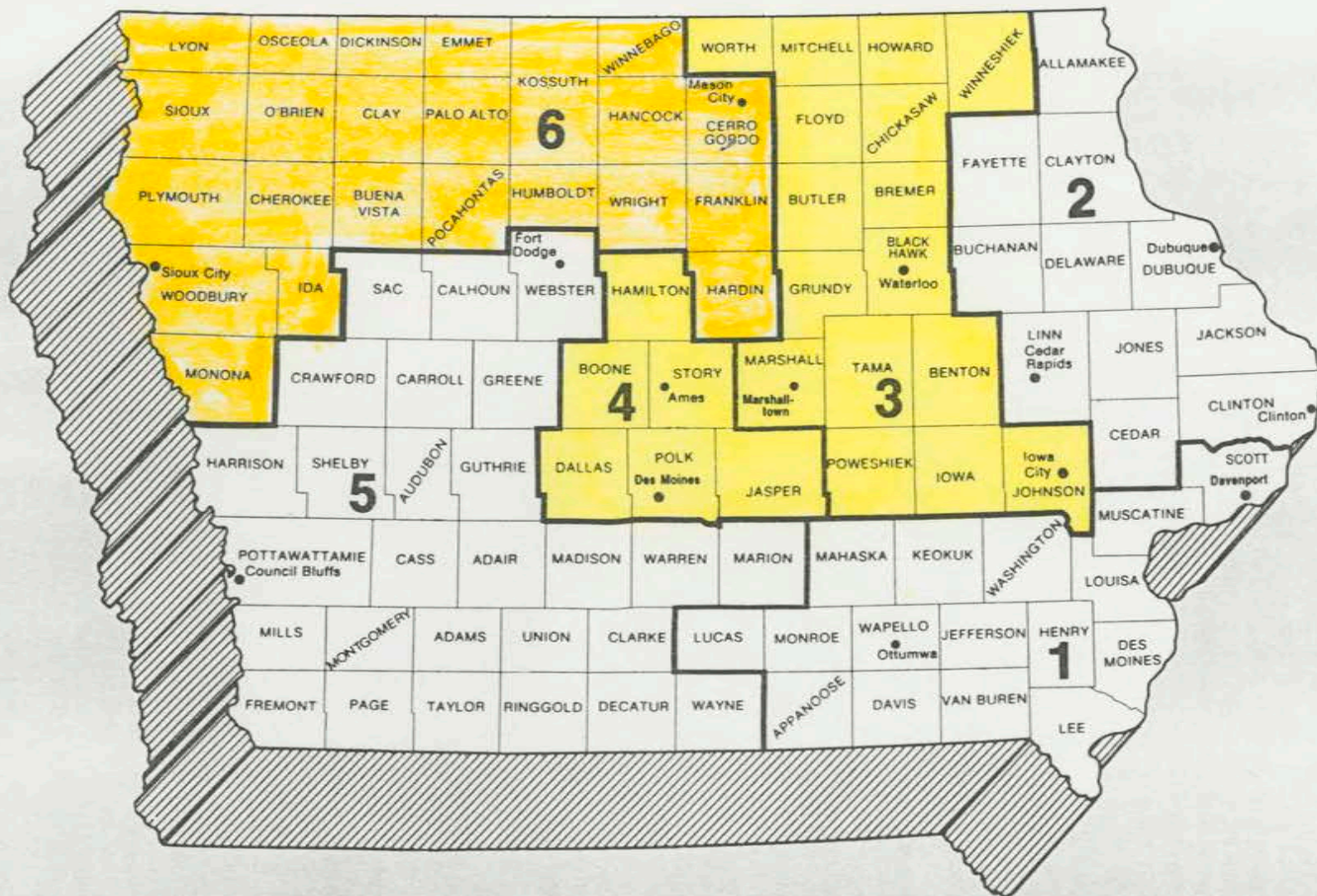



## IOWA -- POLITICAL BRIEFING

### STATE POLITICAL BACKGROUND

- o Republican candidates have won eight of the 10 presidential elections since 1952 (the exceptions were in 1964 and 1988).
- o Since 1962, Republicans have won five of the nine U.S. Senate elections.
- o Republicans have won every gubernatorial contest since 1968.
- o Democratic registration outnumbers Republican registration statewide. According to the Iowa Secretary of State's office (3/1/90):

Republicans	476,246	(32%)
Democrats	548,320	(36%)
Other	474,028	(32%)

---

Total	1,498,594
-------	-----------

### 1988 ELECTION RESULTS

PRESIDENTIAL:	Bush	45%	541,540
	Dukakis	55%	667,085

Reagan won 51% of the vote in 1980 and 53% in 1984.

U.S. HOUSE: All incumbents were re-elected.

STATE LEGISLATURE: Republicans lost one state Senate seat and lost three state House seats.

### STATE UNEMPLOYMENT RATE

- o The February 1990 not-seasonally adjusted unemployment rate in Iowa was 5.0%, above the February 1990 rate of 4.7%. The national seasonally adjusted rate for February 1990 was 5.2%.

### STATE ISSUES

- o The 1990 session of the Legislature convened on Jan. 8, 1990 and adjourned on April 7, 1990.

#### 1991 STATE BUDGET:

- o Protecting Iowans from a future tax increase, Republican Gov. Terry Branstad exercised his item-veto right and cut \$34 million in spending proposals from the state budget passed by the Democratic-controlled Legislature. The Legislature had exceeded Branstad's spending limit by more than \$45 million. Prior to his cuts, the total state budget exceeded \$3 billion for fiscal 1991, which begins on July 1, 1990.



- o One of the largest cuts made by the governor was almost \$13 million from a bill that would have redirected state lottery profits from economic programs to the environment. Other line-item vetos included a pilot project for cocaine babies and the creation of a child day-care program for public employees in Des Moines.
- o Branstad has been criticized by state Democrats because of his vetos which they say are aimed at the family and the environment.

#### PROPERTY TAX RELIEF:

- o A measure passed by the Legislature and signed into law by Gov. Branstad will provide property tax relief to needy Iowans. The Legislator cut the state's property taxes by a total of \$35.5 million, \$5.5 million more than Branstad asked for in January.
- o The measure will provide \$12.5 million in property tax relief for low-income homeowners and renters and \$3 million for increased tax credits for the elderly and handicapped. Another \$10 million is earmarked for relief for family farmers.

#### CRIME AND THE WAR ON DRUGS:

- o A major crime package was approved by the state Legislature. It is aimed at drug enforcement, tougher laws, drug treatment and drug education.
- o Though some of Branstad's points were included, his major proposals, a lower blood-alcohol level for drunk drivers and a zero tolerance for minors who use drugs or alcohol, were left out of the final bill.

#### ABORTION:

- o State Democratic Party Chairwoman Bonnie Campbell predicted prior to July's Supreme Court decision that it could lead to "all-out" political warfare in Iowa, affecting every political race from governor on down. Currently, the abortion issue is prominent in every statewide race in Iowa.
- o Under current law, the university is only allowed to perform abortions on indigent patients if the mother's life is endangered, if the fetus is deformed or mentally deficient and in cases of rape or incest.
- o Two amendments failed during the 1990 legislative session which would have restricted abortion at University of Iowa hospitals in Iowa city.

#### VOTER REGISTRATION:

- o Gov. Branstad vetoed a bill passed by the Iowa Legislature that would have allowed voters to register at the polls on election days. Republican lawmakers opposed the bill because of the possibility of voter fraud and long lines at polling places.



- o The Iowa State Association of County Auditors urged Gov. Branstad to veto the bill because it did not set any safeguards, such as requiring proof of residency.

1991 REDISTRICTING:

- o Iowa is expected to lose one of its six congressional seats. A recent Census Bureau projection reports that if current population trends continue, Iowa will lose more than 300,000 residents (10.6% of the state's population) by the year 2000.  
(Des Moines Register, 4/10/88)
- o The governor has veto power over the Legislature's redistricting plan.

1988 PRESIDENTIAL ELECTION

- o Iowa's presidential caucuses were held on Feb. 8, 1988 -- the earliest bipartisan caucuses in the country.
- o George Wittgraf was the chairman of the Bush-Quayle campaign in Iowa.
- o Michael Dukakis defeated George Bush in Iowa, 55%-45%.
- o Iowa was not considered crucial by the Bush-Quayle campaign and Vice President Bush did not return to the state after the Iowa caucuses. Gov. Dukakis made two trips to the state during the general campaign, including an early-morning Election Day stop.
- o Iowa Democrats conducted an aggressive voter registration effort in the fall of 1988, registering nearly twice as many voters as Republicans, and widening their registration advantage to more than 86,000 voters on Election Day 1988.

STATE POLITICAL SUMMARY

- o The filing deadline for the June 5 primary was March 16. A single candidate must receive 35 percent of the vote in the primary to accept the party's nomination. If no one receives 35 percent, a candidate will be nominated at the state convention.
- o The Republican state convention will be held on June 23 and the Democratic state convention will be held on June 16.

U.S. SENATE:

- o Republican Sen. Charles E. Grassley (1989 ratings: ADA-25; ACU-86) was first elected in 1980 with 53% of the vote.
- o Grassley defeated Democratic challenger John Roehrick in 1986, 66%-34%. Grassley is the first Iowan to win a second term in the U.S. Senate since 1966.



- o In 1984, Democratic Rep. Tom Harkin (1989 ratings: ADA-95; ACU-14) won 55.5% of the vote, to unseat incumbent Republican Sen. Roger Jepsen.

1990 U.S. Senate Race:

- o Sen. Tom Harkin is seeking re-election. No Democratic senator has ever been elected to two consecutive terms in Iowa. Republican U.S. Rep. Tom Tauke announced his candidacy on Feb. 4, 1990.
- o Harkin has been endorsed by the Iowa Chapter of the Sierra Club because he "has been a strong environmental advocate" who has backed numerous legislative initiatives. The group termed Tauke's environmental record as "disappointing" and "troubling".
- o Between January and March 1990 the Tauke campaign raised a total of \$586,321, spent \$595,552, had \$293,733 cash-on-hand, with a total debt of \$42,146. The Harkin campaign ended the first quarter with over \$1.1 million cash-on-hand after raising a total of \$689,649.
- o According to The Cook Political Report (3/20/90), Harkin and Tauke "are facing off in a race that seems destined to go to the wire." Cook rates this race a "toss-up." Roll Call (4/30/90) and Congressional Quarterly (2/17/90) have also rated this race as a "toss up."

Abortion:

- o The abortion issue is expected to play a significant role in Tauke's bid to unseat Harkin. Harkin is pro-choice and Tauke is pro-life.
- o In 1984, Harkin returned a \$10,000 campaign contribution from the National Abortion Rights Action League (NARAL). NARAL is now "spending thousands of dollars (\$250,000) on an independent campaign against Tauke, with no discouragement from Harkin." However, many Iowa radio and television stations have refused to air NARAL's ads because of their political content.  
(AP, 4/21/90)

Polling:

- o A March 1990 Iowa Poll conducted by the Des Moines Register (n=550 adults, +4.2%) showed that 51 percent favor Harkin while 40 percent favor Tauke, with 9 percent undecided. A similar poll in December 1989 showed 50 percent favored Harkin while only 36 percent favored Tauke.

GOVERNOR:

- o Republican Terry Branstad was re-elected in 1986, defeating former Senate Democratic Majority Leader Lowell Jenkins, 52%-48%.
- o Gov. Branstad is vice chairman of the National Governors Association.



- o There is no limit to the number of terms an Iowa governor can serve. Gov. Branstad announced he will seek re-election to a third term in 1990, promising to lead the fight against drugs, promote economic development, education and the environment, without raising taxes.
- o Records filed in January with the State Campaign Finance Disclosure Commission show Branstad has raised a total of \$817,881 with \$701,022 cash-on-hand, with outstanding bills of more than \$14,000.
- o The Cook Political Report (3/20/90) rates this race as "leaning Republican."

Democrats:

- o Democrats seeking the nomination include Iowa Attorney General Thomas J. Miller, Des Moines businessman John Chrystal, Lt. Gov. Jo Ann Zimmerman and State House Speaker Donald Avenson.
- o On March 28, Avenson and Zimmerman announced they would seek their party's gubernatorial nomination as a team. Avenson will run for the Democratic nomination for governor and Zimmerman will run for lieutenant governor. Zimmerman will still be on the primary ballot because her withdrawal came too late for her name to be removed from the ballot. She has encouraged all her supporters to vote for Avenson.
- o Records filed in January with the State Campaign Finance Disclosure Commission show Zimmerman had raised a total of \$26,000. Chrystal raised a total of \$150,000 with \$23,256 cash-on-hand. Avenson raised \$112,000 with \$19,048 cash-on-hand. Miller raised \$92,146 with \$18,898 cash-on-hand.

Endorsements:

- o Chrystal has received endorsements from several well known female state Democratic leaders including state Sens. Elaine Szymoniak and Jean Lloyd, and author and member of the Iowa Women's Hall of Fame Louis Noun.
- o The Avenson-Zimmerman team has been endorsed by the Iowa Auto Workers, Iowa Federation of Labor, American Federation of State, County and Municipal Employees, Iowa State Education Association, Iowa Citizen Action Network and the Iowa chapter of the National Organization for Women (NOW).
- o NOW has pledged to help raise money for Avenson, start a voters' registration drive and is urging its members to support him in the primary and the general. NOW has pledged a \$1,000 campaign contribution.
- o Miller and Chrystal claim Avenson is receiving endorsements only because he has a voting record and don't expect the endorsements to translate into votes.

Abortion:

- o Gov. Branstad is staunchly anti-abortion. Democrats Chrystal, Zimmerman and Avenson are pro-choice, while Miller is pro-life.



- o NARAL has also launched an advertising campaign against Miller in the Democratic primary. Miller has repeatedly said the only change in the current law he would propose as governor would be to require parental notification. Miller also opposes public financing for abortions.
- o According to The Washington Post (5/10/90) NARAL may endorse Avenson or Chrystal before the primary. Chrystal has been critical of NARAL and would not accept their endorsement unless they agreed to stop its campaign.
- o Avenson has actively petitioned NARAL for its endorsement. He believes that the abortion issue will be the "definitive issue [that] will determine the winner and, I believe, ultimately defeat Terry Branstad."

Polling:

- o A poll taken by The Des Moines Register (d=4/16-18/90, n=431 likely Democratic primary voters statewide) showed the following results:

	<u>April 1990 %</u>	<u>March 1990 %</u>	<u>Dec. 1989 %</u>
Tom Miller	21	26	29
Donald Avenson	18	17	10
John Chrystal	14	12	11
Jo Ann Zimmerman	6	11	16
Undecided	41	34	34

LIEUTENANT GOVERNOR:

- o In 1986, Democratic Lt. Gov. Robert Anderson vacated his seat to unsuccessfully run in the Democratic primary for governor. The Democrats nominated state Rep. Jo Ann Zimmerman, who defeated former state legislator Joan Lipsky, 53%-47%.
- o The governor and lieutenant governor previously ran separately. Then the lieutenant governor served as president of the Senate in what was primarily a ceremonial role.
- o In November 1988, voters approved a proposal to have the governor and lieutenant governor run on the same ticket beginning in 1990. Gov. Branstad supported the proposal to unite the two candidates. Under this change, the lieutenant governor will have new duties determined by the governor.
- o The Senate will elect its own president beginning with the 1991 session. The Senate is led by the Democratic Senate majority leader, Bill Hutchins, who currently holds the title and is expected to retain it next year.

U.S. HOUSE OF REPRESENTATIVES:

- o All six of Iowa's incumbent House members were re-elected in 1988.



o 1988 election results:

<u>District</u>	<u>Winner</u>		<u>Percentage</u>
1	Jim Leach	(R)	61
2	Tom Tauke	(R)	57
3	Dave Nagle	(D)	63
4	Neal Smith	(D)	72
5	Jim Ross Lightfoot	(R)	64
6	Fred Grandy	(R)	64

1990 KEY CONGRESSIONAL RACE:

**2nd C.D. -- Northeast, Cedar Rapids**

- o The 2nd C.D. will be an open seat in 1990 with Republican U.S. Rep. Tom Tauke's U.S. Senate campaign.

Republicans:

- o Republican candidates include lawyer Jim Nussle, Dentist and former Dubuque County Commissioner Wayne Moldenhauer, and businessmen Joe Ertl, who recently switched to the Republican Party. All three Republican candidates oppose abortion.
- o According to Congressional Quarterly (4/7/90), "no clear front-runner has emerged in the GOP field."

Democrats:

- o Democratic candidates include former state Sen. Steve Sovern and lawyer Eric Tabor. Sovern, a pro-life supporter, ran against Tauke in 1980. Tabor, a pro-choice supporter, challenged Tauke in 1986 and 1988 and has been endorsed by Sen. Harkin.
- o According to Congressional Quarterly (4/7/90), "Tabor is the candidate to beat" in the Democratic primary.
- o The Cook Political Report (3/20/90), Roll Call (2/19/90) and Congressional Quarterly (2/17/90) rate this race a "toss up" in 1990.
- o In 1988, Bush-Quayle received 43% of the vote in the 2nd C.D.

STATE LEGISLATURE:	State Senate:	20 Republicans	30 Democrats
	State House:	39 Republicans	61 Democrats

- o In 1988, Republicans lost one state Senate seat and lost three state House seats. Republicans have been outnumbered in both chambers since 1983.



- o In 1990, 25 Senate seats and all 100 House seats will be up for re-election.
- o The Associated Press reported that Iowa has been targeted as a key state in the national Democratic Party's drive to gain control of as many state Legislatures as possible before reapportionment.

#### STATE PARTY UPDATE

- o On Jan. 28, 1989, Richard Schwarm was unanimously elected state chairman to replace retiring Chairman Michael Mahaffey. David Oman was re-elected as state co-chairman.
- o At the June 1988 GOP state convention, party activists re-elected National Committeewoman Gwen Boeke and unanimously elected Steve Roberts as the new national committeeman.

#### REPUBLICAN STATE PARTY OFFICIALS

STATE CHAIRMAN:	Richard Schwarm
STATE CO-CHAIRMAN:	David Oman
NATIONAL COMMITTEEMAN:	Steve Roberts
NATIONAL COMMITTEEWOMAN:	Gwen Boeke

#### ELECTED OFFICIALS

GOVERNOR: Terry Branstad (R) - re-elected in 1986

U.S. SENATORS: Tom Harkin (D) - elected in 1984  
Charles Grassley (R) - re-elected in 1986

U.S. HOUSE: 4 Republicans 2 Democrats

Republican Members:

James Leach	1st District
Thomas J. Tauke	2nd District
Jim Ross Lightfoot	5th District
Fred Grandy	6th District

#### STATE BACKGROUND

- o Iowa's population in 1988 was 2,834,000.
- o Small towns and rural areas tend to vote Republican, while the larger cities tend to vote Democratic.
- o Iowa's crop production in dollar terms is second only to California.



- o Three-quarters of the jobs in the state are related to agriculture -- either farming, food processing, or manufacturing of tractors and other agricultural machinery.
- o 1980 Census rankings for Iowa are as follows:
  - 27th in population (2,913,808);
  - 36th in Black population (41,700), but 39th in Black percentage (1.4%) of the state's total population;
  - 37th in Hispanic population (25,536) and 39th in Hispanic percentage (0.9%) of the state's total population;
  - 28th in percentage (50%) of women in the labor force;
  - 37th in percentage (13.9%) of college graduates;
  - 23rd in median household income (\$16,799);
  - 24th in per capita income (\$7,212); and
  - 33rd in housing value (\$44,000).

10-May-1990 Thu 15:46sp